

DUAL LINE 02

DUAL LINE

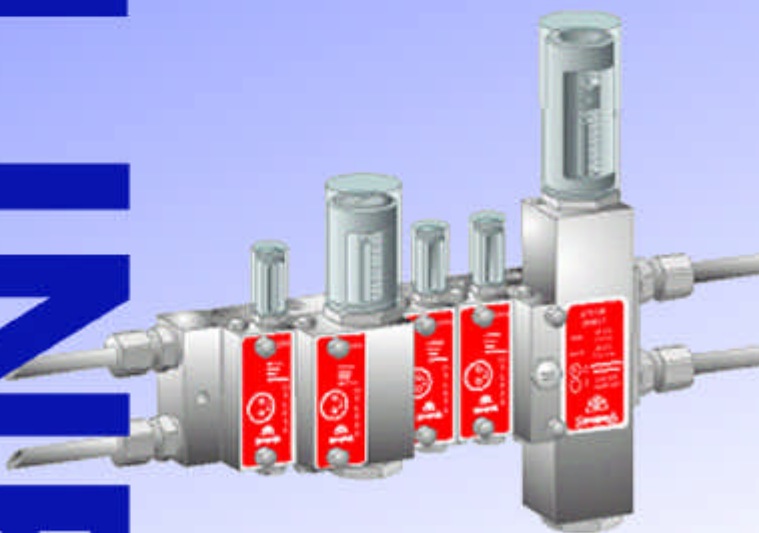

*Centralised lubrication systems*

[www.dropsa.com](http://www.dropsa.com)

WK 39/00

C1021CE

# CONTENTS

<b>Sheet No.</b>	<b>Description</b>	<b>Revision</b>
A1	Feeder block series AP1	C1044IE
A5	Feeder block series APF05 – APF1	C1045IE
A10	Feeder block series AP6	C1062IE
A15	Feeder block series AP6F	C1061IE
A20	Feeder block series AG6	C1060IE
A25	Feeder block series AG6F	C1063IE
A30	Feeder block series AGG6	C1064IE
A35	Feeder block series AGG6F	C1065IE
A40	Feeder block series AGG2	C1066IE
A45	Double control matering valves	C1067IE
M1	Modular dual line	C1081IE

## Pumps and accessories for use with dropsa dual line system 02

B1	777000 series motorised pumps	C1073IE
B5	Trolley mounted motor driven pump 777000	C1074IE
B10	Modular motor driven pumps 999000	C1075IE
B30	Manual pumps series 156000	C1076IE
B40	Motorised gear pumps series 1222000	C1077IE
C1	Transfer and filling pumps series 132000	C1078IE
C20	Heavy duty pneumatic pumps series 400200	C1079IE
C25	Pneumatic transfer and filling pumps 72160	C1080IE
D1	Micro-switch for low control	C1082IE
D2	End of line pressure switch	C1083IE



# FEEDER BLOCK SERIES AP1.

Adjustable Discharge 0,1 - 1 cc. per stroke  
 (.006 - .061 cu.in./stroke) Dual Line System

622200 623200  
 624200 625200  
 622260 623260  
 624260 625260

## PRODUCT DATA SHEET

ENGLISH

### DESCRIPTION:

The feeder body is made of special anti-friction steel. Pistons are made of hardened steel. Bores and pistons are lapped to provide superior sealing. The indicator turrets are provided with integral adjusting screws together with a metacrylate cover and seal.

On request an aluminium cover can be supplied. The feeder body has a galvanized finish and features an adaptor (see Fig. F.) for single or double outlet conversion.

### SPECIFICATION:

Temperature range: -30 to +80°C.  
 Max. pressure (inlet): 400 bar (5800 psi.)  
 Cycles: 100/min.  
 Min. Viscosity: 15 cSt (77 SSU)  
 Grease Max.: 220 ASTM (NLGI 3)  
 Connections:  
 Inlet: 1/4"  
 Outlet: 5/16" - 24NF

### ORDERING INFORMATION:

Ordering is by Part No., refer to the following table:

Thread	Part No.	Weight		No. Outlets
		Kg.	Lbs.	
Dropsa Standard BSP	622200	0,450	.99	1 - 2
	623200	0,660	1.45	2 - 4
	624200	0,900	1.98	3 - 6
	625200	1,10	2.42	4 - 8
NPTF	622260	0,450	.99	1 - 2
	623260	0,660	1.45	2 - 4
	624260	0,900	1.98	3 - 6
	625260	1,10	2.42	4 - 8

### INSTALLATION/OPERATION:

Function:(Refer to Figs. 1 and 3.)The feeder discharge is controlled by a servo-piston (A) and metering piston (B) and can be arranged to provide a single or double outlet. Fig. D-E = 2 separate outlets. Fig. F. = connecting bridge for single outlet. Feeders are normally supplied with double outlets unless otherwise specified.



For single outlets use Connecting Bridge **Part No. 622030** (refer to Fig. 3.).

The two outlets of each feeder block must always be used. If you need only one outlet you must use Connecting Bridge **Part No. 622030**. The other outlet cannot be plugged. The volume can be adjusted by turning the screw of the turret. When single outlet feeders are used, the discharge per complete cycle = 0,2 to 2 cc/stroke (.012 to .122 cu.in./stroke.).

**Dimensions: (Refer to Fig. 2.).**

Mounting: (Refer to Fig. 2.). Aluminium Bushings **Part No. 622017** are supplied for mounting on uneven

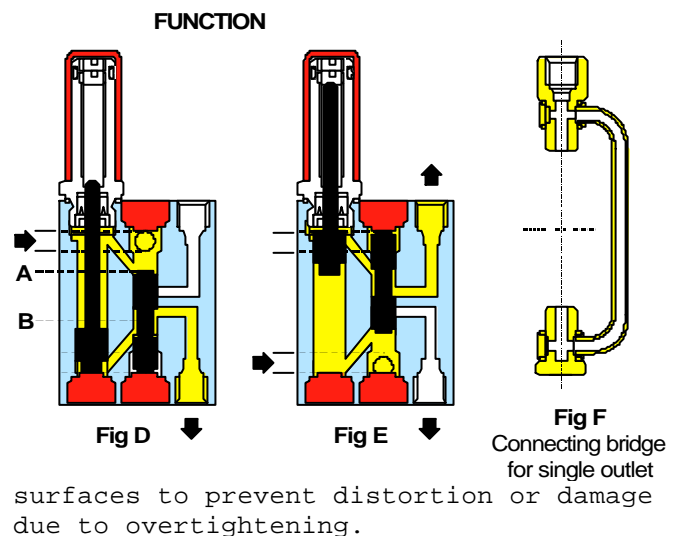

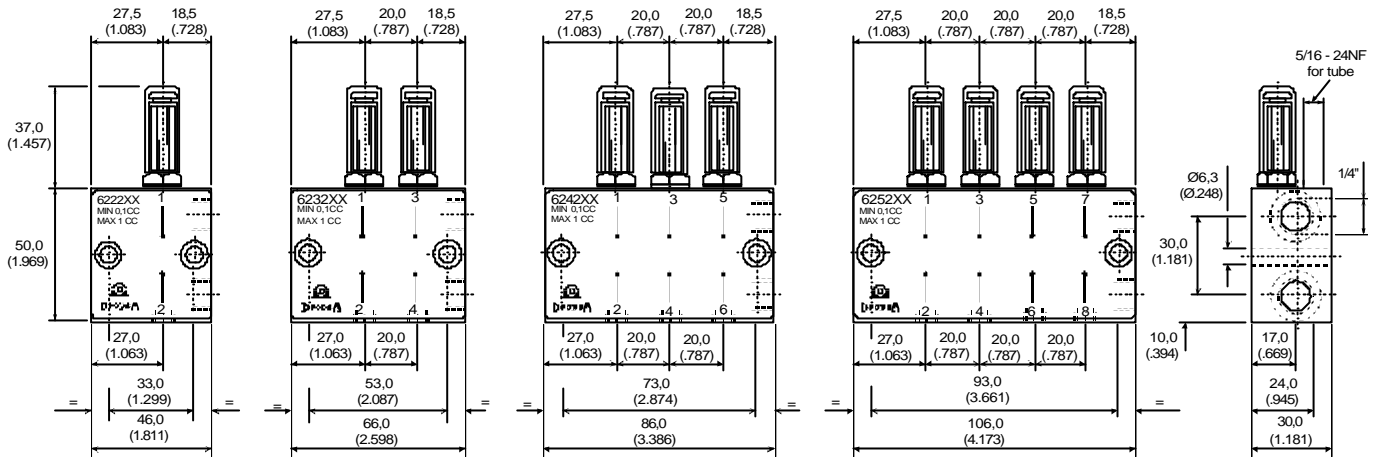

DROPSA STANDARD - DIN 3852 Ø				
Plug	Ø Tube	Nut	Ring	Fitting
926001	6	91396	91590	92337
	8	91402	91596	92266
	10	91406	91601	92242
NPTF DRY SEAL Ø INCHES				
850281	1/4	850200	850220	850250
	5/16	850201	850221	850252
	3/8	850202	850222	850254

DROPSA STANDARD - Ø mm			
Cone	Bush	Ø Tube	Plug
93004	92004	Ø4	91005
NPTF DRY SEAL Ø INCHES			
93004	92026	Ø 5/32	91005

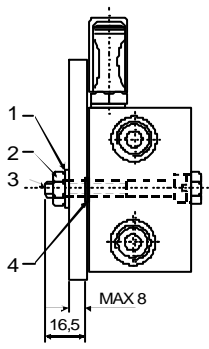
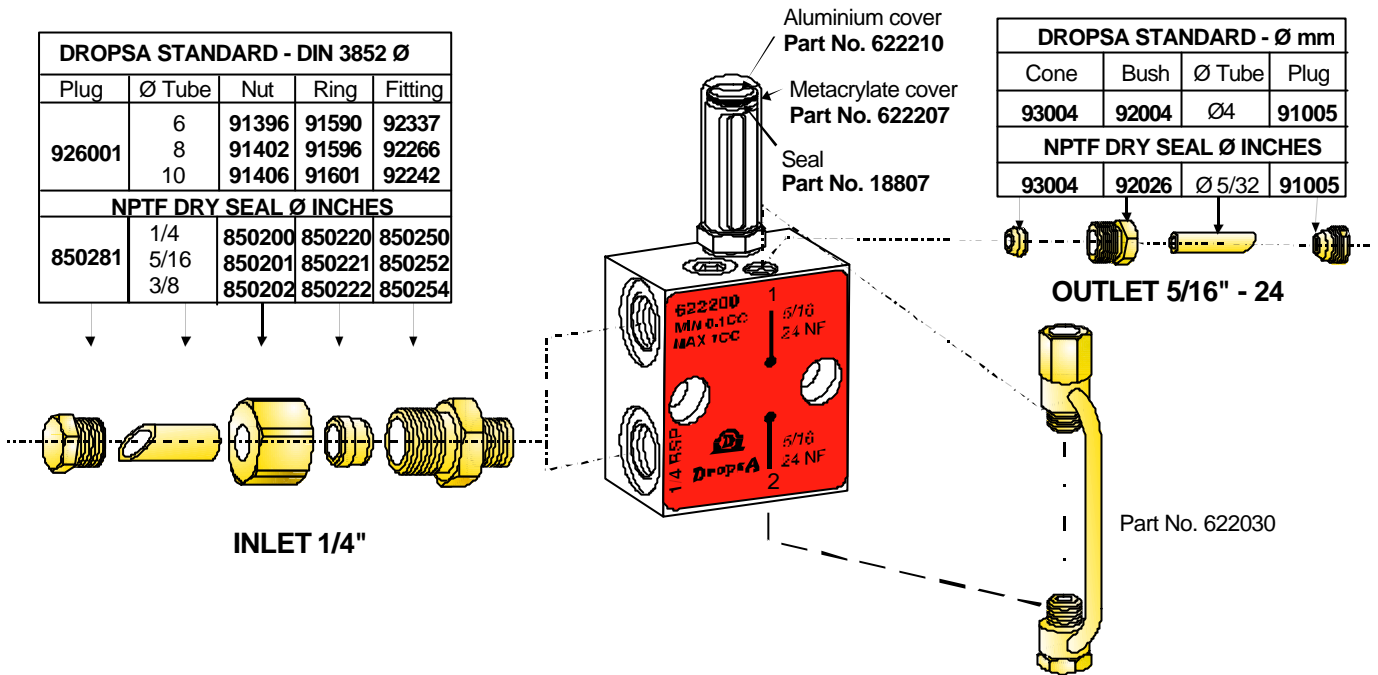

The fixing parts which are indicated thus \* are to be ordered separately.

Pos	Part No.	Qty.	Description	
*1	16009	2	Spring washer	Metric
*2	16335	2	Nut M6	
*3	12534	2	Screw M6 x 45	
4	622017	2	Bushing	Inches
*1	16012	2	Spring washer	
*2	16499	2	Nut 1/4-28 UNF Hex. 7/16	
*3	12562	2	Screw 1/4-28 UNF x 1 3/4	
4	622017	2	Bushing	

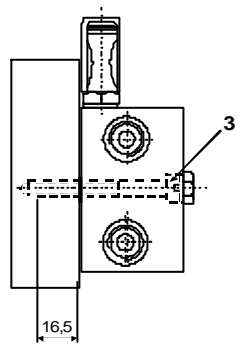

WELD PLATES FOR FEEDERS

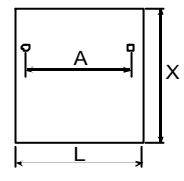

N.	Part No.	DIMENSIONS (INCHES)		
		A	L	X
1	111585	33 (1.29)	45 (1.77)	120 (4.72)
2	111586	53 (2.08)	65 (2.55)	120 (4.72)
3	111587	73 (2.87)	85 (3.34)	120 (4.72)
4	111588	93 (3.66)	105 (4.13)	120 (4.72)

**U.K.**  
 Dropsa (UK) Ltd.  
 Unit 6, Egham Business Village,  
 Egham,  
 Surrey, TW20 8RB  
 Tel: (+44) 01784 - 431177  
 Fax: (+44) 01784 - 438598  
 E-mail: salesuk@dropsa.com

**U.S.A.**  
 Dropsa USA Inc.  
 50679 Wing Drive  
 Utica,  
 Michigan 48315.  
 Tel: (+1) 810-566-1540  
 Fax: (+1) 810-566-1541  
 E-mail: salesusa@dropsa.com

**AUSTRALIA**  
 Dropsa Australia Pty.  
 No. 7 Warringah Road  
 Dee Why  
 NSW 2099  
 Tel: (+61) 2 9905 0410  
 Fax: (+61) 2 99394142  
 E-mail: sales@dropsa.com

**GERMANY**  
 Dropsa GmbH.  
 Volmerswerther Strasse 80  
 40221 Dusseldorf 1,  
 Deutschland  
 Tel: (+49) 0211-394-011  
 Fax: (+49) 0211-394-013  
 E-mail: sales@dropsa.de

**ITALY**  
 Dropsa Spa  
 Via B. Croce, 1 - 20090  
 Vimodrone (MI)  
 Tel: (+39) 02 - 250.79.767  
 Fax: (+39) 02 - 250.79.767  
 E-mail: sales@dropsa.it (Export)  
 E-mail: vendite@dropsa.it (National)

© Copyright Dropsa - all rights reserved. Reproduction of any part of this document is strictly forbidden without prior consent from Dropsa. Dropsa reserves the right to modify specifications without prior notice.



# FEEDER BLOCK SERIES APF05-APF1

Fixed Discharge APF05 0,5 cc. APF1 1 cc. per/stroke  
(APF05 .030 cu.in./stroke APF1 .061 cu.in./stroke)  
Dual Line System.

622060 622070  
623060 623070  
624060 624070  
625060 625070  
622080 622090  
623080 623090  
624080 624090  
625080 625090

ENGLISH

## PRODUCT DATA SHEET

### DESCRIPTION:

The feeder body is made of special anti-friction steel. Pistons are made of tempered steel. Bores and pistons are lapped to provide superior sealing. These feeders do not employ indicator turrets (see AP1 series) and are used for special applications. The body has a galvanized finish and features an adaptor (see Fig. F.) for single or double outlet conversion. They are set by the factory 0,5 cc. per/stroke (.030 cu.in./stroke) for APF05 and at 1 cc. per/stroke (.061 cu.in./stroke) for APF1 unless otherwise requested.



### SPECIFICATION:

**Temperature range:** -30 to +80°C.  
**Max. pressure (inlet):** 400 bar (5800 psi.)  
**Cycles:** 100/min.  
**Min. viscosity:** 15cSt (77 SSU)  
**Grease Max.** 220 ASTM (NLGI 3)  
**Connections:**  
**Inlet:** 1/4"  
**Outlet:** 5/16"-24NF

Fig D-E = 2 separate outlets. Fig F = connecting bridge for single outlet.

Feeders are normally supplied with double outlets unless otherwise specified. For single outlets use Connecting Bridge **Part No. 622030 (refer to Fig. 3.)** When single outlet feeders are used, the discharge per complete cycle = for APF05 0,5 - 1 cc./stroke (.030 - .061 cu.in./stroke) and for APF1 1 - 2 cc./stroke (.061 - .122 cu.in./stroke).

### ORDERING INFORMATION:

Ordering is by Part No. refer to the following table:

Thread	Part No.		Weight.		No. Outlets.
	APF05	APF1	Kg.	Lbs.	
Dropsa Standard BSP.	622060	622070	0,430	.94	1-2
	623060	623070	0,620	1.36	2-4
	624060	624070	0,840	1.85	3-6
	625060	625070	1,00	2.20	4-8
NPTF	622080	622090	0,430	.94	1-2
	623080	623090	0,620	1.36	2-4
	624080	624090	0,840	1.85	3-6
	625080	625090	1,00	2.20	4-8

### INSTALLATION/OPERATION:

**Function:(Refer to Figs. 1 and 3.)**The feeder discharge is controlled by a servo piston (A) and metering piston (B) and can be arranged to provide a single or double outlet.

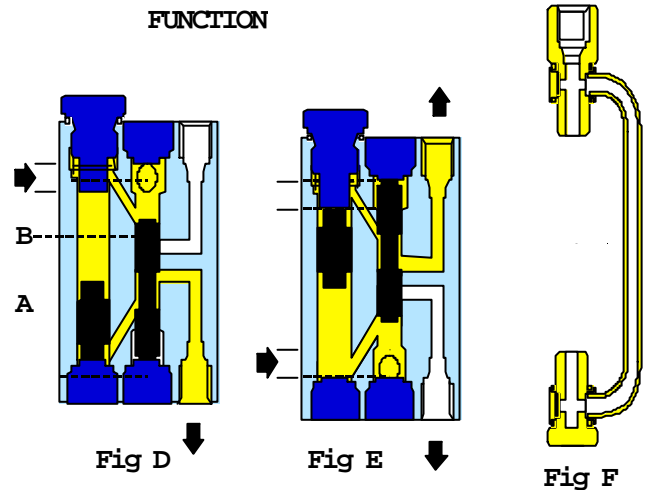

Connecting bridge for single outlet

**Dimensions: (Refer to Fig. 2.)**

**Mounting: (Refer to Fig. 4.)** Aluminium Bushings **Part No. 622017** are supplied for mounting on uneven surfaces to prevent distortion or damage due to overtightening.

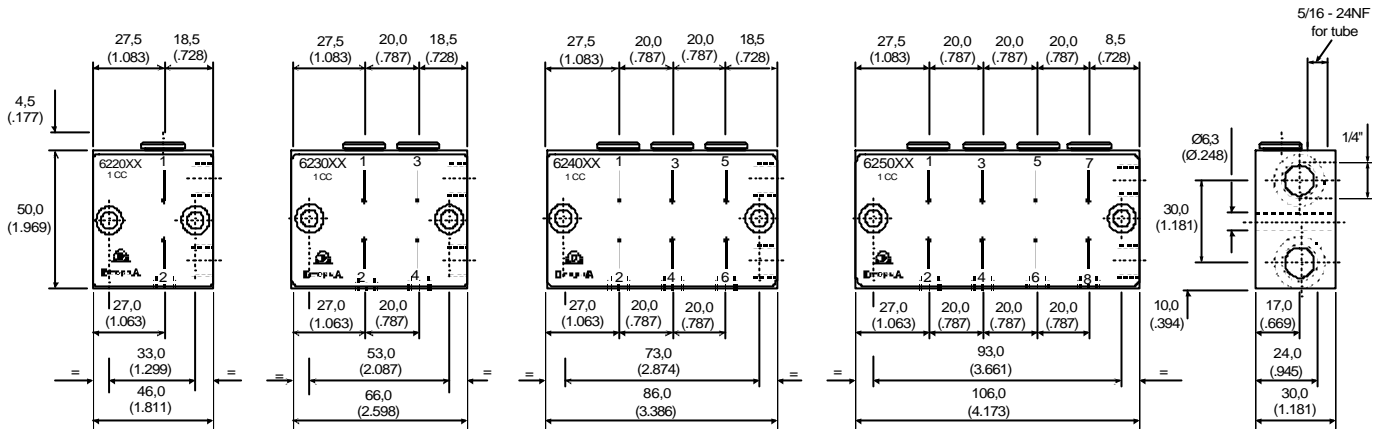

DROPSA STANDARD - DIN 3852 Ø mm				
Plug	Ø Tube	Nut	Ring	Fitting
926001	6	91396	91590	92337
	8	91402	91596	92266
	10	91406	91601	92242
NPTF DRY SEAL Ø INCHES				
850281	1/4	850200	850220	850250
	5/16	850201	850221	850252
	3/8	850202	850222	850254

DROPSA STANDARD - Ø mm			
Cone	Bush	Ø Tube	Plug
93004	92004	4	91005
NPTF DRY SEAL Ø INCHES			
93004	92026	Ø 5/32	91005

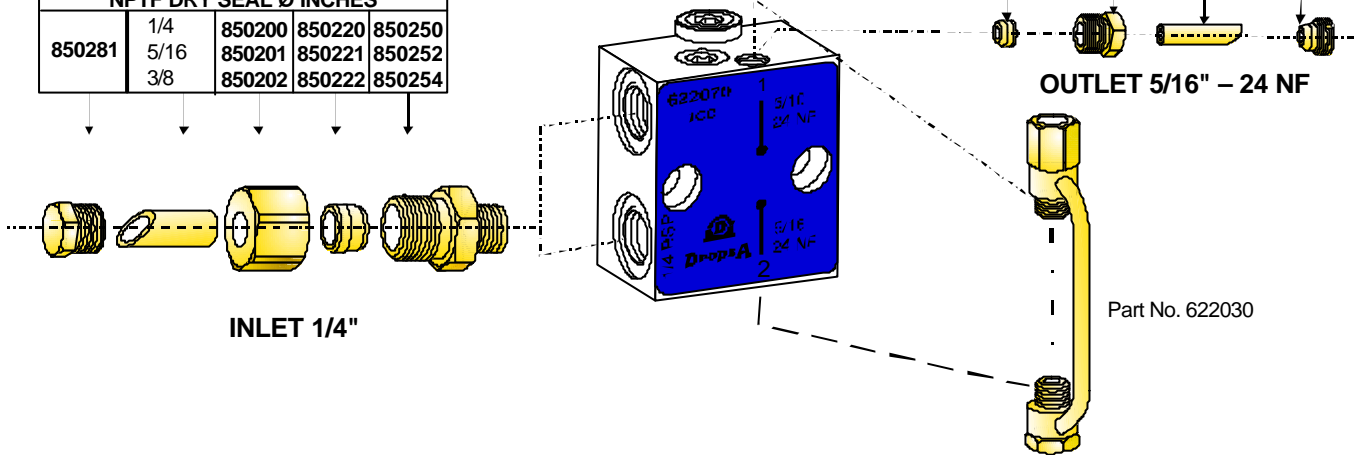

INLET 1/4"

Part No. 622030

WELD PLATES FOR FEEDERS

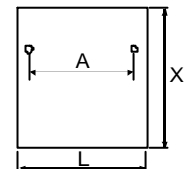
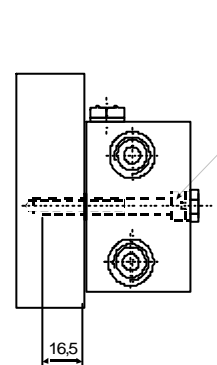
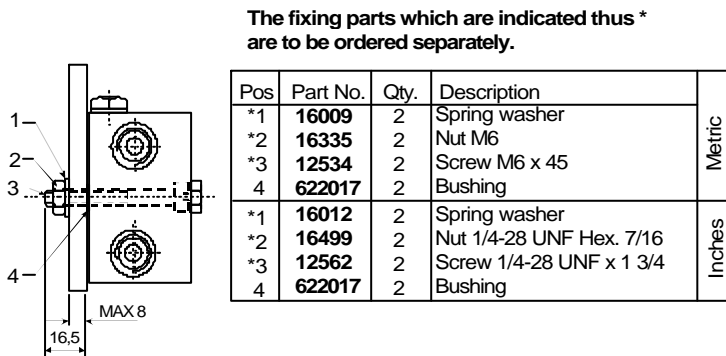

N.	Part No.	DIMENSIONS (INCHES)		
		A	L	X
1	111585	33 (1.29)	45 (1.77)	120 (4.72)
2	111586	53 (2.08)	65 (2.55)	120 (4.72)
3	111587	73 (2.87)	85 (3.34)	120 (4.72)
4	111588	93 (3.66)	105 (4.13)	120 (4.72)

**U.K.**  
Dropsa (UK) Ltd.  
Unit 6, Egham Business Village,  
Egham,  
Surrey. TW20 8RB  
Tel: (+44) 01784 - 431177  
Fax: (+44) 01784 - 438598  
E-mail: salesuk@dropsa.com

**U.S.A.**  
Dropsa USA Inc.  
50679 Wing Drive  
Utica,  
Michigan 48315,  
Tel: (+1) 810-566-1540  
Fax: (+1) 810-566-1541  
E-mail: salesusa@dropsa.com

**AUSTRALIA**  
Dropsa Australia Pty.  
No. 7 Warringah Road  
Dee Why  
NSW 2099  
Tel: (+61) 2 9905 0410  
Fax: (+61) 2 99394142  
E-mail: sales@dropsa.com

**GERMANY**  
Dropsa GmbH.  
Volmerswerther Strasse 80  
40221 Dusseldorf 1,  
Deutschland  
Tel: (+49) 0211-394-011  
Fax: (+49) 0211-394-013  
E-mail: sales@dropsa.de

**ITALY**  
Dropsa Spa  
Via B. Croce, 1 - 20090  
Vimodrone (MI)  
Tel: (+39) 02 - 250.79.1  
Fax: (+39) 02 - 250.79.767  
E-mail: sales@dropsa.it (Export)  
E-mail: vendite@dropsa.it (National)

© Copyright Dropsa - all rights reserved. Reproduction of any part of this document is strictly forbidden without prior consent from Dropsa. Dropsa reserves the right to modify specifications without prior notice.





# FEEDER BLOCK SERIES AP6

Adjustable Discharge.25-1.5 cc.per/stroke  
(.15 -.091 cu. in./stroke)  
Dual Line System

622250 623250  
624250 625250  
622150 623150  
624150 625150  
622175 623175  
624175 625175

ENGLISH

## PRODUCT DATA SHEET

### DESCRIPTION:

The feeder body is made of special anti-friction steel. Pistons are made of tempered steel. Bores and pistons are lapped to provide superior sealing. The indicator turrets are provided with integral adjusting screws together with a metacrylate cover and seal. On request an aluminium cover can be supplied. The feeder body has a galvanized finish and features an adaptor for single or double outlet conversion.

### SPECIFICATION:

**Temperature range:** -30 to +80°C.  
**Max. pressure (inlet):** 400 bar (5800 psi.)  
**Cycles:** 100/min.  
**Min. Viscosity:** 15 cSt (77 SSU)  
**Grease Max.:** 220 ASTM (NLGI 3)  
**Connections:**  
**Inlet:** 1/4"  
**Outlet:** 1/4"

### ORDERING INFORMATION:

Ordering is by Part No., refer to the following table:

Thread.	Part No.	Weight.		No. Outlets.
		Kg.	Lbs.	
Dropsa Standard BSP.	622250	0,850	1.87	1-2
	623250	1,300	2.87	2-4
	624250	1,660	3.65	3-6
	625250	2,050	4.51	4-8
	622150	0,850	1.87	1-2
Din 3852 X BSP	623150	1,300	2.87	2-4
	624150	1,660	3.65	3-6
	625150	2,050	4.51	4-8
	622175	0,850	1.87	1-2
NPTF	623175	1,300	2.87	2-4
	624175	1,660	3.65	3-6
	625175	2,050	4.51	4-8

### INSTALLATION/OPERATION:

**Function: (Refer to Figs. 1 and 3.)**The feeder discharge is controlled by a servo-piston (A) and metering piston (B)

and can be arranged to provide a single or double outlet. Fig. D-E= 2 separate outlets Fig. F-G=1outlet. Feeders are normally supplied with double outlets unless otherwise specified. Retrospective conversion can be undertaken by fitting adaptor Y (code 622076) for single outlet and X (code 622077) for double outlet (see

following page). When single outlet feeders are used the discharge per complete cycle = .5-3 cc/stroke (.03-.183 cu.in./stroke).



**Dimensions: (Refer to Fig. 2.)**

**Mounting: (Refer to Fig. 2.)** Aluminium bushings Part. No 3008107 are supplied for mounting on uneven surfaces to prevent distortion or damage due to overtightening.

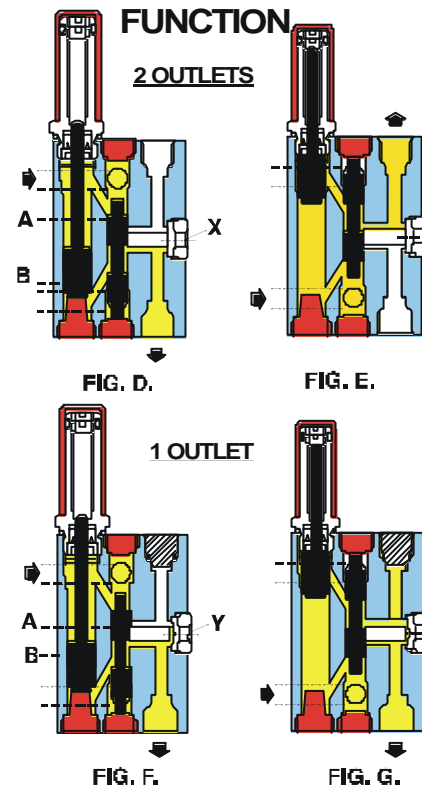

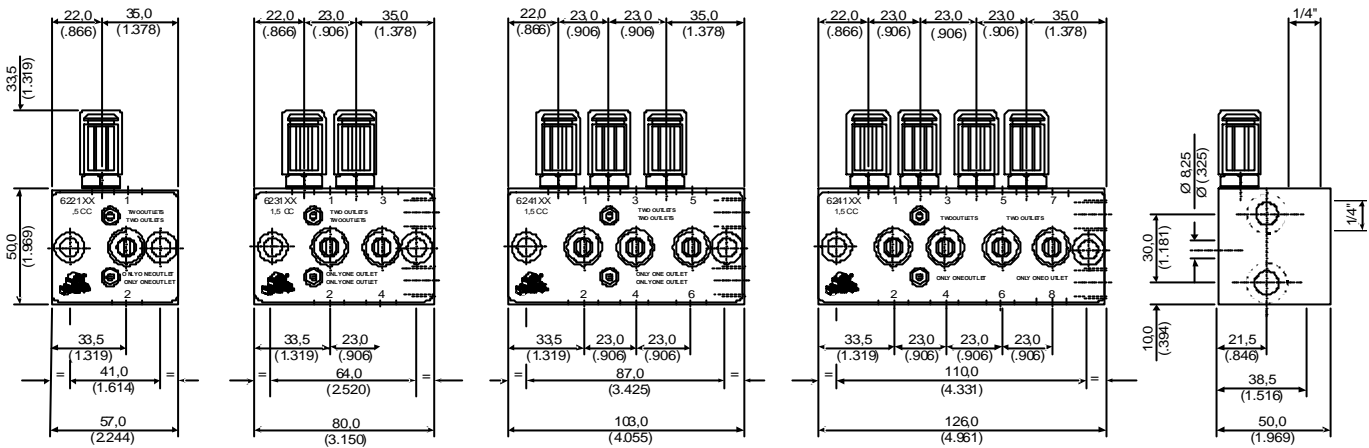

Dropsa Standard feeder blocks are normally supplied with outlets having a conical seating for Ø8 mm. (5/16") tube. This is simple and cost effective as no fitting is required.

If required a check-valve Part No. 92313 BSP or Part No. 92340 NPTF can be fitted at the outlet. Order separately.

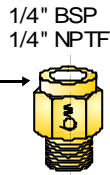

Aluminium cover Part No. 622256  
Metacrylate cover Part No. 622160

DROPSA STANDARD				
Reducer	Cone	Nut	Ø Tube	Plug
671038	93006	92014	Ø 6	91011
671038	93008	92053	Ø 8	91011

Seal Part No. 671001

INLET 1/4"

OUTLET 1/4"

DROPSA STANDARD DIN 3852 BSP Ø mm.				
Plug	Tube Ø	Nut	Ring	Fitting
926001	Ø 8	91406	91601	92269
	Ø 10	91411	91607	92240
	Ø 12	91416	91612	92241
NPTF DRY SEAL Ø INCHES				
850281	Ø 5/16	850202	850222	850255
	Ø 3/8	850203	850223	850257
	Ø 1/2	850204	850224	850259

DIN 3852 BSP Ø mm				
Fitting	Ring	Nut	Ø Tube	Plug
91952	91590	91396	Ø 6	622167
91959	91596	91401	Ø 8	
91966	91601	91406	Ø 10	
NPTF DRY SEAL Ø INCHES				
850250	850220	850200	Ø 1/4	850281
850252	850221	850201	Ø 5/16	
850254	850222	850202	Ø 3/8	

- The double outlet adaptor (622077) is identifiable by two parallel line markings in the centre; the single outlet adaptor (622076) has a circular marking only.

WELD PLATES FOR FEEDERS

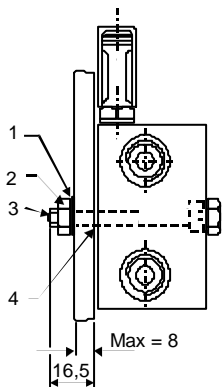

The fixing parts which are indicated are to be ordered

Pos.	Part No.	Qty.	Description
1	16012	2	Spring washer
2	16406	2	Nut M8 - Hex
3	12552	2	Screw M8 x 60
4	3008107	2	Bushing
1	16012	2	Spring washer
2	16500	2	Nut 5/16-24 UNF x 2-1/2
3	12561	2	Screw 5/16-24 UNF x 2-1/2
4	3008107	2	Bushing

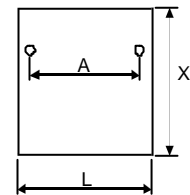
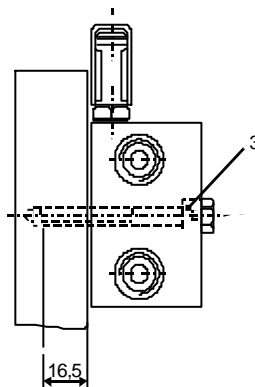

Pos.	Part No.	Dimensions (inches)		
		A	L	X
1	111581	41 (1.614")	60 (2.362")	140 (5.511")
2	111582	64 (2.520")	85 (3.346")	140 (5.511")
3	111583	87 (3.425")	110 (4.330")	140 (5.511")
4	111584	110 (4.330")	130 (5.118")	140 (5.511")

**U.K.**  
Dropsa (UK) Ltd.  
Unit 6, Egham Business Village,  
Egham,  
Surrey, TW20 8RB  
Tel: (+44) 01784 - 431177  
Fax: (+44) 01784 - 435898  
E-mail: salesuk@dropsa.com

**U.S.A.**  
Dropsa USA Inc.  
50679 Wing Drive  
Utica,  
Michigan 48315,  
Tel: (+1) 810-566-1540  
Fax: (+1) 810-566-1541  
E-mail: salesusa@dropsa.com

**AUSTRALIA**  
Dropsa Australia Pty.  
No. 7 Warringah Road  
Dee Why  
NSW 2099  
Tel: (+61) 2 9905 0410  
Fax: (+61) 2 99394142  
E-mail: sales@dropsa.com

**GERMANY**  
Dropsa GmbH.  
Volmerswerther Strasse 80  
40221 Dusseldorf 1,  
Deutschland  
Tel: (+49) 0211-394-011  
Fax: (+49) 0211-394-013  
E-mail: sales@dropsa.de

**ITALY**  
Dropsa Spa  
Via B. Croce, 1 - 20090  
Vimodrone (MI)  
Tel: (+39) 02 - 250.79.1  
Fax: (+39) 02 - 250.79.767  
E-mail: sales@dropsa.it (Export)  
E-mail: vendite@dropsa.it (National)

© Copyright Dropsa - all rights reserved. Reproduction of any part of this document is strictly forbidden without prior consent from Dropsa. Dropsa reserves the right to modify specifications without prior notice.





# FEEDER BLOCK SERIES AP6F

Fixed Discharge 1,5cc. per stroke  
(.091 cu.in./stroke)  
Dual Line System

622190 623190  
624190 625190  
622180 623180  
624180 625180  
622140 623140  
624140 625140

ENGLISH

## PRODUCT DATA SHEET

### DESCRIPTION:

The feeder body is made of special anti-friction steel. Pistons are made of tempered steel. Bores and pistons are lapped to provide superior sealing. These feeders do not employ indicator turrets (see AP6 series) and are used for special applications. The body has a galvanized finish and features an adaptor for single or double outlet conversion. They are set by the factory at 1,5 cc./stroke(.091 cu. in./ stroke) unless otherwise requested.

### SPECIFICATION:

Temperature range: -30 +80°C.(-22+176°F.)

Max. pressure (inlet): 400 bar (5800 psi.)

Cycles: 100/min.

Min. Viscosity: 15 cSt (77 SSU)

Grease Max.: 220 ASTM (NLGI 3)

#### Connections:

Inlet: 1/4"

Outlet: 1/4"

### ORDERING INFORMATION:

Ordering is by Part No., refer to the following table:

Thread	Part No.	Weight.		No. outlets
		Kg.	Lbs.	
Dropsa Standard BSP	622190	0,820	1.80	1 - 2
	623190	1,230	2.71	2 - 4
	624190	1,560	3.44	3 - 6
	625190	1,920	4.23	4 - 8
Din 3852 x BSP	622180	0,820	1.80	1 - 2
	623180	1,230	2.71	2 - 4
	624180	1,560	3.44	3 - 6
	625180	1,920	4.23	4 - 8
NPTF	622140	0,820	1.80	1 - 2
	623140	1,230	2.71	2 - 4
	624140	1,560	3.44	3 - 6
	625140	1,920	4.23	4 - 8

### INSTALLATION/OPERATION:

Function:(Refer to Figs. 1 and 3.)

In installations where backpressure is detected at the outlets of the feeder blocks, a check- valve must be fitted to each outlet. The feeder discharge is controlled by a servo-piston (A) and metering piston (B) and can be arranged to provide a single or double outlet. Fig. D-E= 2 separate outlets Fig. F-G =1 outlet. Feeders are normally supplied with double outlets unless otherwise specified. Retrospective conversion can be undertaken by fitting adaptor Y (Part No. 622076) for single outlet and X (Part No. 622077) for double outlet. When single



outlet feeders are used the discharge per complete cycle = 3 cc./stroke (.183 cu.in. / stroke).

#### Dimensions:

Mounting: (Refer to Fig. 2.)

Aluminium bushings (Part. No. 3008107) are supplied for mounting on uneven surfaces to prevent distortion or damage due to overtightening.

### FUNCTION

#### 2 OUTLETS

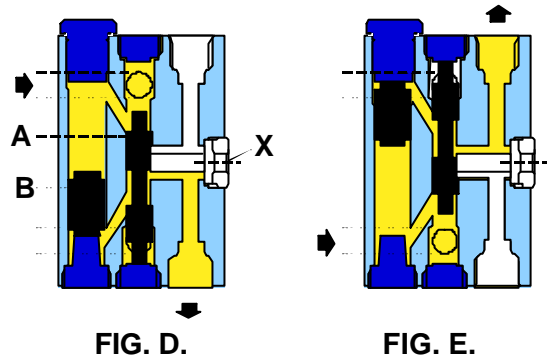

#### 1 OUTLET

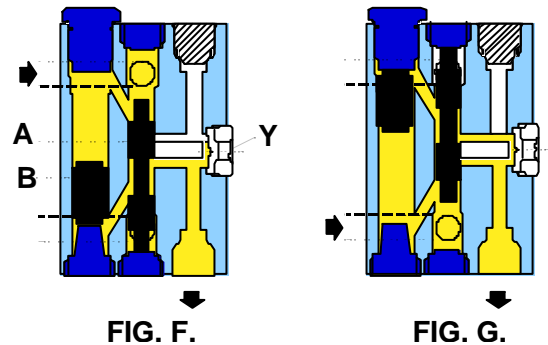

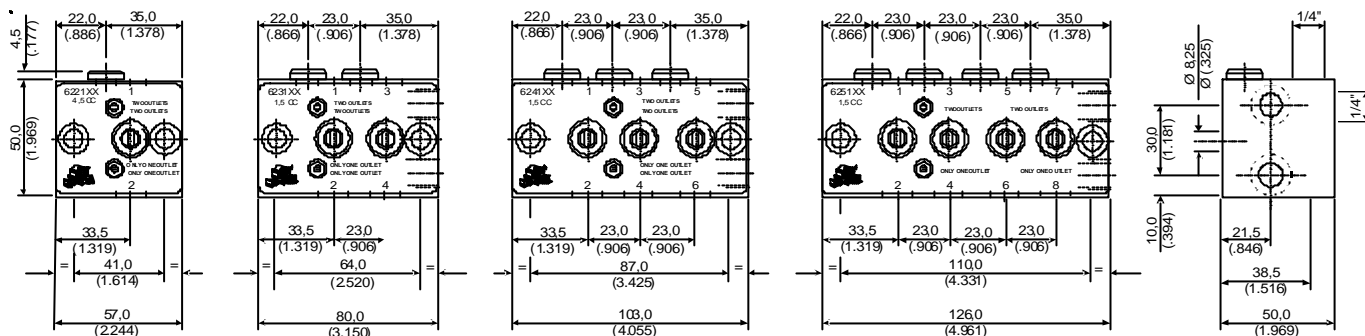

Dropsa Standard feeder blocks are normally supplied with outlets having a conical seating for Ø8 mm. (5/16") tube. This is simple and cost effective as no fitting is required.

If required a check valve Part No. 92313 BSP or Part No. 92340 NPTF can be fitted at the outlet. Order separately.

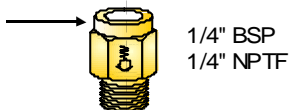

DROPSA STANDARD				
Reducer	Cone	Nut	Ø Tube	Plug
671038	93006	92014	Ø6	91011
671038	93008	92053	Ø8	91011

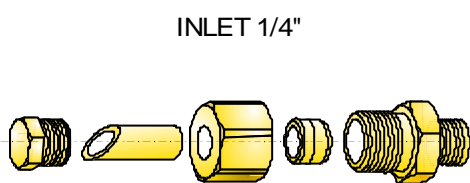

INLET 1/4"

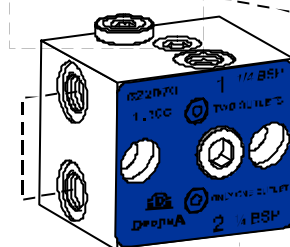

OUTLET 1/4"

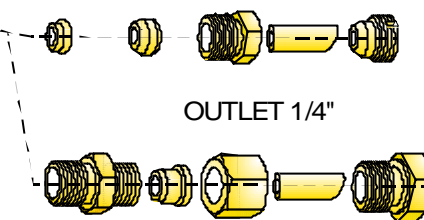

DROPSA STANDARD DIN 3852 BSP Ø mm.				
Plug	Tube Ø	Nut	Ring	Fitting
926001	Ø 8	91406	91601	92269
	Ø 10	91411	91607	92240
	Ø 12	91416	91612	92241
NPTF DRY SEAL Ø INCHES				
850281	Ø 5/16	850202	850222	850255
	Ø 3/8	850203	850223	850257
	Ø 1/2	850204	850224	850259

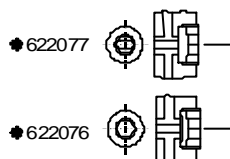

DIN 3852 BSP Ø mm				
Fitting	Ring	Nut	Ø Tube	Plug
91952	91590	91396	Ø 6	622167
91959	91596	91401	Ø 8	
91966	91601	91406	Ø 10	
NPTF DRY SEAL Ø INCHES				
850250	850220	850200	Ø 1/4	850281
850252	850221	850201	Ø 5/16	
850254	850222	850202	Ø 3/8	

- The double outlet adaptor (**622077**) is identifiable by two parallel line markings in the centre; the single outlet adaptor (**622076**) has a circular marking only.

The fixing parts which are indicated thus \* are to be ordered separately.

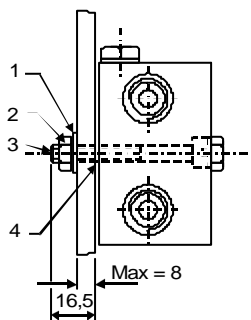

Pos.	Part No.	Qty.	Description	
*1	16012	2	Spring washer	Metric
*2	16406	2	Nut M8 - Hex	
*3	12552	2	Screw M8 x 60	
4	3008107	2	Bushing	
*1	16012	2	Spring washer	Inch
*2	16500	2	Nut 5/16-24 UNF x 2-1/2	
*3	12561	2	Screw 5/16-24 UNF x 2-1/2	
4	3008107	2	Bushing	

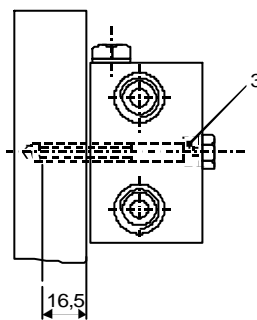

WELD PLATES FOR FEEDERS

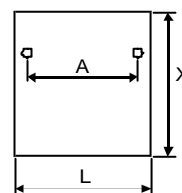

Pos.	Part No.	Dimensions (inches)		
		A	L	X
1	111581	41 (1.614")	60 (2.362")	140 (5.511")
2	111582	64 (2.520")	85 (3.346")	140 (5.511")
3	111583	87 (3.425")	110 (4.330")	140 (5.511")
4	111584	110 (4.330")	130 (5.118")	140 (5.511")

**U.K.**  
Dropsa (UK) Ltd.  
Unit 6, Egham Business Village,  
Egham,  
Surrey. TW20 8RB  
Tel: (+44) 01784 - 431177  
Fax: (+44) 01784 - 438598  
E-mail: salesuk@dropsa.com

**U.S.A.**  
Dropsa USA Inc.  
50679 Wing Drive  
Utica,  
Michigan 48315,  
Tel: (+1) 810-566-1540  
Fax: (+1) 810-566-1541  
E-mail: salesusa@dropsa.com

**AUSTRALIA**  
Dropsa Australia Pty.  
No. 7 Warringah Road  
Dee Why  
NSW 2099  
Tel: (+61) 2 9905 0410  
Fax: (+61) 2 99394142  
E-mail: sales@dropsa.com

**GERMANY**  
Dropsa Gmbh.  
Volmerswerther Strasse 80  
40221 Dusseldorf 1,  
Deutschland  
Tel: (+49) 0211-394-011  
Fax: (+49) 0211-394-013  
E-mail: sales@dropsa.de

**ITALY**  
Dropsa Spa  
Via B. Croce, 1 - 20090  
Vimodrone (MI)  
Tel: (+39) 02 - 250.79.1  
Fax: (+39) 02 - 250.79.767  
E-mail: sales@dropsa.it (Export)  
E-mail: vendite@dropsa.it (National)

© Copyright Dropsa - all rights reserved. Reproduction of any part of this document is strictly forbidden without prior consent from Dropsa. Dropsa reserves the right to modify specifications without prior notice.



# FEEDER BLOCK SERIES AG6

Adjustable Discharge 0,25 - 3 cc. per/stroke  
(.015-.183 cu. in. / stroke)  
Dual Line System

671200 671300  
671310 672300  
672200 672310  
673300 673200  
673310 674300  
674200 674310

ENGLISH

## PRODUCT DATA SHEET

### DESCRIPTION:

The feeder body is made of special anti-friction steel. Pistons are made of tempered steel. Bores and pistons are lapped to provide superior sealing. The indicator turrets are provided with integral adjusting screws together with a metacrylate cover and seal. On request an aluminium cover can be supplied. The feeder body has a galvanised finish and features an adaptor for single or double outlet conversion.

### SPECIFICATION:

**Temperature range:** -30 to +80°C.  
**Max. pressure (inlet):** 400 bar (5800 psi.)  
**Cycles:** 100/min.  
**Min. Viscosity:** 15 cSt (77 SSU)  
**Grease Max.:** 220 ASTM (NLGI 3)  
**Connections:**  
**Inlet:** 3/8"  
**Outlet:** 1/4"

In installations where backpressure is detected at the outlets of the feeder blocks, a checkvalve must be fitted to each outlet (see following page).

### ORDERING INFORMATION:

Ordering is by Part No., refer to the following table:

Thread.	Part No.	Weight.		No. Outlets.
		Kg.	Lbs.	
Dropsa Standard BSP	671300	1,600	3.52	1
	672300	2,250	4.95	2
	673300	2,950	6.49	3
	674300	3,550	7.81	4
Din 3852 x BSP	671200	1,600	3.52	1
	672200	2,250	4.95	2
	673200	2,950	6.49	3
	674200	3,550	7.81	4
NPTF	671310	1,600	3.52	1
	672310	2,250	4.95	2
	673310	2,950	6.49	3
	674310	3,550	7.81	4

**Function:(Refer to Figs. 1 and 3.)** The feeder discharge is controlled by a servo -piston ( A ) and a metering piston ( B ) and can be arranged to provide a single or double outlet. Fig. D-E = 2 separate outlets Fig. F-G=1 outlet. Feeders are normally supplied with double outlets unless otherwise specified. Retrospective conversion can be undertaken by fitting adaptor Y (Part No. 622076) for single outlet and X (Part No. 622077) for double outlet (see following page). When single outlet feeders are used the discharge per complete cycle = 0,5-6 cc./stroke.(.03 - .366 cu. in./stroke)



The double outlet adaptor (Part No. 622077) is identifiable by two parallel line markings in the centre; the single outlet adaptor (Part No.622076) has a circular marking only.

### Dimensions:

**Mounting: (Refer to Fig. 2.)**

Aluminium bushings (Part No. 3008107) are supplied for mounting on uneven surfaces to prevent distortion or damage due to overtightening.

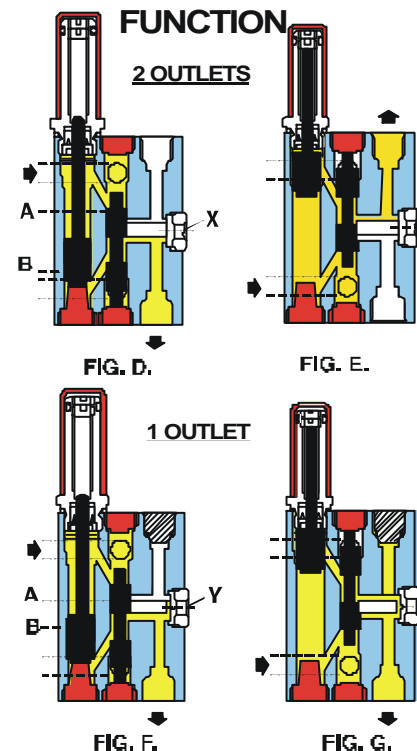

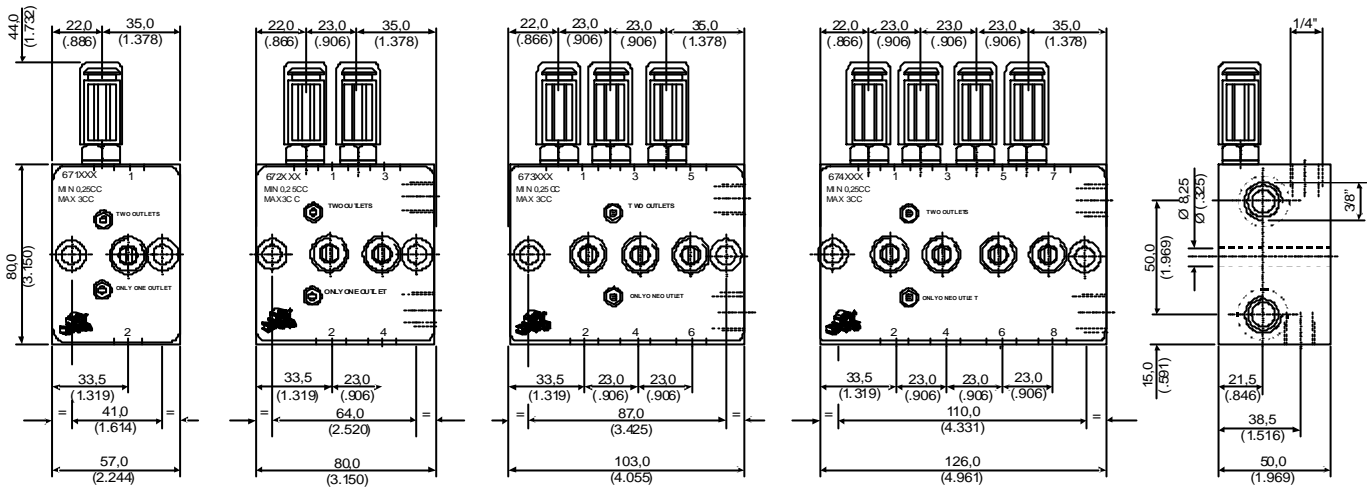

Dropsa Standard feeder blocks are normally supplied with outlets having a conical seating for Ø8 mm. (5/16") tube. This is simple and cost effective as no fitting is required.

If required a check-valve Part No. 92313 BSP or Part No. 92340 NPTF can be fitted at the outlet. Order separately.

1/4" BSP  
1/4" NPTF

Aluminium cover Part No. 62256  
Metacrylate cover Part No. 622160

DROPSA STANDARD				
Reducer	Cone	Bush	Ø Tube	Plug
671038	93006	92014	Ø 6	91011
671038	93008	92053	Ø 8	91011

Seal Part No. 671001

INLET 3/8"

OUTLET 1/4"

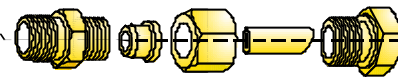
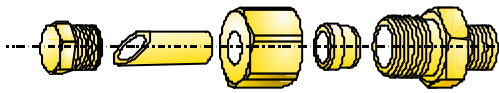

DROPSA STANDARD DIN 3852 BSP Ø mm.				
Plug	Tube Ø	Nut	Ring	Fitting
926002	Ø 10	91406	91601	92269
	Ø 12	91411	91607	92240
	Ø 16	91416	91612	92241
NPTF DRY SEAL Ø INCHES				
850282	Ø 3/8	850202	850222	850255
	Ø 1/2	850203	850223	850257
	Ø 5/8	850204	850224	850259

DIN 3852 BSP Ø mm				
Fitting	Ring	Nut	Ø Tube	Plug
91952	91590	91396	Ø 6	622167
91959	91596	91401	Ø 8	
91966	91601	91406	Ø 10	
NPTF DRY SEAL Ø INCHES				
850250	850220	850200	Ø 1/4	850281
850252	850221	850201	Ø 5/16	
850254	850222	850202	Ø 3/8	

The double outlet adaptor (622077) is identifiable by two parallel line markings in the center; the single outlet adaptor (622076) has a circular marking only.

WELD PLATES FOR FEEDERS

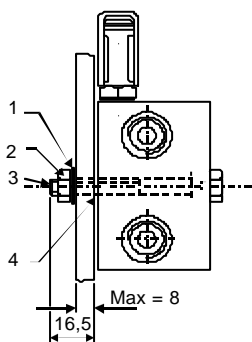

The fixing parts which are indicated thus are to be ordered separately.

Pos.	Part No.	Qty.	Description
1	16012	2	Spring washer
2	16406	2	Nut M8 - Hex
3	12552	2	Screw M8 x 60
4	3008107	2	Bushing
1	16012	2	Spring washer
2	16500	2	Nut 5/16-24 UNF x 2-1/2
3	12561	2	Screw 5/16-24 UNF x 2-1/2
4	3008107	2	Bushing (3 - 1/4)

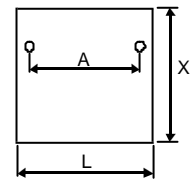
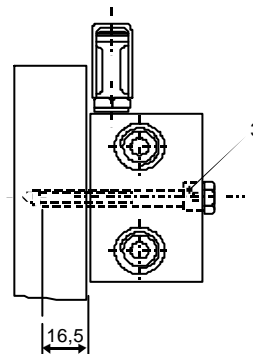

Pos.	Part No.	Dimensions (inches)		
		A	L	X
1	111581	41 (1.614")	60 (2.362")	140 (5.511")
2	111582	64 (2.520")	85 (3.346")	140 (5.511")
3	111583	87 (3.425")	110 (4.330")	140 (5.511")
4	111584	110 (4.330")	130 (5.118")	140 (5.511")

**U.K.**  
Dropsa (UK) Ltd.  
Unit 6, Egham Business Village,  
Egham,  
Surrey, TW20 8RB  
Tel: (+44) 01784 - 431177  
Fax: (+44) 01784 - 438598  
E-mail: salesuk@dropsa.com

**U.S.A.**  
Dropsa USA Inc.  
50679 Wing Drive  
Utica,  
Michigan 48315,  
Tel: (+1) 810-566-1540  
Fax: (+1) 810-566-1541  
E-mail: salesusa@dropsa.com

**AUSTRALIA**  
Dropsa Australia Pty.  
No. 7 Warringah Road  
Dee Why  
NSW 2099  
Tel: (+61) 2 9905 0410  
Fax: (+61) 2 99394142  
E-mail: sales@dropsa.com

**GERMANY**  
Dropsa GmbH.  
Volmerswerther Strasse 80  
40221 Dusseldorf 1,  
Deutschland  
Tel: (+49) 0211-394-011  
Fax: (+49) 0211-394-013  
E-mail: sales@dropsa.de

**ITALY**  
Dropsa Spa  
Via B. Croce, 1 - 20090  
Vimodrone (MI)  
Tel: (+39) 02 - 250.79.1  
Fax: (+39) 02 - 250.79.767  
E-mail: sales@dropsa.it (Export)  
E-mail: vendite@dropsa.it (National)

© Copyright Dropsa - all rights reserved. Reproduction of any part of this document is strictly forbidden without prior consent from Dropsa. Dropsa reserves the right to modify specifications without prior notice.



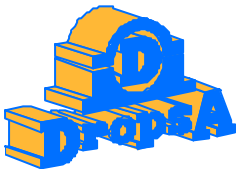

# FEEDER BLOCK SERIES AG 6F

Fixed discharge 3 cc. per stroke  
(.183 cu. in./stroke) Dual Line System

671190 672190  
673190 674190  
671180 672180  
673180 674180  
671140 672140  
673140 674140

## PRODUCT DATA SHEET

ENGLISH

### DESCRIPTION:

The feeder body is made of special anti-friction steel. Pistons are made of tempered steel. Bores and pistons are lapped to provide superior sealing. These feeders do not employ indicator turrets (see AG6 series) and are used for special applications. The body has a galvanized finish and features an adaptor for single or double outlet conversion. They are set by the factory at 3 cc. (.183 cu. in.) unless otherwise requested.

### SPECIFICATION:

**Temperature range:** -30 to +80°C.  
**Max. pressure (inlet):** 400 bar (5800 psi.)  
**Max. Cycles:** 100/min.  
**Min. Viscosity:** 15 cSt (77 SSU)  
**Grease Max.:** 220 ASTM (NLGI 3)  
**Connections**  
**Inlet:** 3/8"  
**Outlet:** 1/4"

### ORDERING INFORMATION:

Ordering is by Part No., refer to the following table:

Thread	Part No.	Weight.		No. Outlets.
		Kg.	Lbs.	
Dropsa Standard BSP	671190	1,560	3.43	1-2
	672190	2,160	4.76	2-4
	673190	2,820	6.21	3-6
	674190	3,370	7.42	4-8
Din 3852 X BSP	671180	1,560	3.43	1-2
	672180	2,160	4.76	2-4
	673180	2,820	6.21	3-6
	674180	3,370	7.42	4-8
NPTF	671140	1,560	3.43	1-2
	672140	2,160	4.76	2-4
	673140	2,820	6.21	3-6
	674140	3,370	7.42	4-8

### INSTALLATION/OPERATION:

**Function:(Refer to Figs. 1 and 3.)**The feeder discharge is controlled by a servo-piston (A) and a metering piston (B) and can be arranged to provide a single or double outlet. Fig. D-E = 2 separate outlets Fig. F-G. = 1 outlet. Feeders are normally supplied with double outlets unless otherwise specified. Retrospective conversion can be undertaken by fitting adaptor Y (Part No. 622076) for single outlet and X (Part No. 622077) for double outlet (see following page). When single outlet feeders are used the discharge per complete cycle = 6 cc./stroke (.366 cu. in./stroke).



**Dimensions:** (Refer to Fig. 2.).

**Mounting:** (Refer to Fig. 2.). Aluminium bushings (Part No. 3008107) are supplied for mounting on uneven surfaces to prevent distortion or damage due to overtightening.

### FUNCTION

#### 2 OUTLETS

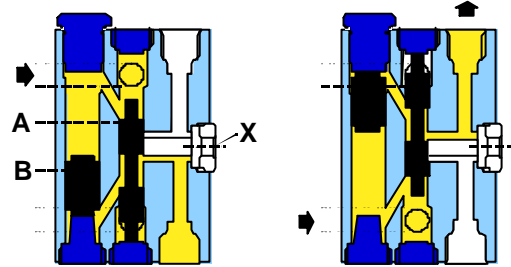

FIG. D.

FIG. E.

#### 1 OUTLET

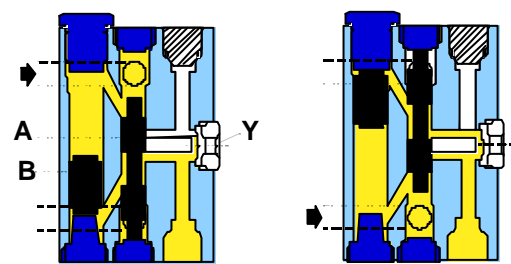
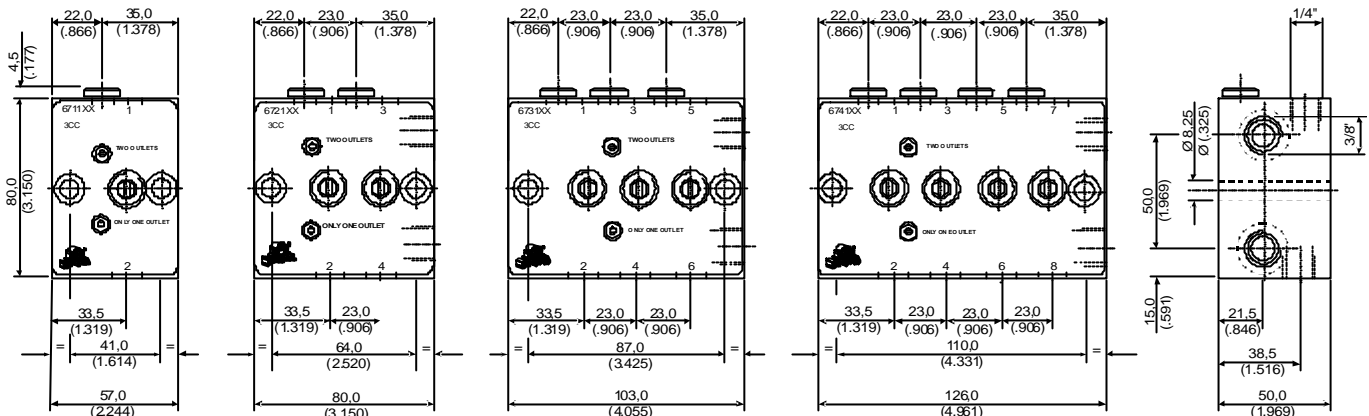

FIG. F.

FIG. G.



Dropsa Standard feeder blocks are normally supplied with outlets having a conical seating for Ø8 mm. (5/16") tube.  
This is simple and cost effective as no fitting is required.

DROPSA STANDARD				
Reducer	Cone	Bush	Ø Tube	Plug
671038	93006	92014	Ø 8	91011
671038	93008	92053	Ø 8	91011

If required a check-valve **Part No. 92313 BSP** or **Part No. 92340 NPTF** can be fitted at the outlet. Order separately.

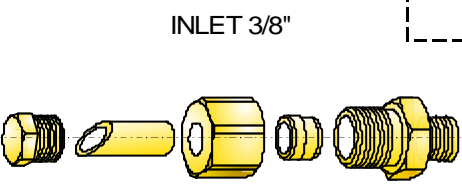
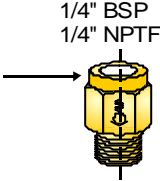

DROPSA STANDARD DIN 3852 BSP Ø mm.				
Plug	Tube Ø	Nut	Ring	Fitting
926002	Ø 8	91406	91601	92269
	Ø 10	91411	91607	92240
	Ø 12	91416	91612	92241
NPTF DRY SEAL Ø INCHES				
850282	Ø 5/16	850202	850222	850255
	Ø 3/8	850203	850223	850257
	Ø 1/2	850204	850224	850259

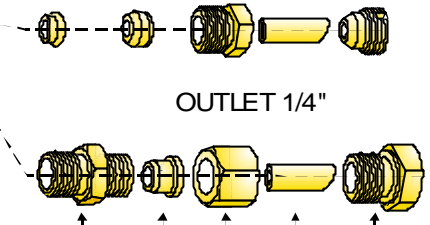
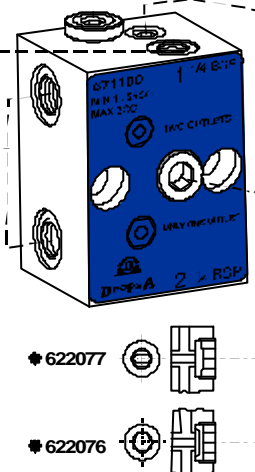

DIN 3852 BSP Ø mm				
Fitting	Ring	Nut	Ø Tube	Plug
91952	91590	91396	Ø 6	622167
91959	91596	91401	Ø 8	
91966	91601	91406	Ø 10	
NPTF DRY SEAL Ø INCHES				
850250	850220	850200	Ø 1/4	850281
850252	850221	850201	Ø 5/16	
850254	850222	850202	Ø 3/8	

- The double outlet adaptor (**622077**) is identifiable by two parallel line markings in the centre; the single outlet adaptor (**622076**) has a circular marking only.

WELD PLATES FOR FEEDERS

The fixing parts which are indicated thus \* are to be ordered separately.

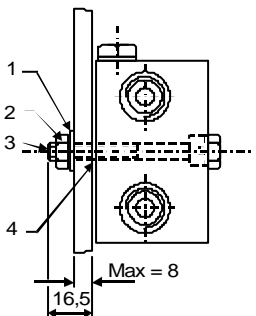

Pos.	Part No.	Qty.	Description	
*1	16012	2	Spring washer	Metric
*2	16406	2	Nut M8 - Hex	
*3	12552	2	Screw M8 x 60	
4	3008107	2	Bushing	
*1	16012	2	Spring washer	Inch
*2	16500	2	Nut 5/16-24 UNF x 2-1/2	
*3	12561	2	Screw 5/16-24 UNF x 2-1/2	
4	3008107	2	Bushing	

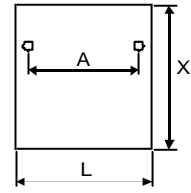
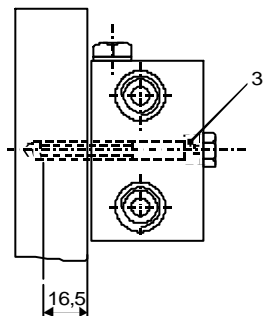

Pos.	Part No.	Dimensions (inches)		
		A	L	X
1	111581	41 (1.614")	60 (2.362")	140 (5.511")
2	111582	64 (2.520")	85 (3.346")	140 (5.511")
3	111583	87 (3.425")	110 (4.330")	140 (5.511")
4	111584	110 (4.330")	130 (5.118")	140 (5.511")

**U.K.**  
Dropsa (UK) Ltd.  
Unit 6, Egham Business Village,  
Egham,  
Surrey. TW20 8RB  
Tel: (+44) 01784 - 431177  
Fax: (+44) 01784 - 438598  
E-mail: salesuk@dropsa.com

**U.S.A.**  
Dropsa USA Inc.  
50679 Wing Drive  
Utica,  
Michigan 48315,  
Tel: (+1) 810-566-1540  
Fax: (+1) 810-566-1541  
E-mail: salesusa@dropsa.com

**AUSTRALIA**  
Dropsa Australia Pty.  
No. 7 Warringah Road  
Dee Why  
NSW 2099  
Tel: (+61) 2 9905 0410  
Fax: (+61) 2 99394142  
E-mail: sales@dropsa.com

**GERMANY**  
Dropsa GmbH.  
Volmerswerther Strasse 80  
40221 Dusseldorf 1,  
Deutschland  
Tel: (+49) 0211-394-011  
Fax: (+49) 0211-394-013  
E-mail: sales@dropsa.de

**ITALY**  
Dropsa Spa  
Via B. Croce, 1 - 20090  
Vimodrone (MI)  
Tel: (+39) 02 - 250.79.1  
Fax: (+39) 02 - 250.79.767  
E-mail: sales@dropsa.it (Export)  
E-mail: vendite@dropsa.it (National)

© Copyright Dropsa - all rights reserved. Reproduction of any part of this document is strictly forbidden without prior consent from Dropsa. Dropsa reserves the right to modify specifications without prior notice.





# FEEDER BLOCK SERIES AGG6

Adjustable discharge 1.5 -12 cc. per stroke  
(.091 - .732 cu. in./ stroke) Dual Line System

626200 627200  
628200 629200  
626230 627230  
628230

## PRODUCT DATA SHEET

ENGLISH

### DESCRIPTION:

The feeder body is made of special anti-friction steel. Pistons are made of tempered steel. Bores and pistons are lapped to provide superior sealing. The indicator turrets are provided with integral adjusting screws together with a metacrylate cover and seal. On request an aluminium cover can be supplied. The feeder body has a galvanized finish and features an adaptor for single or double outlet conversion.

### SPECIFICATION:

Temperature range: -30 - +80°C.  
Max. pressure (inlet): 400 bar (5800 psi.)  
Cycles: 100/min.  
Min. Viscosity: 15 cSt (77 SSU)  
Grease Max.: 220 ASTM (NLGI 3)  
Connections:  
Inlet: 3/8"  
Outlet: 3/8"



(Part No. 3008107) are supplied for mounting on uneven surfaces to prevent distortion or damage due to overtightening.

### ORDERING INFORMATION:

Ordering is by Part No., refer to the following table:

Thread	Part No.	Weight.		No. Outlets.
		Kg.	Lbs.	
Dropsa Standard BSP	626200	4,600	10.12	1 - 2
	627200	6,650	14.63	2 - 4
	628200	9,200	20.24	3 - 6
	629200	11,400	25.08	4 - 8
NPTF	626230	4,600	10.12	1 - 2
	627230	6,650	14.63	2 - 4
	628230	9,200	20.24	3 - 6
	629230	11,400	25.08	4 - 8

### INSTALLATION/OPERATION:

Function:(Refer to Figs. 1 and 3.)The feeder discharge is controlled by a servo-piston (A) and metering piston (B) and can be arranged to provide a single or double outlet. Fig. D-E = 2 separate outlets Fig. F-G = 1 outlet. Feeders are normally supplied with double outlets unless otherwise specified. Retrospective conversion can be undertaken by fitting adaptor Y (Part No. 626210) for single outlet and X (Part No.626209) for double outlet (see following page). When single outlet feeders are used the discharge per complete cycle = 3-24 cc./stroke (.183-1.464 cu.in./stroke).

Dimensions: (Refer to Fig. 2.).

Mounting: (Refer to Fig. 2.).Aluminium bushings

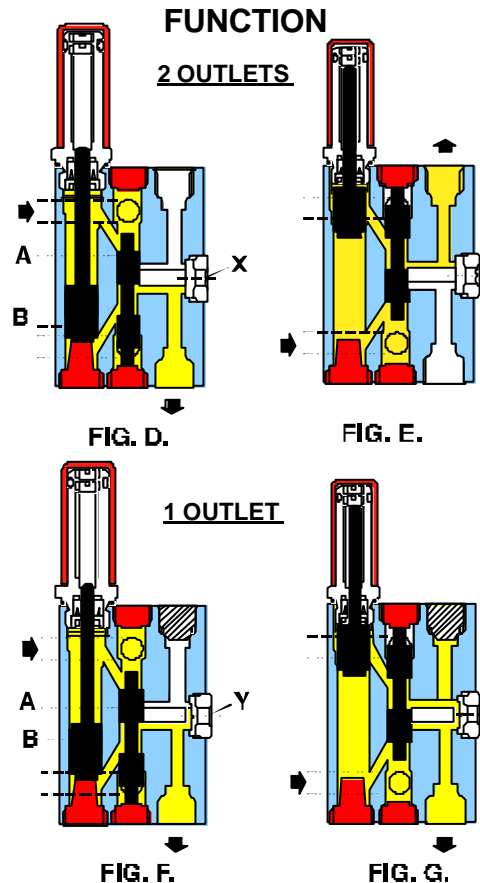

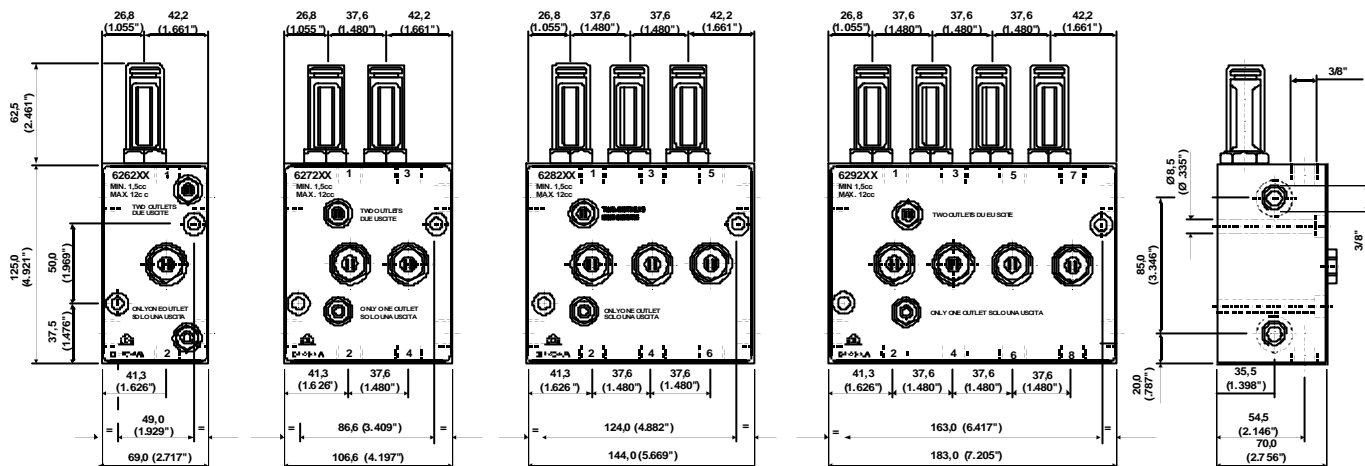

Aluminium cover  
**Part No. 626021**  
 Metacrylate cover  
**Part No. 3042118**

Dropsa Standard feeder blocks are normally supplied with outlets having a conical seating for Ø10 mm. (3/8") tube.  
 This is simple and cost effective as no fitting is required.

If required a check-valve  
**Part No. 92326 BSP** or  
**Part No. 92359 NPTF**  
 can be fitted at the outlet. Order separately.

3/8" BSP  
 3/8" NPTF

Seal  
**Part No. 19119**

DROPSA STANDARD Ø mm.			
Cone	Bush	Ø Tube	Plug
93010	92010	Ø 10	91003

INLET 3/8"

OUTLET 3/8"

DROPSA STANDARD DIN 3852 BSP Ø mm.				
Plug	Tube Ø	Nut	Ring	Fitting
926002	Ø 10	91406	91601	92269
	Ø 12	91411	91607	92240
	Ø 16	91416	91612	92241
NPTF DRY SEAL Ø INCHES				
850281	Ø 3/8	850202	850222	850255
	Ø 1/2	850203	850223	850257
	Ø 5/8	850204	850224	850259

DIN 3852 BSP Ø mm				
Fitting	Ring	Nut	Ø Tube	Plug
91706	91596	91402	Ø 8	3234020
91972	91601	91406	Ø 10	
91974	91607	91411	Ø 12	
NPTF DRY SEAL Ø INCHES				
850253	850221	850201	Ø 5/16	850282
850255	850222	850202	Ø 3/8	
850257	850223	850203	Ø 1/2	

\*The double outlet adaptor (**626209**) is identifiable by two parallel line markings in the centre; the single outlet adaptor (**626210**) has a circular marking only.

WELD PLATES FOR FEEDERS

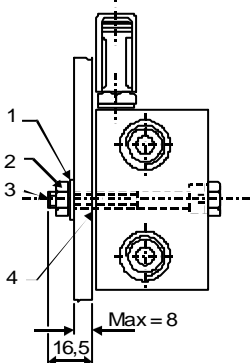

The fixing parts which are indicated thus \* are to be ordered separately.

Pos.	Part No.	Qty.	Description	
*1	16012	2	Spring washer	Metric
*2	16406	2	Nut M8 - Hex	
*3	12556	2	Screw M8 x 60	
4	3008107	2	Bushing	
*1	16012	2	Spring washer	Inch
*2	16500	2	Nut 5/16-24 UNF	
*3	12560	2	Screw 5/16-24 UNF x 3-1/4	
4	3008107	2	Bushing	

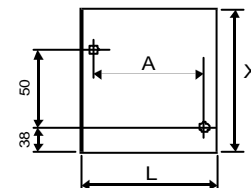
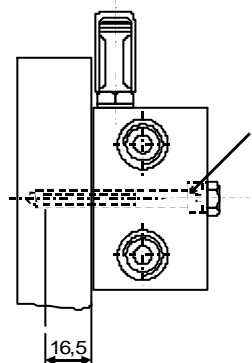

Pos.	Part No.	Dimensions (inches)		
		A	L	X
1	111576	49 (1.929")	70 (2.755")	190 (7.480")
2	111577	86 (3.385")	110 (4.330")	190 (7.480")
3	111578	124 (4.881")	150 (5.905")	190 (7.480")
4	111579	163 (6.417")	183 (7.204")	190 (7.480")

**U.K.**  
 Dropsa (UK) Ltd.  
 Unit 6, Egham Business Village,  
 Egham,  
 Surrey. TW20 8RB  
 Tel: (+44) 01784 - 431177  
 Fax: (+44) 01784 - 438598  
 E-mail: salesuk@dropsa.com

**U.S.A.**  
 Dropsa USA Inc.  
 50679 Wing Drive  
 Utica,  
 Michigan 48315,  
 Tel: (+1) 810-566-1540  
 Fax: (+1) 810-566-1541  
 E-mail: salesusa@dropsa.com

**AUSTRALIA**  
 Dropsa Australia Pty.  
 No. 7 Warringah Road  
 Dee Why  
 NSW 2099  
 Tel: (+61) 2 9905 0410  
 Fax: (+61) 2 99394142  
 E-mail: sales@dropsa.com

**GERMANY**  
 Dropsa GmbH.  
 Volmerswerther Strasse 80  
 40221 Dusseldorf 1,  
 Deutschland  
 Tel: (+49) 0211-394-011  
 Fax: (+49) 0211-394-013  
 E-mail: sales@dropsa.de

**ITALY**  
 Dropsa Spa  
 Via B. Croce, 1 - 20090  
 Vimodrone (MI)  
 Tel: (+39) 02 - 250.79.1  
 Fax: (+39) 02 - 250.79.767  
 E-mail: sales@dropsa.it (Export)  
 E-mail: vendite@dropsa.it (National)

© Copyright Dropsa - all rights reserved. Reproduction of any part of this document is strictly forbidden without prior consent from Dropsa. Dropsa reserves the right to modify specifications without prior notice.



# FEEDER BLOCK SERIES AGG6F

Fixed Discharge 12 cc. per/stroke  
(.732 cu. in./stroke) Dual Line System

626180 627180  
628180 629180  
626140 627140  
628140 629140

ENGLISH

## PRODUCT DATA SHEET

### DESCRIPTION:

The feeder body is made of special anti-friction steel. Pistons are made of tempered steel. Bores and pistons are lapped to provide superior sealing. These feeders do not employ indicator turrets (see AGG6 series) and are used for special applications. The body has a galvanized finish and features an adaptor for single or double outlet conversion. They are set by the factory at 12 cc./stroke (.732 cu. in./stroke) unless otherwise requested.

### SPECIFICATION:

**Temperature range:** -30 - +80°C.  
**Max. pressure (inlet):** 400 bar (5800 psi.)  
**Cycles:** 100/min.  
**Min. Viscosity:** 15 cSt (77 SSU)  
**Grease Max.:** 220 ASTM (NLGI 3)  
**Connections:**  
**Inlet:** 3/8"  
**Outlet:** 3/8"

### ORDERING INFORMATION:

Ordering is by Part No., refer to the following table:

Thread.	Part No.	Weight.		No. Outlets.
		Kg.	Lbs.	
Dropsa Standard BSP	626180	4,470	9.83	1-2
	627180	6,390	14.06	2-4
	628180	8,810	19.39	3-6
NPTF	629180	10,880	23.94	4-8
	626140	4,470	9.83	1-2
	627140	6,390	14.06	2-4
	628140	8,810	19.39	3-6
	629140	10,880	23.94	4-8

### INSTALLATION/OPERATION:

Function: (Refer to Figs. 1 and 3.) The feeder discharge is controlled by a servo-piston (A) and metering piston (B) and can be arranged to provide a single or double outlet. Fig. D-E = 2 separate outlets Fig. F-G = 1 outlet. Feeders are normally supplied with double outlets unless otherwise specified. Retrospective conversion can be undertaken by fitting adaptor Y (Part No. 626210) for single outlet and X (Part No. 626209) for double outlet (see following page). When single outlet feeders are used the discharge per complete cycle = 24 cc./stroke (1.464 cu. in./stroke.)

**Dimensions:** (Refer to Fig. 2.)

**Mounting:** (Refer to Fig. 2.)



Aluminium bushings (Part No. 3008107) are supplied for mounting on uneven surfaces to prevent distortion or damage due to overtightening

### FUNCTION

#### 2 OUTLETS

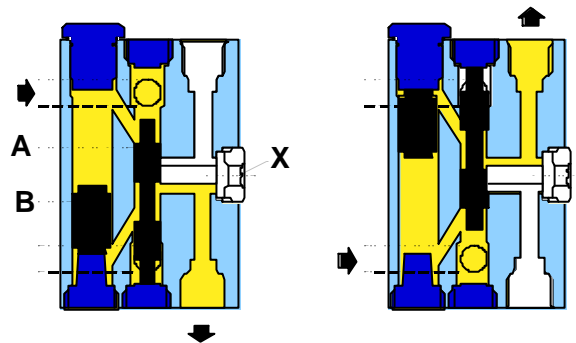

FIG. D.

FIG. E.

#### 1 OUTLET

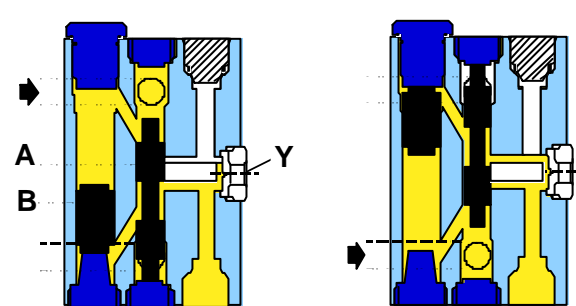
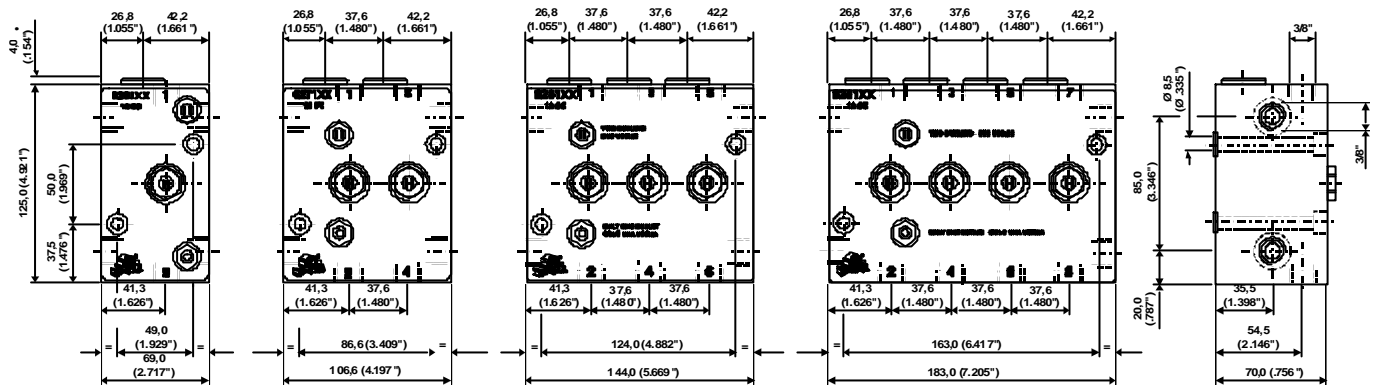

FIG. F.

FIG. G.



Dropsa Standard feeder blocks are normally supplied with outlets having a conical seating for Ø10 mm. (3/8") tube.  
This is simple and cost effective as no fitting is required.

If required a check-valve Part No. 92326 BSP or Part No. 92359 NPTF can be fitted at the outlet. Order separately.

3/8" BSP  
3/8" NPTF

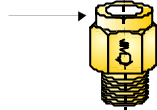

DROPSA STANDARD Ø mm.			
Cone	Bush	Ø Tube	Plug
93010	92010	Ø 10	91003

INLET 3/8"

OUTLET 3/8"

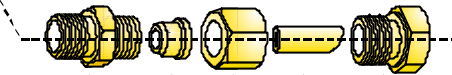
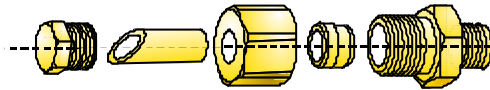

DROPSA STANDARD DIN 3852 BSP Ø mm.				
Plug	Tube Ø	Nut	Ring	Fitting
926002	Ø 10	91406	91601	92269
	Ø 12	91411	91607	92240
850282	Ø 3/8	850202	850222	850255
	Ø 1/2	850203	850223	850257
	Ø 5/8	850204	850224	850259

DIN 3852 BSP Ø mm				
Fitting	Ring	Nut	Ø Tube	Plug
91706	91596	91402	Ø 8	3234020
91972	91601	91406	Ø 10	
91974	91607	91411	Ø 12	

NPTF DRY SEAL Ø INCHES				
Fitting	Ring	Nut	Ø Tube	Plug
850253	850221	850201	Ø 5/16	850282
850255	850222	850202	Ø 3/8	
850257	850223	850203	Ø 1/2	

\*The double outlet adaptor (626209) is identifiable by two parallel line markings in the center; the single outlet adaptor (626210) has a circular marking only.

The fixing parts which are indicated thus \* are to be ordered separately.

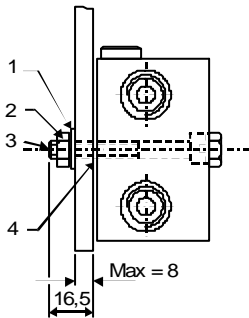

Pos.	Part No.	Qty.	Description	
1	16012	2	Spring washer	Metric
2	16406	2	Nut M8 - Hex	
3	12556	2	Screw M8 x 60	
4	3008107	2	Bushing	
1	16012	2	Spring washer	Inch
2	16500	2	Nut 5/16-24 UNF	
3	12560	2	Screw 5/16-24 UNF x 3-1/4	
4	3008107	2	Bushing	

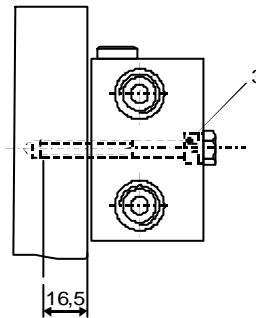

WELD PLATES FOR FEEDERS

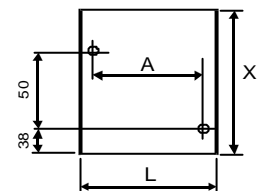

Pos.	Part No.	Dimensions (inches)		
		A	L	X
1	111576	49 (1.929")	70 (2.755")	190 (7.480")
2	111577	86 (3.385")	110 (4.330")	190 (7.480")
3	111578	124 (4.881")	150 (5.905")	190 (7.480")
4	111579	163 (6.417")	183 (7.204")	190 (7.480")

**U.K.**  
Dropsa (UK) Ltd.  
Unit 6, Egham Business Village,  
Egham,  
Surrey. TW20 8RB  
Tel: (+44) 01784 - 431177  
Fax: (+44) 01784 - 438598  
E-mail: salesuk@dropsa.com

**U.S.A.**  
Dropsa USA Inc.  
50679 Wing Drive  
Utica,  
Michigan 48315,  
Tel: (+1) 810-566-1540  
Fax: (+1) 810-566-1541  
E-mail: salesusa@dropsa.com

**AUSTRALIA**  
Dropsa Australia Pty.  
No. 7 Warringah Road  
Dee Why  
NSW 2099  
Tel: (+61) 2 9905 0410  
Fax: (+61) 2 99394142  
E-mail: sales@dropsa.com

**GERMANY**  
Dropsa GmbH.  
Volmerswerther Strasse 80  
40221 Dusseldorf 1,  
Deutschland  
Tel: (+49) 0211-394-011  
Fax: (+49) 0211-394-013  
E-mail: sales@dropsa.de

**ITALY**  
Dropsa Spa  
Via B. Croce, 1 - 20090  
Vimodrone (MI)  
Tel: (+39) 02 - 250.79.1  
Fax: (+39) 02 - 250.79.767  
E-mail: sales@dropsa.it (Export)  
E-mail: vendite@dropsa.it (National)

© Copyright Dropsa - all rights reserved. Reproduction of any part of this document is strictly forbidden without prior consent from Dropsa. Dropsa reserves the right to modify specifications without prior notice.

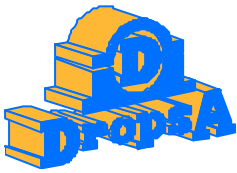

# FEEDER BLOCK SERIES AGG2

Adjustable Discharge 3-27 cc. per /stroke  
 (.183-1.65 cu.in./stroke) Dual Line System

638200  
 638140

ENGLISH

## PRODUCT DATA SHEET

### DESCRIPTION:

The feeder body is made of special anti-friction steel. Pistons are made of tempered steel. Bores and pistons are lapped to provide superior sealing. The indicator turrets are provided with integral adjusting screws together with a metacrylate cover and seal. On request an aluminium cover can be supplied. The feeder body has a galvanized finish and features an adaptor for single or double outlet conversion.

### SPECIFICATION:

- Temperature range:** -30 - +80°C.
- Max. pressure (inlet):** 400 bar (5800 psi.)
- Cycles:** 100/min.
- Min. Viscosity:** 15 cSt (77 SSU)
- Grease Max.:** 220 ASTM (NLGI 3)
- Connections:**
  - Inlet:** 3/8"
  - Outlet:** 3/8"

In installations where backpressure is detected at the outlets of the feeder blocks, a checkvalve must be fitted to each outlet (See following page).

### ORDERING INFORMATION:

Ordering is by Part No., refer to the following table:

Thread.	Part No.	Weight.		No. Outlets.
		Kg.	Lbs.	
Dropsa Standard	<b>638200</b>	5,10	11.24	1-2
NPTF	<b>638140</b>	5,10	11.24	1-2

### INSTALLATION/OPERATION:

**Function: (Refer to Figs. 1 and 3.)**

The feeder discharge is controlled by a servo-piston (A) and metering piston (B) and can be arranged to provide a single or double outlet. Fig. D-E= 2 separate outlets Fig. F-G=1 outlet. Feeders are normally supplied with double outlets unless otherwise specified. Retrospective conversion can be undertaken by fitting adaptor Y (Part No.626210) for single outlet and X (Part No.626209) for double outlet (see following page). When single outlet feeders are used the discharge per complete cycle =6 - 54 cc./stroke(.37 - 3.29 cu.in./stroke).



**Dimensions: (Refer to Fig. 2.)**  
**Mounting: (Refer to Fig. 2.)**

Aluminium bushings (Part. No. 3008107) are supplied for mounting on uneven surfaces to prevent distortion or damage due to overtightening.

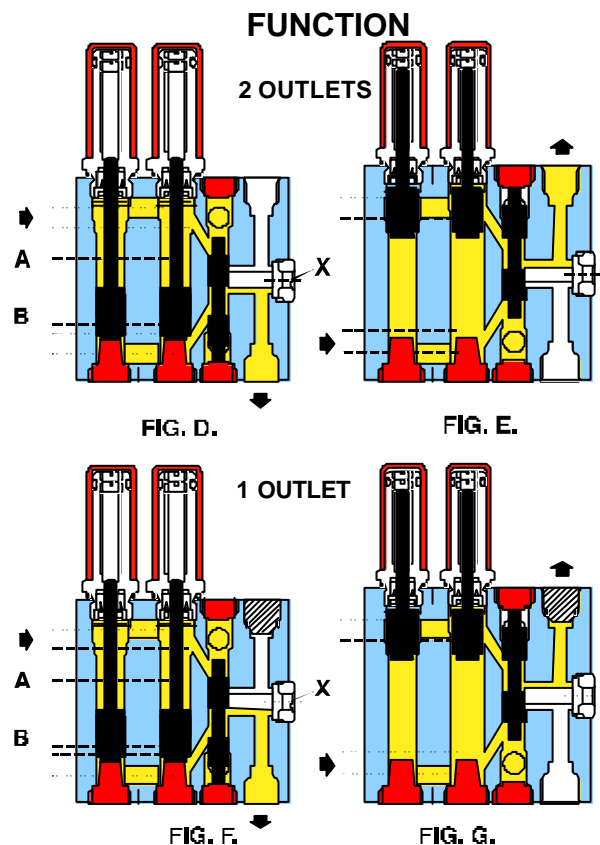



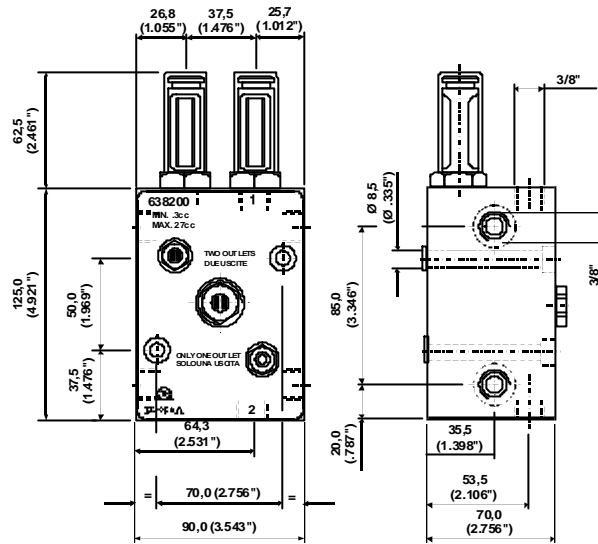

Aluminium cover  
**Part No. 626021**  
 Metacrylate cover  
**Part No. 3042118**  
 Seal  
**Part No. 19119**

Dropsa Standard feeder blocks are normally supplied with outlets having a conical seating for Ø10 mm. (3/8") tube. This is simple and cost effective as no fitting is required.

If required a check-valve **Part No. 92326** BSP or **Part No. 92359** NPTF can be fitted at the outlet. Order separately.

3/8" BSP

3/8" NPTF

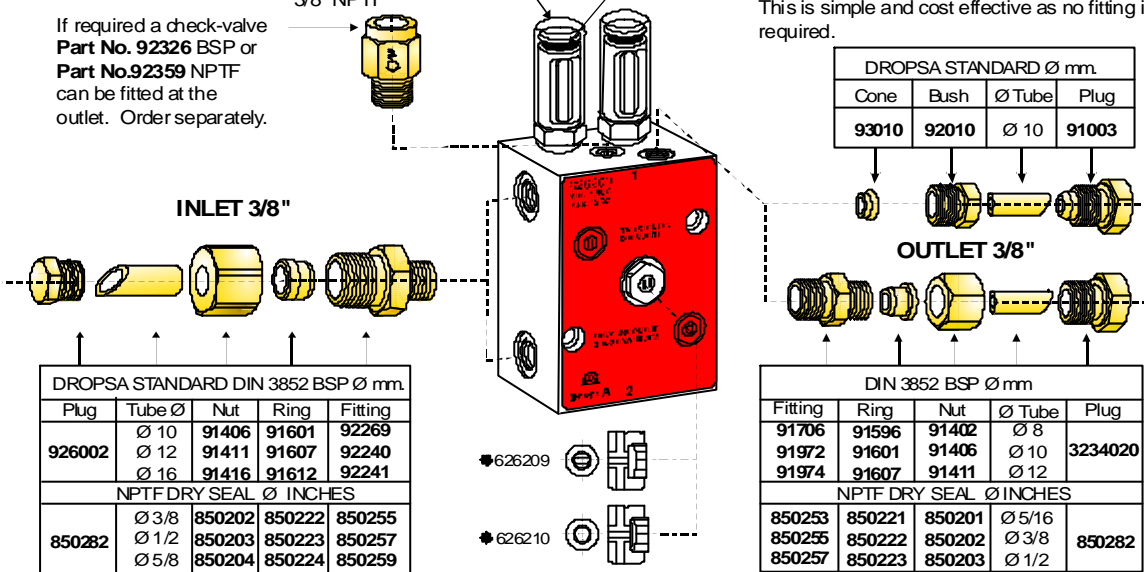

\*The double outlet adaptor (**626209**) is identifiable by two parallel line markings in the centre; the single outlet adaptor (**626210**) has a circular marking only.

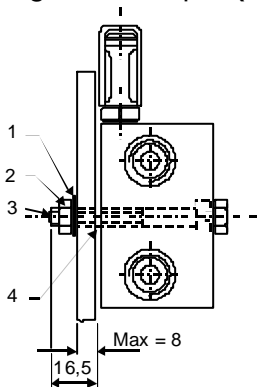

The fixing parts which are indicated thus \* are to be ordered separately.

Pos.	Part No.	Qty.	Description
*1	16012	2	Spring washer
*2	16406	2	Nut M8 - Hex 13
*3	12556	2	Screw M8 x 80
4	3008107	2	Bushing
*1	16012	2	Spring washer
*2	16500	2	Nut 5/16-24 UNF x 3-1/4
*3	12560	2	Screw 5/16-24 UNF Hex-1/2
4	3008107	2	Bushing

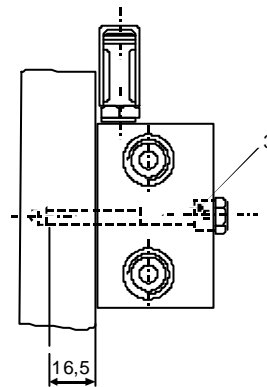

**U.K.**  
 Dropsa (UK) Ltd.  
 Unit 6, Egham Business Village,  
 Egham,  
 Surrey, TW20 8RB  
 Tel: (+44) 01784 - 431177  
 Fax: (+44) 01784 - 438598  
 E-mail: salesuk@dropsa.com

**U.S.A.**  
 Dropsa USA Inc.  
 50679 Wing Drive  
 Utica,  
 Michigan 48315,  
 Tel: (+1) 810-566-1540  
 Fax: (+1) 810-566-1541  
 E-mail: salesusa@dropsa.com

**AUSTRALIA**  
 Dropsa Australia Pty.  
 No. 7 Warringah Road  
 Dee Why  
 NSW 2099  
 Tel: (+61) 2 9905 0410  
 Fax: (+61) 2 99394142  
 E-mail: sales@dropsa.com

**GERMANY**  
 Dropsa GmbH.  
 Volmerswerther Strasse 80  
 40221 Dusseldorf 1,  
 Deutschland  
 Tel: (+49) 0211-394-011  
 Fax: (+49) 0211-394-013  
 E-mail: sales@dropsa.de

**ITALY**  
 Dropsa Spa  
 Via B. Croce, 1 - 20090  
 Vimodrone (MI)  
 Tel: (+39) 02 - 250.79.1  
 Fax: (+39) 02 - 250.79.767  
 E-mail: sales@dropsa.it (Export)  
 E-mail: vendite@dropsa.it (National)

© Copyright Dropsa - all rights reserved. Reproduction of any part of this document is strictly forbidden without prior consent from Dropsa. Dropsa reserves the right to modify specifications without prior notice.





# DOUBLE CONTROL METERING VALVES

For Dual Line Lubrication Systems

622200 623200  
624200 625200  
622260 623260  
624260 625260

## PRODUCT DATA SHEET

ENGLISH

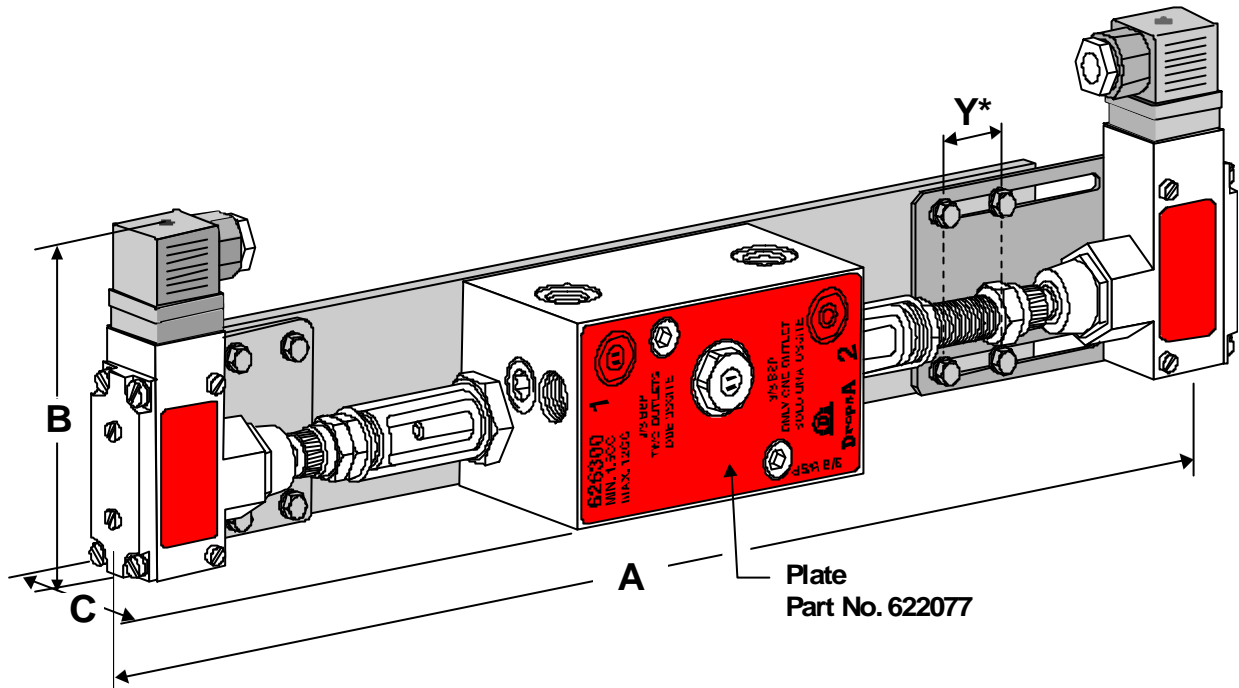

### DESCRIPTION:

These units are used especially on heavy machinery. The user can install the valves as required, please note, that the non enclosed version must be mounted in a relatively clean area of the machine. Away from water and dust. The operation of the system becomes extremely reliable and easily controllable by means of these valves. The delivery of the metering valve **Part No. 622300** and **Part No. 671350** can be adjusted varying the length of Y (see the figure) screwing or

unscrewing the regulating nut. The valve can be used either single or double outlet; double outlet is the standard adjustment, to obtain a single outlet valve replace plate **Part No. 622077** (marked with two parallel lines) with plate **Part No. 622076** (marked with a circle) and plug one of the two outlets.

These metering valves are a double controlled version of some of the most commonly used Dual Line metering

### SPECIFICATION:

Part No.	Number of outlet	Delivery per outlet		A		B		C	
		cc.	cu.in.	mm.	In.	mm.	In.	mm.	In.
<b>622300</b>	2	.25 -1.5	.015 -.091	350	13.780	80	3.150	70	2.756
<b>671350</b>	2	.25 - 3	.015 -.183	400	15.748	80	3.150	70	2.756
<b>626300</b>	2	12	.732	500	19.685	80	3.150	85	3.346

Type	Code	Adjustment								Delivery variation for each adjustment of Y	
		A max				A min					
		mm.	in.	cc.	cu. in.	mm.	in.	cc.	cu in.	cc.	cu.in.
AP6	<b>622300</b>	20.5	.807	1.5	.091	8.5	.335	,5	.030	,17	.010
AG6	<b>671350</b>	21	.827	3	.183	0	0	,5	.030	,17	.010
AGG6	<b>626300</b>	40	1.575	12	.732	0	0	1,5	.091	,6	.037

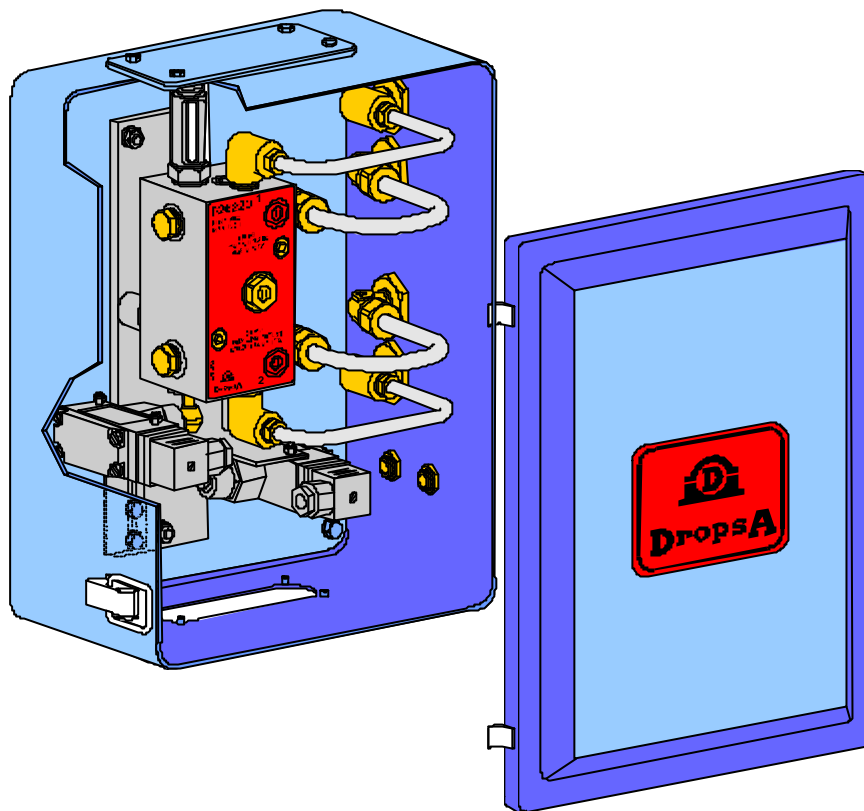

valves. They can be used when a very accurate control of the operation of the metering valves is required. Each turret on the valve is connected to a microswitch that gives a signal to electric equipment when the valve is

operated. The electric equipment controls the operation of one or more valves and gives an alarm signal if the microswitch does not give any signal within a fixed time.

### ORDERING INFORMATION:

Ordering is by Part Number. Refer to the following table.

Part No.	Number of outlets	Delivery per outlet		A		B		C	
		cc.	Cu.in.	mm.	in.	mm.	in.	mm.	in.
<b>626220</b>	2	12	.732	295	11.614	352	13.858	185	7.283

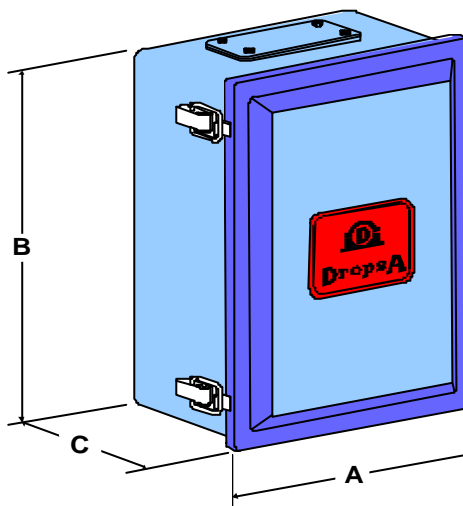

**U.K.**  
DropSA (UK) Ltd.  
Unit 6, Egham Business Village,  
Egham,  
Surrey, TW20 8RB  
Tel: (+44) 01784 - 431177  
Fax: (+44) 01784 - 438598  
E-mail: salesuk@dropSA.com

**U.S.A.**  
DropSA USA Inc.  
50679 Wing Drive  
Utica,  
Michigan 48315,  
Tel: (+1) 810-566-1540  
Fax: (+1) 810-566-1541  
E-mail: salesusa@dropSA.com

**AUSTRALIA**  
DropSA Australia Pty.  
No. 7 Warringah Road  
Dee Why  
NSW 2099  
Tel: (+61) 2 9905 0410  
Fax: (+61) 2 99394142  
E-mail: sales@dropSA.com

**GERMANY**  
DropSA GmbH.  
Volmerswerther Strasse 80  
40221 Dusseldorf 1,  
Deutschland  
Tel: (+49) 0211-394-011  
Fax: (+49) 0211-394-013  
E-mail: sales@dropSA.de

**ITALY**  
DropSA Spa  
Via B. Croce, 1 - 20090  
Vimodrone (MI)  
Tel: (+39) 02 - 250.79.1  
Fax: (+39) 02 - 250.79.767  
E-mail: sales@dropSA.it (Export)  
E-mail: vendite@dropSA.it (National)

© Copyright DropSA - all rights reserved. Reproduction of any part of this document is strictly forbidden without prior consent from DropSA. DropSA reserves the right to modify specifications without prior notice.



# MODULAR DUAL LINE

## Dual Line Lubrication Divider Valves Series 02

Series  
02

ENGLISH

### PRODUCT DATA SHEET

#### DESCRIPTION:

The modular dual line system consists of two main parts; the Base and the Metering Valves.

Bases and Metering Valves are made in stainless steel AISI 316 or in zinc plated steel and are available with inlets and outlets in UNI-ISO 7/1 (BSP) or NPTF threads.

The Metering Valves can be supplied with adjustable or fixed discharge. The Valves with adjustable discharge are fitted with turrets provided with integral adjusting screws together with a metacrylate cover and seal.

A blanking plate to be ordered separately, can be provided on the Base to accommodate future additional points.

**The advantages of the Modular Dual Line System are:**

- **Versatility in lubrication layout planning.**
- **Flexibility to expand or reduce the number of elements to meet changing requirements.**
- **Reduced spare parts, fewer parts in stock = lower inventory costs.**
- **Blanking plates can be provided to accommodate future requirements.**
- **Save on labour and piping costs; the Metering Valves can be serviced without disturbing the assembly or existing pipework.**
- **Lower maintenance costs; the modular concept provides lower cost replacement components.**



#### SPECIFICATION:

<b>Temperature range:</b>	-30°C to +80°C
<b>Frequency:</b>	100 cycles/minute.
<b>Max. pressure (inlet):</b>	400 bar
<b>Lubricant:</b>	
Oil:	15 cSt to 1000 cSt.
Grease:	NLGI 00 to NLGI 3.
<b>Base threads:</b>	
Inlets:	3/8" BSP or 3/8" NPTF.
Outlets:	1/4" BSP or 1/4" NPTF.

#### INSTALLATION/OPERATION:

##### The Base:

A modular base is made up of a minimum of three elements: inlet; intermediate and end.

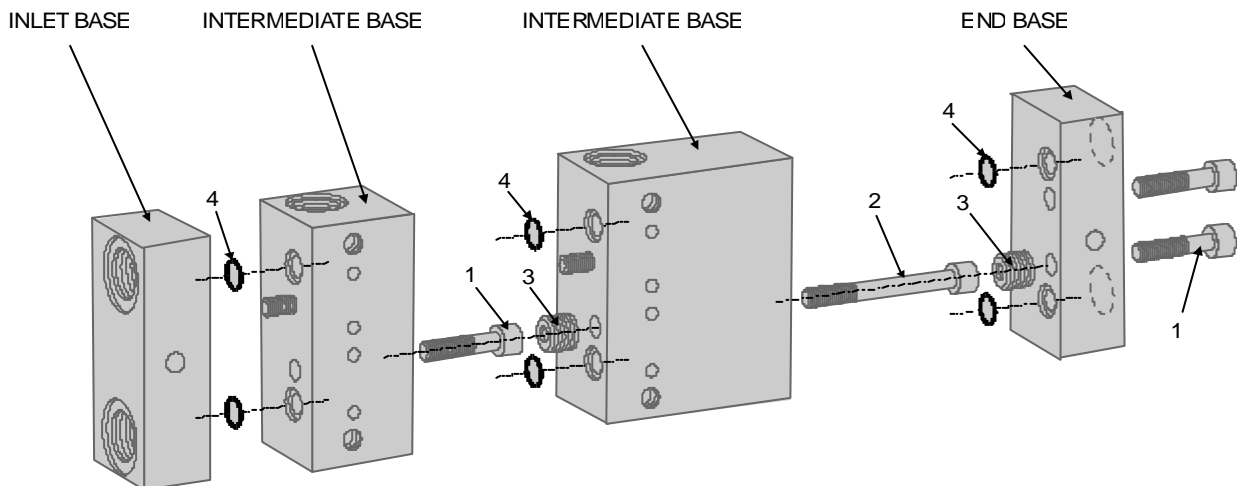



### Turret cover:

Turret cover.	
Part No.	Mark
622207	DMM
622210	DMMX
671028	DM-DMX
675524	DMG-DMGX
675525	DMG1-DMGX1 DMG2-DMGX2

Base for valves	Value
DMM-DM-DMMF-DMF-DMMX- DMMXF-DMX-DMXF	34,7 mm. (1.366 in.)
DMG-DMGF-DMG1-DMGF1- DMG2-DMGF2-DMGX-DMGF- DMGX1-DMGX1-DMGX2- DMGX2	69,4 mm. (2.732 in.)

### Dimensions:

(Values in parenthesis are for fixed discharge).

Dimension 'A' is obtained by adding to the dimensions of the Base Inlet and Base End 43,8 mm. (1.725") the following values for each Intermediate Base

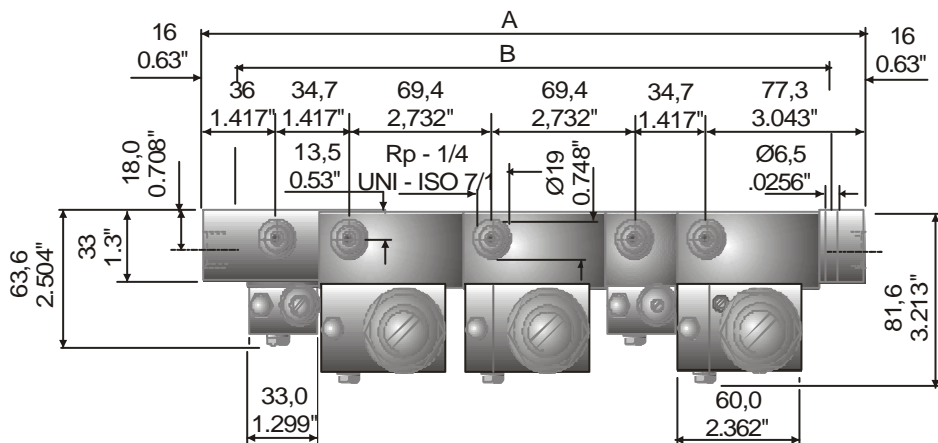
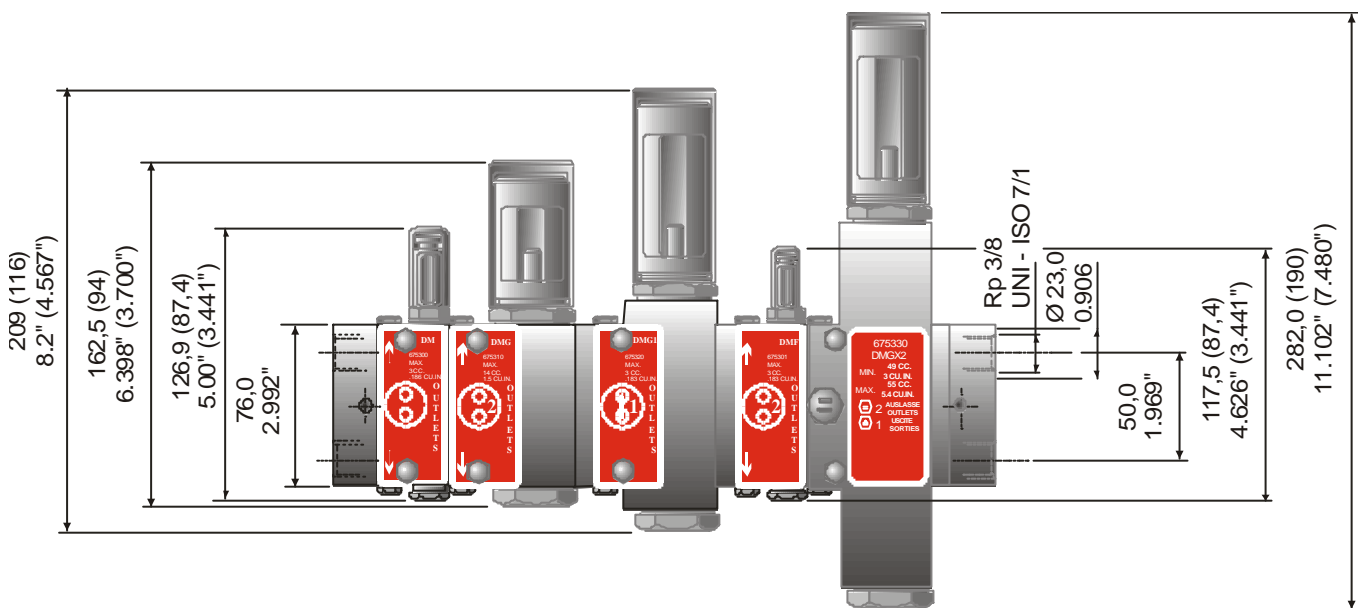

**Spares:**

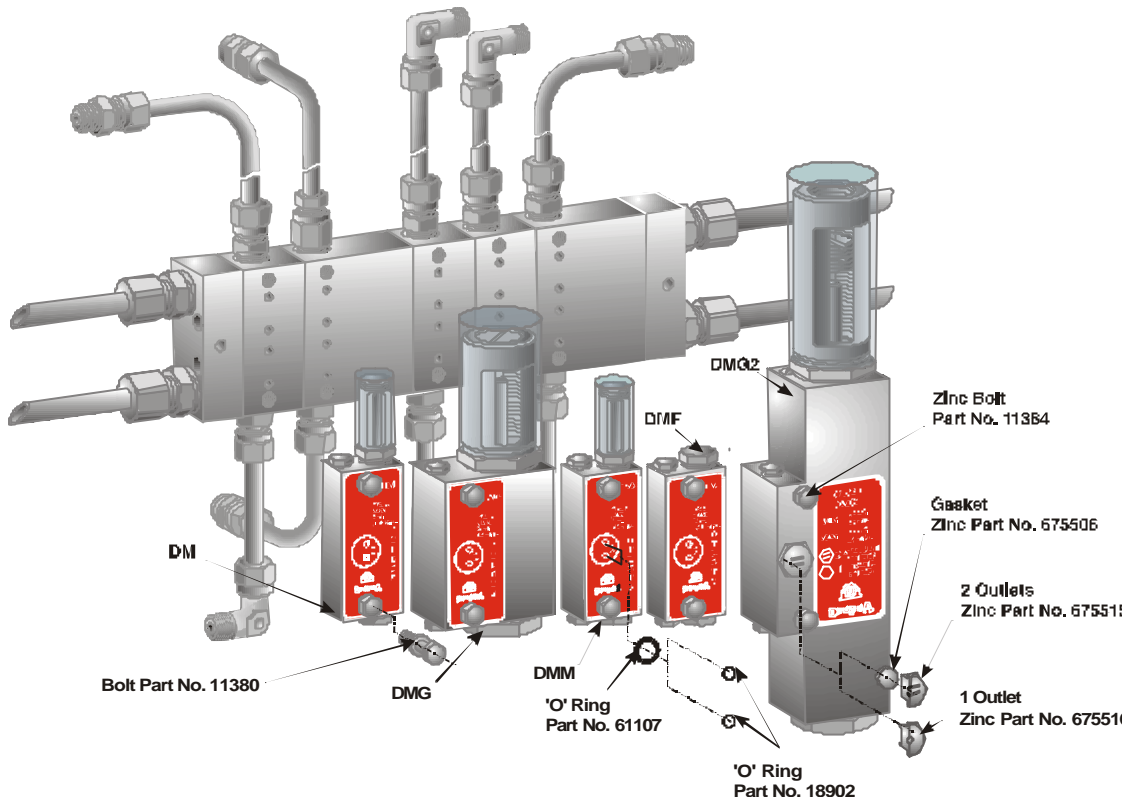

**ORDERING INFORMATION:**

Refer to the following ordering menu:

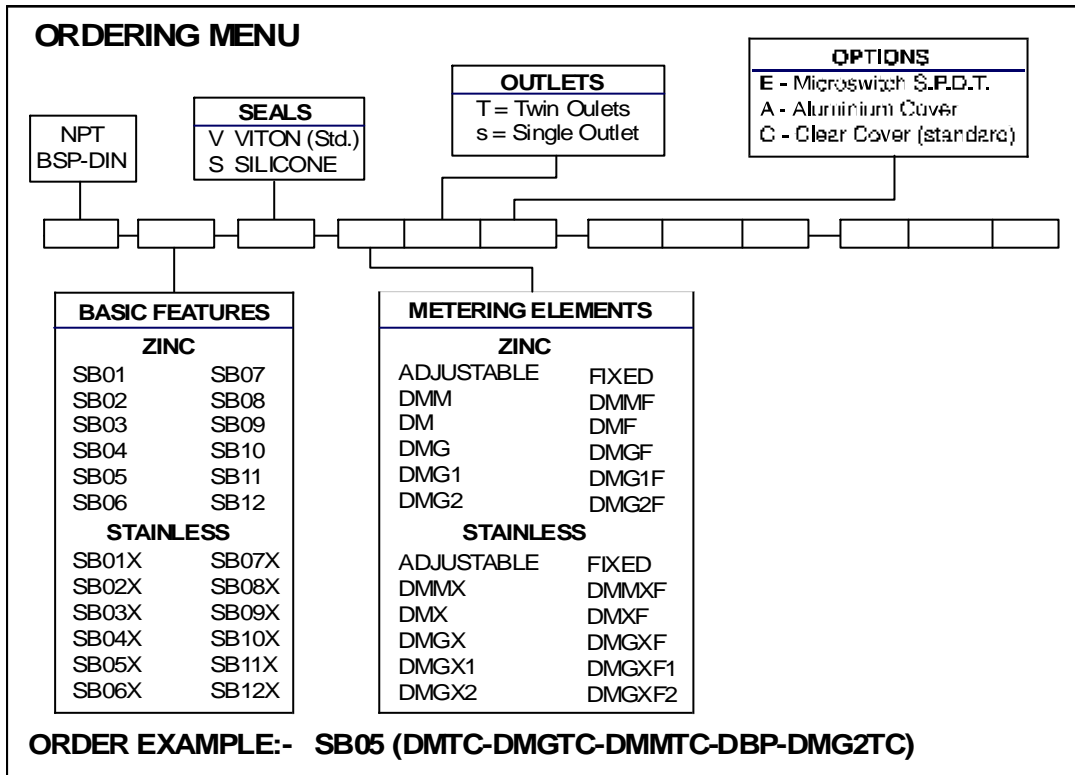

**U.K.**  
Dropsa (UK) Ltd.  
Unit 6, Egham Business Village,  
Egham,  
Surrey, TW20 8RB  
Tel: (+44) 01784 - 431177  
Fax: (+44) 01784 - 438598  
E-mail: salesuk@dropsa.com

**U.S.A.**  
Dropsa USA Inc.  
50679 Wing Drive  
Utica,  
Michigan 48315,  
Tel: (+1) 810-566-1540  
Fax: (+1) 810-566-1541  
E-mail: salesusa@dropsa.com

**AUSTRALIA**  
Dropsa Australia Pty.  
No. 7 Warringah Road  
Dee Why  
NSW 2099  
Tel: (+61) 2 9905 0410  
Fax: (+61) 2 99394142  
E-mail: sales@dropsa.com

**GERMANY**  
Dropsa GmbH.  
Volmerswerther Strasse 80  
40221 Dusseldorf 1,  
Deutschland  
Tel: (+49) 0211-394-011  
Fax: (+49) 0211-394-013  
E-mail: sales@dropsa.de

**ITALY**  
Dropsa Spa  
Via B. Croce, 1 - 20090  
Vimodrone (MI)  
Tel: (+39) 02 - 250.79.1  
Fax: (+39) 02 - 250.79.767  
E-mail: sales@dropsa.it (Export)  
E-mail: vendite@dropsa.it (National)

© Copyright Dropsa - all rights reserved. Reproduction of any part of this document is strictly forbidden without prior consent from Dropsa. Dropsa reserves the right to modify specifications without prior notice.



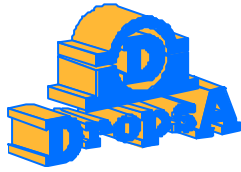

# 777000 SERIES MOTORIZED PUMPS

For Oil or Grease  
Dual Line System.

777005 777271 777572  
777060 777304 777207  
777010 777311 777521  
777040 777510 777083  
777020 777560 777273  
777535 777584

ENGLISH

## PRODUCT DATA SHEET

### DESCRIPTION:

Suitable for Oil or Grease. Maximum pressure 500 Bar ((7250 psi.). The Dropsa 777000 series modular motorized pump is suitable for a wide range of applications. Once installed it is a simple operation to adjust the pressure and adjust lubricant output (using a flow control) **Part No. 3293060.**

The assembly consists of:

Motor and reduction unit.

Pump.

Reservoir.

Valves and delivery unit.

Pressure gauge.

Charging filter.

A trolley mounted version is also available. The modular construction of the pump assembly uses common components throughout the range and therefore reduces spares holding.

The double pump body has two outlets which can either be combined together for one outlet or feed to two independent systems.

In the case of a Dual Line System the two pump outlets would operate an inverter.

Access to the pump is simple through the reservoir lid or through the covers surrounding the pump and reduction unit.

Re-filling of the reservoir is recommended through the charging filter to eliminate any ingress of contaminants. The frequency of operation can be monitored with Dropsa Control Panels or through the machines P.C.

### SPECIFICATION:

**Lubricant:** Oil or Grease.  
**Adjustable delivery:** from 65 to 130 cc/min. (4 to 8 cu.in./min.) with 1500 r.p.m. 4

**Maximum pressure:** 500 bar (7100 psi.).  
**Viscosity:** Oil min. 100 cSt.  
Grease max. 220 ASTM (NLGI 3).

**Pump:** Double body type 4 pistons.  
**Delivery line;** Single or double.  
**Reservoir capacity:** 10, 30 & 100Kg. (22, 66 & 220 lb.)

**Three phase motor:** 220/380V 50/60Hz. 4 poles. 1500 r.p.m. 0.37kW up to 0°C. (32°F), 0.75kW up to -30°C. (-86°F.) Specify voltage and frequency when ordering.

**Protection:** IP44.  
**Reduction unit:** 1:1.5 ratio.  
**Temperature range:** from -30°C. (-22°F.) to +80°C. (+176°F.).



### ORDERING INFORMATION:

Ordering is by Part No. Please refer to the following table:

Reservoir Kg.	Grease			For oil with minimum and maximum level	Pump weight Kg.	
	With impeller unit for hard grease.	2	With pressure plate for soft grease.		Oil	Grease
10	777005 777060	-	777304 777311	777510 777560	31,5	35
30	777010 777040	777207 777273	-	777521 777572	35	40
100	777020 777083	777271 -	-	777535 777584	42,5	50

- Motor 0,37 kW.
- Motor 0,75 kW.

# INSTALLATION/OPERATION:

# Hydraulic diagrams:

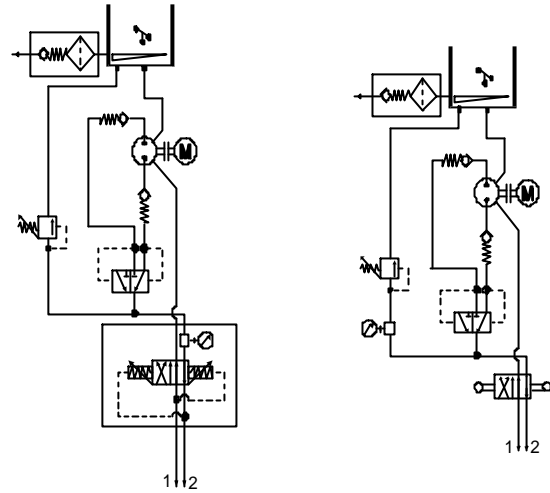
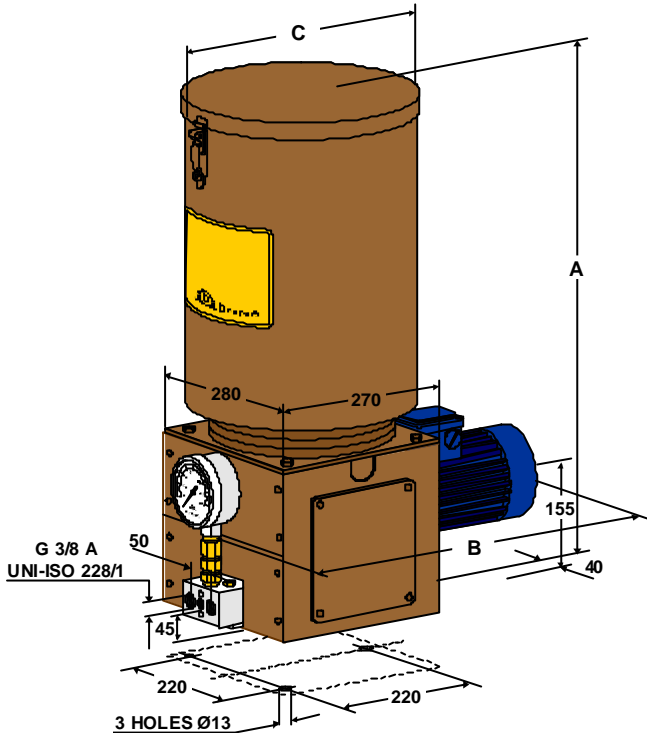

WITH HYDRAULIC REVERSER

WITH MECHANICAL REVERSER

Reservoir Kg.	Dimensions mm.		
	A	B	C
10	580	520	262
30	760	520	320
100	985	520	451

## MOBILE VERSION WITH TROLLEY, HOSES, QUICK COUPLINGS AND SHUT-OFF VALVES:

The pump has a standard kit identical to the other version Plus hoses, quick copulings and shut-off valves.

## OVERALL DIMENSIONS:

Height: 1017 mm.  
 Width: 475 mm.  
 Depth: 730 mm.

Equipped with hose 12m long (complete with safety pin)

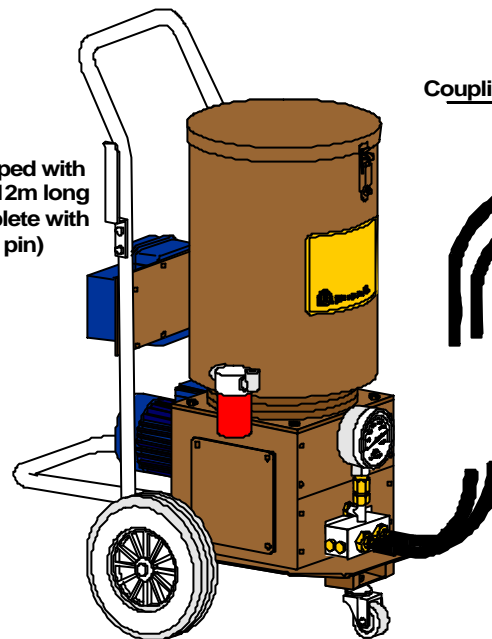

Motor	No. of poles/RPM	Part No. with reservoir.		Pressure Bar (Mpa)	Delivery Cm <sup>3</sup> /min.
		10Kg. (10daN)	30Kg. (30 daN)		
Three phase 220/380 V 50Hz.	4	<b>777950</b>	<b>777951</b>	400 (40)	130
Three phase 220/380 V 50Hz.	2	<b>777952</b>	<b>777953</b>	200 (20)	260
Single phase 220 V 50Hz.	3000 rpm.	<b>777954</b>	<b>777955</b>	200 (20)	200

**U.K.**  
 Dropsa (UK) Ltd.  
 Unit 6, Egham Business Village,  
 Egham,  
 Surrey. TW20 8RB  
 Tel: (+44) 01784 - 431177  
 Fax: (+44) 01784 - 438598  
 E-mail: salesuk@dropsa.com

**U.S.A.**  
 Dropsa USA Inc.  
 50679 Wing Drive  
 Utica,  
 Michigan 48315,  
 Tel: (+1) 810-566-1540  
 Fax: (+1) 810-566-1541  
 E-mail: salesusa@dropsa.com

**AUSTRALIA**  
 Dropsa Australia Pty.  
 No. 7 Warringah Road  
 Dee Why  
 NSW 2099  
 Tel: (+61) 2 9905 0410  
 Fax: (+61) 2 99394142  
 E-mail: sales@dropsa.com

**GERMANY**  
 Dropsa GmbH.  
 Volmerswerther Strasse 80  
 40221 Dusseldorf 1,  
 Deutschland  
 Tel: (+49) 0211-394-011  
 Fax: (+49) 0211-394-013  
 E-mail: sales@dropsa.de

**ITALY**  
 Dropsa Spa  
 Via B. Croce, 1 - 20090  
 Vimodrone (MI)  
 Tel: (+39) 02 - 250.79.1  
 Fax: (+39) 02 - 250.79.767  
 E-mail: sales@dropsa.it (Export)  
 E-mail: vendite@dropsa.it (National)

© Copyright Dropsa - all rights reserved. Reproduction of any part of this document is strictly forbidden without prior consent from Dropsa. Dropsa reserves the right to modify specifications without prior notice.



# TROLLEY MOUNTED MOTOR DRIVEN PUMP 777000

For Grease with Continuous or Intermittent Flow Gun

777950 777951  
777952 777953  
777954 777955

ENGLISH

## PRODUCT DATA SHEET

### DESCRIPTION:

Mobile lubrication unit, delivers 130 cc. (.28 lb.) of lubricant per minute with a back pressure of 400 bar (5700 psi.), or 260 cc. (.57 lb.) at 200 bar (2850 psi.). The piston pump has a double pumping impeller and is available with 4 or 2 pole three-phase AC or single-phase DC brush motor. The pump is supplied with a filter located under the impeller to prevent entry of foreign bodies into the suction chamber. When removed from the trolley it becomes a fixed lubrication unit for the most various applications.

The unit is complete with:

Impeller suitable for the suction of greases with a low penetration index.

Double body pump.

Motor with geared unit.

Pressure regulating valve.

Pressure switch, stops the motor when the maximum pressure is reached in the line; on operating the gun the motor restarts.

2000 mm. (78 in.) long hose Part No. 2513005 – Part No. 2513021 (length to be specified when ordering).

Continuous or intermittent flow gun.

1000 mm. (390 in.) long electric cable with earthing socket.

320 mm. (12.5 in.) dia. Rubber wheels.

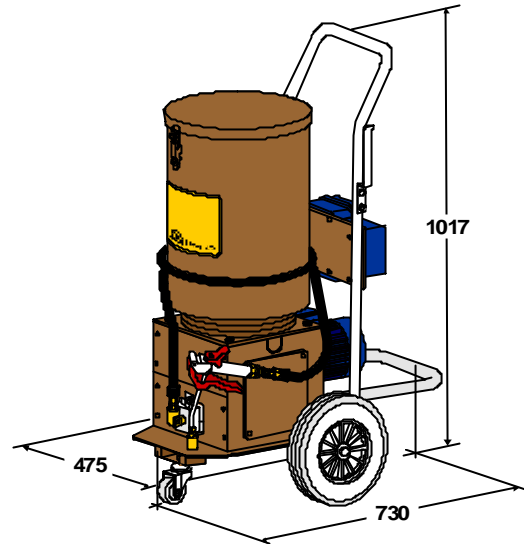

### SPECIFICATION:

**Lubricant:** Oil or Grease.  
**Adjustable delivery:** from 65 to 130 cc/min. (4 to 8 cu.in./min.) with 1500 r.p.m. 4 pole motor.  
**Maximum pressure:** 500 bar (7100 psi.).  
**Viscosity:** Oil min. 100 cSt.  
 Grease max. 220 ASTM (NLGI 3).  
**Pump:** Double body type 4 pistons.  
**Delivery line;** Single or double.  
**Reservoir capacity:** 10, 30 & 100Kg. (22, 66 & 220 lb.)  
**Three phase motor:** 220/380V 50/60Hz. 4 poles, 1500 r.p.m. 0.37kW up to 0°C. (32oF), 0.75kW up to -30°C. (-86° F.) Specify voltage and frequency when ordering.  
**Protection:** IP44.  
**Reduction unit:** 1:1.5 ratio.  
**Temperature range:** from -30° C. (-22° F.) to +80° C. (+176° F.).

### ORDERING INFORMATION:

Ordering is by Part No. please refer to the following table:

Motor	No. of poles/RPM	Part No. with reservoir.		Pressure Bar (Mpa)	Delivery Cm <sup>3</sup> /min.
		10Kg. (10daN)	30Kg. (30 daN)		
Three phase 220/380 V 50Hz.	4	<b>777950</b>	<b>777951</b>	400 (40)	130
Three phase 220/380 V 50Hz.	2	<b>777952</b>	<b>777953</b>	200 (20)	260
Single phase 220 V 50Hz.	3000 rpm.	<b>777954</b>	<b>777955</b>	200 (20)	200

Motors with different voltage, frequency and protection degree are to be specified when ordering along with CSA motor specs.

**INSTALLATION/OPERATION:  
HYDRAULIC DIAGRAM:**

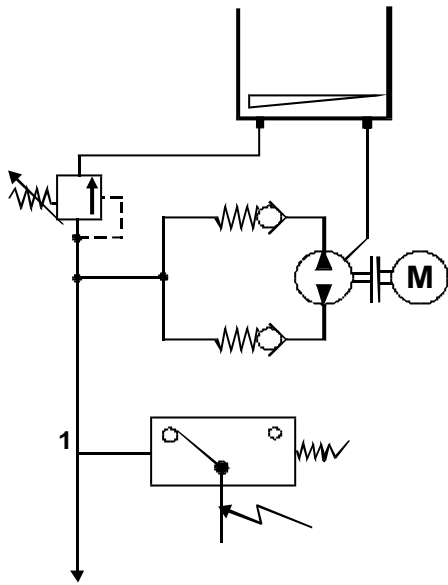

**Lubrication examples:**

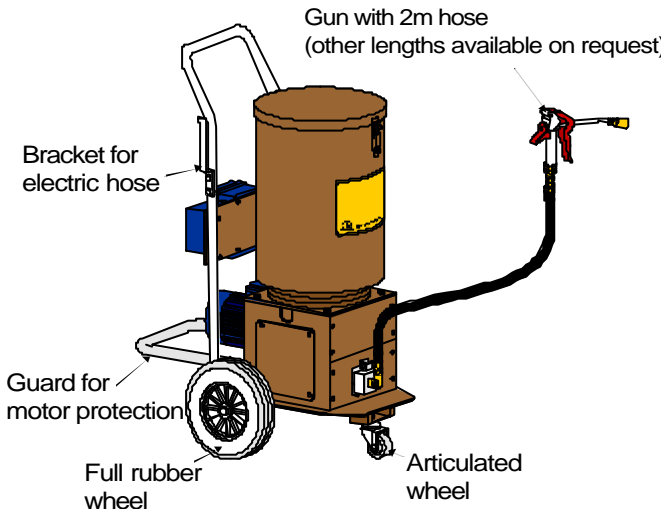

This type of lubrication unit represents the mobile version of the 777000 series grease electric pumps, whose features and versatility remain totally unchanged. Easy to use, this pump is particularly suitable for those applications requiring non-frequent lubrication cycles, thus allowing the use of a single mobile lubrication unit to feed separate installations or single lubrication points. Each unit is supplied with gun and hydraulic nipple and can be equipped on request with the accessories shown aside. It also has a pressure switch, which stops the motor when maximum pressure setting is reached.

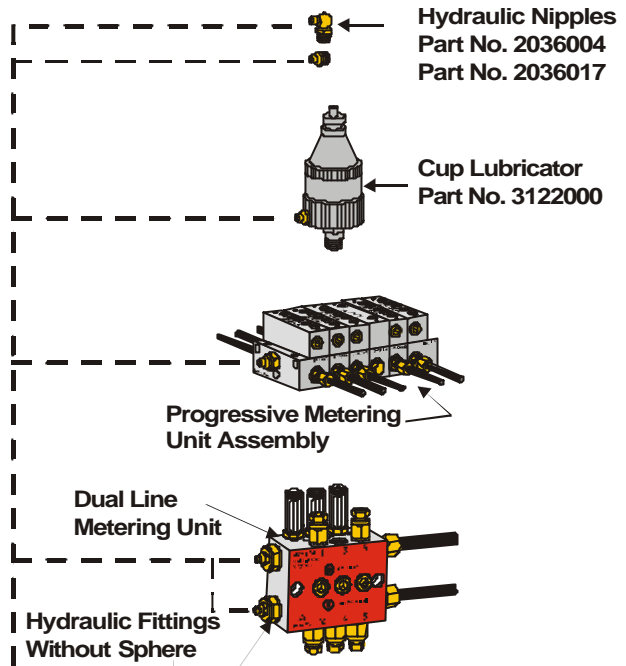

Spare parts with quick-coupling for gun connection to be ordered separately



Quick coupling (Part No. 2036400) with stiff extension cable and nipple.



Quick coupling (Part No. 2036401) with flexible extension cable and nipple.

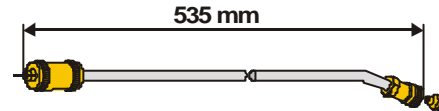

Quick coupling (Part No. 2036403) with stiff extension cable and nipple.

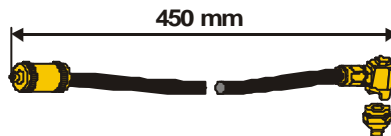

Quick coupling with hose and buttonhead connector:  
Standard: Part No. 2036521  
Giant: Part No. 2036522

For other types of installation please refer to catalogue 07

**U.K.**  
Dropsa (UK) Ltd.  
Unit 6, Egham Business Village,  
Egham,  
Surrey. TW20 8RB  
Tel: (+44) 01784 - 431177  
Fax: (+44) 01784 - 438598  
E-mail: salesuk@dropsa.com

**U.S.A.**  
Dropsa USA Inc.  
50679 Wing Drive  
Utica,  
Michigan 48315.  
Tel: (+1) 810-566-1540  
Fax: (+1) 810-566-1541  
E-mail: salesusa@dropsa.com

**AUSTRALIA**  
Dropsa Australia Pty.  
No. 7 Warringah Road  
Dee Why  
NSW 2099  
Tel: (+61) 2 9905 0410  
Fax: (+61) 2 99394142  
E-mail: sales@dropsa.com

**GERMANY**  
Dropsa GmbH.  
Volmerswerther Strasse 80  
40221 Dusseldorf 1,  
Deutschland  
Tel: (+49) 0211-394-011  
Fax: (+49) 0211-394-013  
E-mail: sales@dropsa.de

**ITALY**  
Dropsa Spa  
Via B. Croce, 1 - 20090  
Vimodrone (MI)  
Tel: (+39) 02 - 250.79.1  
Fax: (+39) 02 - 250.79.767  
E-mail: sales@dropsa.it (Export)  
E-mail: vendite@dropsa.it (National)

© Copyright Dropsa - all rights reserved. Reproduction of any part of this document is strictly forbidden without prior consent from Dropsa. Dropsa reserves the right to modify specifications without prior notice.



# MODULAR MOTOR DRIVEN PUMPS 999000 SERIES

For Oil or Grease.

999000

ENGLISH

## PRODUCT DATA SHEET

### DESCRIPTION:

Modular pumps particularly suitable for the lubrication of small or medium size machinery. They are used for different types of oil and grease lubrication systems and in a very large range of applications because of their high quality, high performance and low cost.

The modular construction of 999 series pumps enables easy dismantling for maintenance, guarantees very high reliability and allows very fast adjustment of the units for different operating conditions.

### Basic modules:

Electric Motor.

Reduction Unit.

Single or Double Pumping Unit.

Reservoir.

Steel sheet reservoirs are equipped with low level indicator and electric contact. Reservoirs for oil are equipped with re-filling filter.



### ORDERING INFORMATION:

Type of motor and R.P.M.*	Adjustable delivery				Max. Press. bar (psi.)	Part No. of Motor Driven Pump 999000 Series Metal Reservoirs Capacity								Transparent Res. Capacity Grease Max NLGI 0	
	Cm <sup>3</sup> /min		Cu.in./min.			Grease Max. NLGI 3.				Oil Viscosity Min. 15 cSt					
	Min.	Max.	Min.	Max.		3Kg. 6.6lbs.	5Kg. 11lb.	10Kg. 22lb.	30Kg. 66lb.	3 Lt.	5 Lt.	10 Lt.	30 Lt.		
A.C. 1500 R.P.M.	1,4	8,5	,08	,6	750 (11000)	999234	999214	999224	999204	999244	999264	999274	999254	999414	999424
	2,5	17	,15	1	400 (5800)	999236	999216	999226	999206	999246	999266	999276	999256	999416	999426
	5	33	,30	2	200 (2900)	999232	999212	999222	999202	999242	999262	999272	999252	999412	999428
D.C. 24V 2200 R.P.M.	2	14,5	,12	,9	750 (11000)	999634	999614	999624	999604	999644	999664	999674	999654	999684	999694
	3,6	25,5	,22	1,5	400 (5800)	999636	999616	999626	999606	999646	999666	999676	999656	999686	999696
	7,2	51	,44	3	200 (2900)	999632	999612	999622	999602	999642	999662	999672	999652	999682	999698
A.C. 1500 R.P.M.	Fixed delivery														
	8,5		,6		750 (11000)	999334	999314	999324	999304	999344	999376	999374	999354	999514	999524
	17		1		400 (5800)	999336	999336	999326	999306	999346	999366	999364	999356	999516	999526
33		2		200 (2900)	999332	999312	999322	999302	999342	999362	999372	999352	999512	999522	
D.C. 24V 2200 R.P.M.	14,5		,9		750 (11000)	999734	999395	999724	999704	999744	999764	999774	999754	999784	999794
	25,5		1,5		400 (5800)	999736	999712	999726	999706	999746	999776	999776	999756	999786	999796
	51		3		200 (2900)	999732	999716	999722	999702	999742	999762	999772	999782	999782	999792
						Grease Max. NLGI 0				Oil Viscosity Min.				Grease Max NLGI 0	
D.C. 12V 2200 R.P.M.	14,5		,9		350 (5075)	999380	-	-	-	999390	-	-	-	999385	-

R.P.M.\* and lubricant deliveries indicated in the table refer to 50Hz. motors. With 60Hz. motors speeds and deliveries are increased by 20%.

**SPECIFICATION:**

**Operating pressure:** up 75Mpa  
(750 bar) (11000 psi.)

**Delivery:**  
**Fixed.** up to 33 cm<sup>3</sup>/min- 1500 r.p.m.  
**Adjustable.** up to 51cm<sup>3</sup>/min. - 2200 r.p.m.

**Lubricant:** Oil viscosity 15 cSt min.  
Grease NLGI 2\*

\* at the operating lubricant temperature between -20°C to +100°C

**MOTORS:**

**A.C. Motors:**

Code 3301137 Three phase 220/380V - 50Hz - 0.12kW  
Code 3301269 Single phase 220V - 50Hz - 0.12kW

**D.C. Motors:**

Code 3301283 24V 120W  
Code 3301274 12V - 100W

Specify voltage frequency and phase when ordering.

**INSTALLATION/OPERATION:**

Hydraulic diagram.

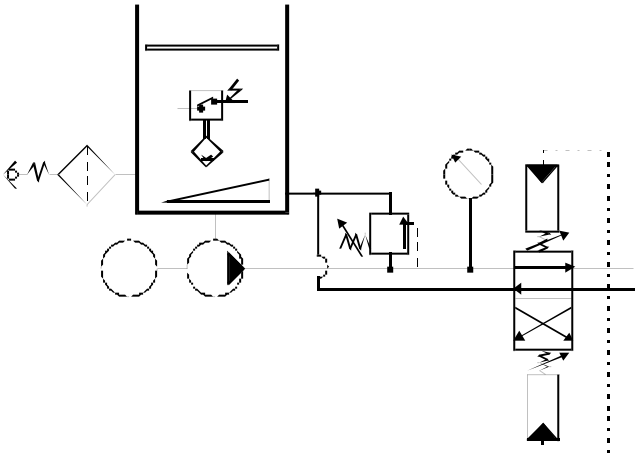

**Dimensions.**

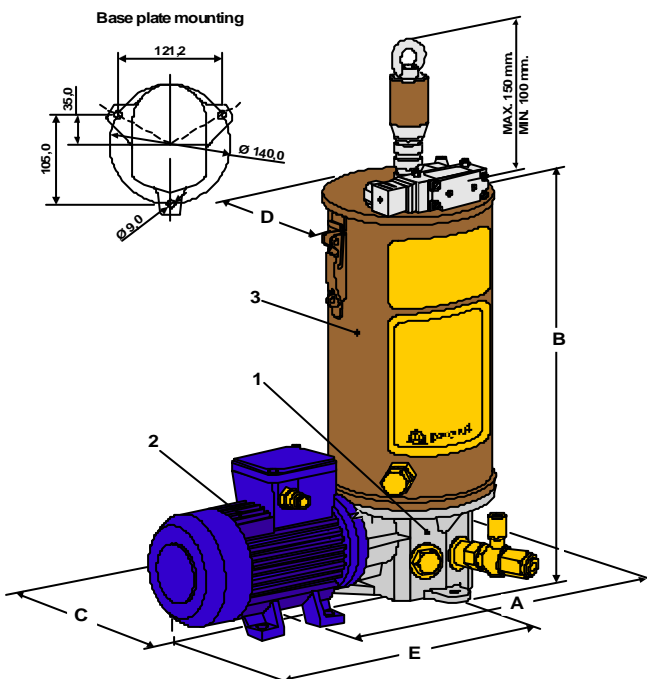

Pump	Dimensions mm.				
	A	B	C	D	E
3	390	340,5	220	Ø160	292
5	390	400,5	220	Ø160	292
10	442	505	220	Ø262	292
30	472	673	220	Ø262	292

**ACCESSORIES:**

**Auxiliary Pumping Unit.**

Pumps are supplied with one pumping unit but are designed for the mounting of two pumping units. This allows a feed to two separate lines or the outlets of the pumping units may be combined to provided double the delivery to a single line.

Part numbers of second pumping units are given in the table below.

Last digit of	Features of 999 pump			Second pumping unit	
	Delivery cm <sup>3</sup> /min.		Pressure	Part No./delivery	
	Adjust	Fixed		Adjust	Fixed
4	1,4-9,5	9,5	750	<b>299041</b>	<b>299039</b>
6	2,5-17	17	400	<b>299042</b>	<b>299040</b>
2	5-33	33	200	<b>299042</b>	<b>299040</b>

**Re-filling Filter. (for grease reservoir)**

Removable filter cartridge, to prevent contaminates and foreign bodies from entering the reservoir and to prevent air bubbles forming in the grease..

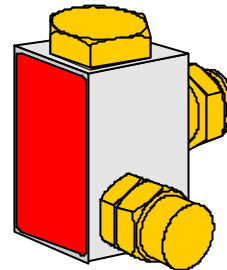

**Part No. 299352** for metal reservoirs.

**Part No. 299353** for transparent reservoirs.

Thread G ½ A UNI-ISO 228/1. Cartridge (150 micron)

**Part No. 1113006.** The filter is provided with thread Rp ¼ UNI-ISO 7/1 for the return line into the reservoir.

**Safety By-pass Valve.**

Available for different pressure ranges this adjustable valve can be fitted on the outlet line. It protects the system from over pressure.

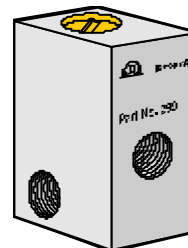

Part No.	Pressure range.
<b>299450</b>	0 to 250 bar (0 to 3600 psi.).
<b>299451</b>	0 to 450 bar (0 to 6500 psi.).
<b>299452</b>	50 to 1000 bar (725 to 14500 psi.).



### Max. Electric Level Contact.

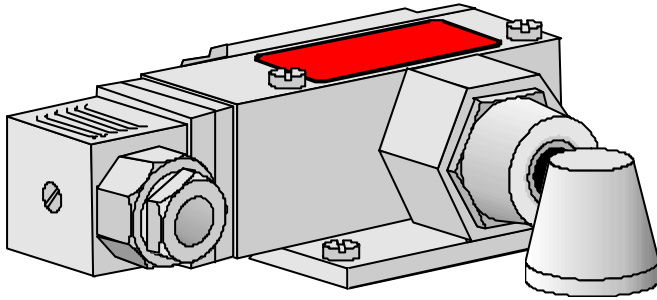

All metal reservoirs (except 3 and 5 litres) can be equipped with a Max. electric level contact for automatic re-filling of the reservoir.  
Reservoirs for grease.

Electric contact **Part No. 299197.**

Reservoirs for oil.

Electric contact **Part No. 291155.**

### Pressure Gauge.

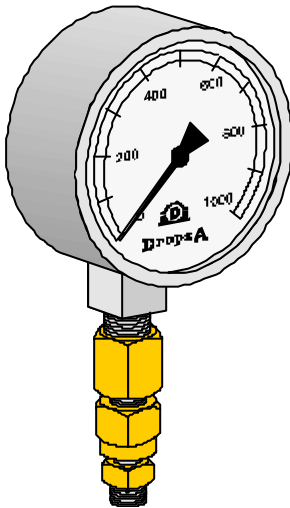

Available for different pressure ranges.

**Part No. 299196** 0 to 500 bar.

**Part No. 291395** 0 to 1000 bar.

### Assembly Kit.

999 series pumps can be equipped with a kit consisting of: Re-filling Filter; Pressure Gauge; Safety By-pass Valve and Base Plate. To order the Assembly Kit see the table below.

Last digit of pump Part No.	Assembly Kit with By-pass Valve	
	1 Pumping unit	2 Pumping Units
4	<b>299462</b>	<b>299463</b>
6	<b>299462</b>	<b>299463</b>
2	<b>299474</b>	<b>299475</b>

### Change Over Valve (Inverter).

For use with Dual Line Systems. An adjustable change

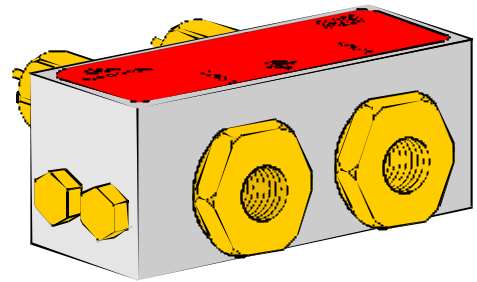

over valve (automatic change over when the pressure exceeds a fixed value) available in the following types:  
**Hydraulic Inverter.**

It controls automatically the lines' pressurisation inversion when the pressure value set on the adjusting valve is reached.

**Part No. 86198** for pressures up to 50 bar.

**Part No. 86199** for pressures up to 300 bar.

**Part No. 86200** for pressures up to 200 bar.

### Electro/pneumatic Inverter.

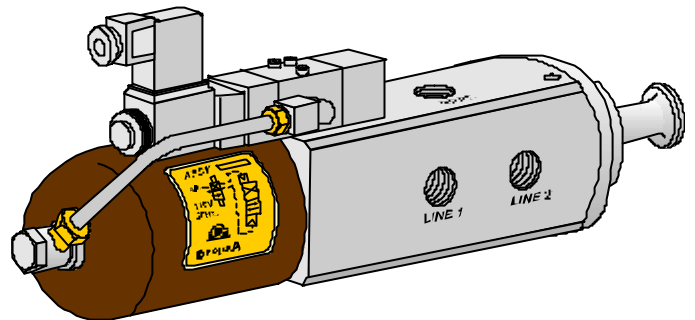

It controls the lines' pressurisation inversion through a solenoid valve connected to the system's electrical equipment and to the end of line pressure switch.

**For pressures up to 500 bar.**

**Part No. 83300** with electric valve 110V – 50Hz.

**Part No. 83304** with electric valve 220V – 50Hz.

**Part No. 83308** with electric valve 24V – 50Hz.

**Part No. 83309** with electric valve 24V d.c.

### Pneumatic Inverter.

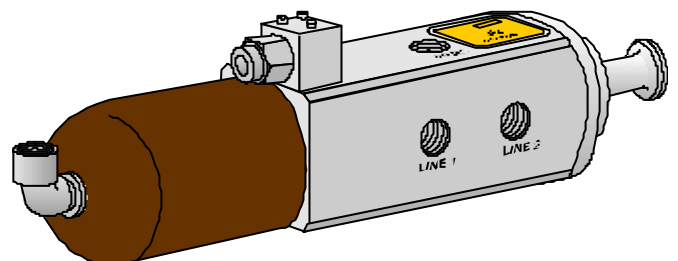

Similar to the electro-pneumatic inverter but without solenoid valve; it is operated through a pneumatically driven control directly from customer's equipment.

**Part No. 83301**



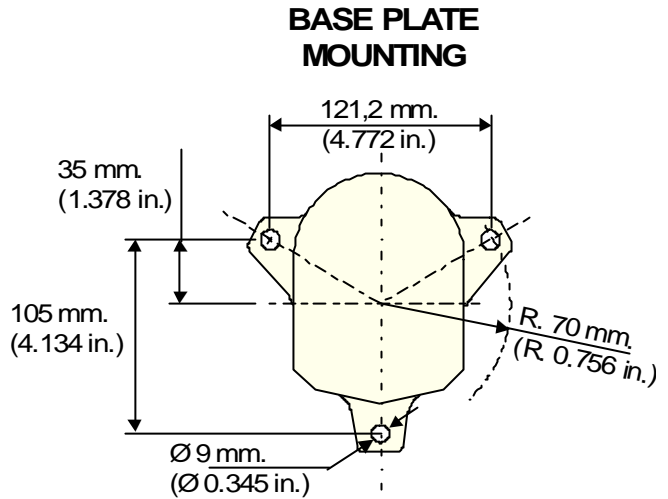
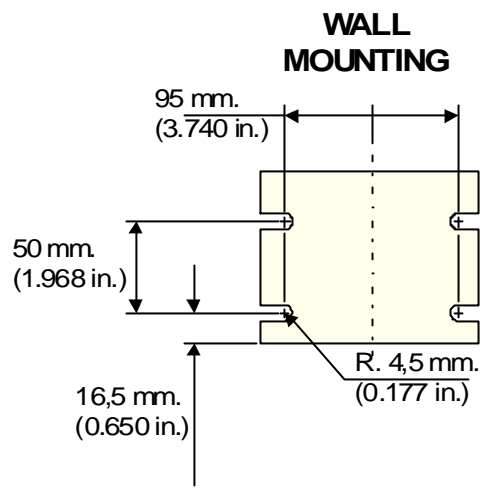
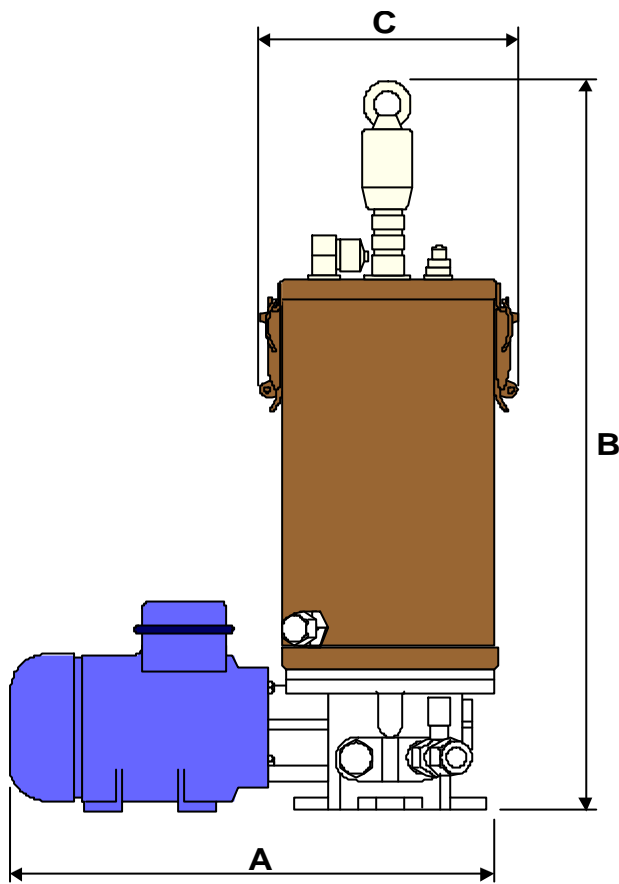

**OVERALL DIMENSIONS:**

D i m	Grease Reservoir										Oil Reservoir											
	3 Kg. (6.6 lbs.)				5 Kg. (11 lbs.)						10 Kg. (22 lbs.)		30 Kg. (66 lbs.)		3 litres (.8 US gal.)		5 litres (1.3 US gal.)		10 litres (2.6 US gal.)		30 litres (8 US gal.)	
	Trans.		Metal		Trans.		Metal															
	mm.	In.	mm.	In.	mm.	In.	mm.	In.	mm.	In.	mm.	In.	mm.	In.	mm.	In.	mm.	In.	mm.	In.		
A	300	11.8	300	11.8	300	11.8	300	11.8	423	16.6	453	17.8	300	11.8	300	11.8	423	16.6	453	17.8		
B	354	13.9	490	19.3	414	16.3	550	21.6	645	25.4	825	32.5	392	15.4	452	17.8	557	21.9	714	28.1		
CØ	197	7.8	197	7.8	197	7.8	197	7.8	299	11.8	358	14.1	197	7.8	197	7.8	299	11.8	358	14.1		

**U.K.**  
Dropsa (UK) Ltd.  
Unit 6, Egham Business Village,  
Egham,

**U.S.A.**  
Dropsa USA Inc.  
50679 Wing Drive  
Utica,

**AUSTRALIA**  
Dropsa Australia Pty.  
No. 7 Warringah Road  
Dee Why

**GERMANY**  
Dropsa GmbH.  
Volmerswerther Strasse 80  
40221 Dusseldorf 1,

**ITALY**  
Dropsa Spa  
Via B. Croce, 1 - 20090  
Vimodrone (MI)

Copyright Dropsa - all rights reserved. Reproduction of any part of this document is strictly forbidden without prior consent from Dropsa. Dropsa reserves the right to modify specifications without prior notice.



# MANUAL PUMPS 156000 SERIES

For Oil or Grease.

156000

ENGLISH

## PRODUCT DATA SHEET

### DESCRIPTION:

A range of manually operated pumps for use with dual line lubrication systems. The pumps are equipped with a built in reversing device. They are suitable for either oil or grease with a lubricant discharge of 3,4 cc. For each forward and return movement of the control lever. The pressure range is adjustable from 30 to 150 bar. Outlets are 2 3/8" BSP flat sealing outlet holes. The lower body of the pump is made of galvanised steel. The piston and the small piston valves are of hardened and lapped steel. The valves which control the inversion pressure are adjustable over a range of 30 to 150 bar. The pump body support is made of cast aluminium alloy. The hardened and lapped steel piston is activated by a shrunk-on lever on the handle with stub coupling. The double-acting piston is controlled by small piston valves. Line inversion occurs automatically and is indicated by the following:

- increased resistance of the operating lever.
- zero-set on the pressure gauge.
- The small pistons alternately come out from the pressure controlling valves.

### SPECIFICATION:

**Delivery:** 3,4 cm<sup>3</sup> for each forward and return movement of the control lever.

**Pressure:** 30 to 150 bar

**Line inversion:** 120 bar



**Lubricant:** Oil min. 15 cSt  
Grease refer to table.

**Reservoir:** 1, 2 and 5 litre.

**Pressure gauge:** 0 to 250 bar.

**Hydraulic inverter:** Equipped with two valves for the control of pressure inversion. Adjustable from 30 to 150 bar.

**Outlet:** 3/8 UNI-ISO  
228/1 (3/8 Gas).

**Reservoir inlet:** 1/2 A UNI-ISO 228/1 (1/2 Gas).

### ORDERING INFORMATION:

Please refer to the following table.

Pumps for Oil							
Pump with reservoir	Oil Litre.	Weight Kg.	Note	Dimensions mm.			
				A	B	C	
<b>156080</b>	5	7,8	Reservoir with visual level indicator.	420	275	---	
<b>156085</b>	1	5,8	Reservoir without visual level indicator.	310	199	---	
<b>156090</b>	2	6	Reservoir with visual level indicator.	459	199	---	
Pumps for Grease							
Pump with reservoir	Grease Kg.	Weight Kg.	Note	Type of Grease	Dimensions mm.		
					A	B	C
<b>156060</b>	5	12	Reservoir with follower plate.	NLGI 1	530	282	80 to 230
<b>156065</b>	1	6,2	Reservoir with follower plate.	NLGI 1	313	205	20 to 182
<b>156070</b>	2	8,6	Reservoir with follower plate and stem.	NLGI 2	515	220,5	54 to 355
<b>156075</b>	2	9,6	Reservoir with rapid filling fitting.	NLGI 1	535	220,5	8,5 to 23
<b>156095</b>	1	7,2	Reservoir with follower plate and stem.	NLGI 2	305	220,5	53 to 158

## INSTALLATION/OPERATION:

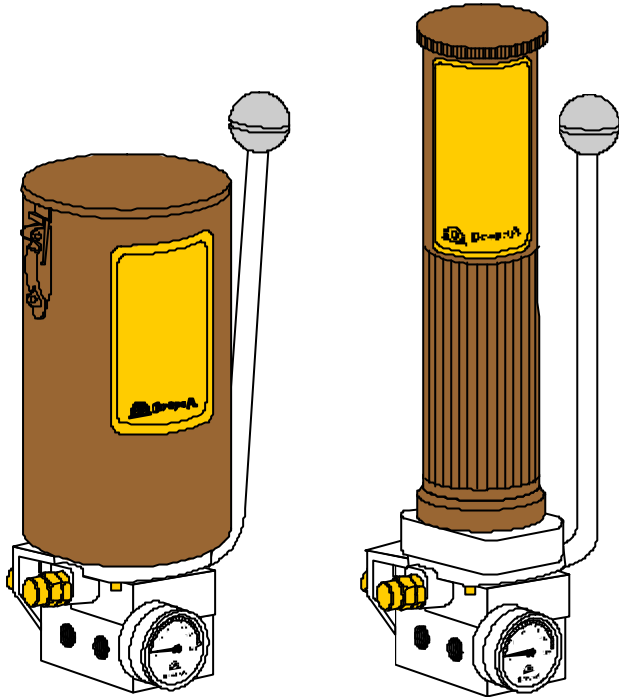

**Dimensions.**  
Refer to table.

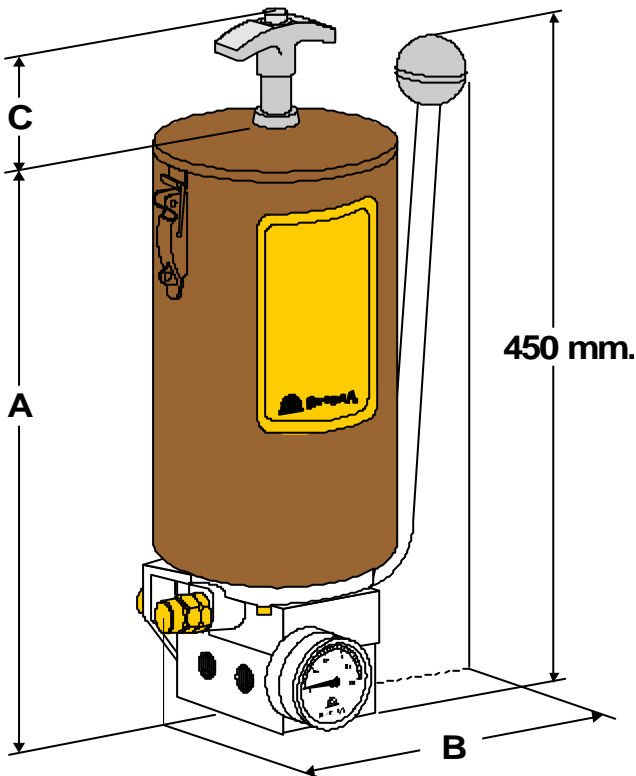

## ACCESSORIES:

### Mounting Plate.

For fixing 156000 series pumps.

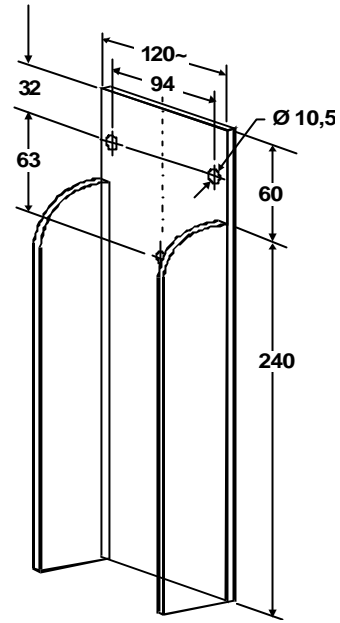

U-welded plate **Part No. 111580**

Weight: 3,70 Kg.

### Filling Socket.

To fill reservoir **Part No. 1815000.**

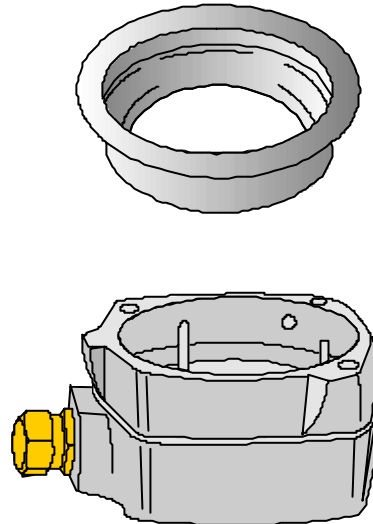

**Part No. 1142000**

Weight: 2,6 Kg.

**U.K.**  
Dropsa (UK) Ltd.  
Unit 6, Egham Business Village,  
Egham,  
Surrey, TW20 8RB  
Tel: (+44) 01784 - 431177  
Fax: (+44) 01784 - 438598  
E-mail: salesuk@dropsa.com

**U.S.A.**  
Dropsa USA Inc.  
50679 Wing Drive  
Utica,  
Michigan 48315,  
Tel: (+1) 810-566-1540  
Fax: (+1) 810-566-1541  
E-mail: salesusa@dropsa.com

**AUSTRALIA**  
Dropsa Australia Pty.  
No. 7 Warringah Road  
Dee Why  
NSW 2099  
Tel: (+61) 2 9905 0410  
Fax: (+61) 2 99394142  
E-mail: sales@dropsa.com

**GERMANY**  
Dropsa GmbH.  
Volmerswerther Strasse 80  
40221 Dusseldorf 1,  
Deutschland  
Tel: (+49) 0211-394-011  
Fax: (+49) 0211-394-013  
E-mail: sales@dropsa.de

**ITALY**  
Dropsa Spa  
Via B. Croce, 1 - 20090  
Vimodrone (MI)  
Tel: (+39) 02 - 250.79.1  
Fax: (+39) 02 - 250.79.767  
E-mail: sales@dropsa.it (Export)  
E-mail: vendite@dropsa.it (National)

© Copyright Dropsa - all rights reserved. Reproduction of any part of this document is strictly forbidden without prior consent from Dropsa. Dropsa reserves the right to modify specifications without prior notice.



# MOTORIZED GEAR PUMPS SERIES 1222000

For Oil and Light Grease

1222000

ENGLISH

## PRODUCT DATA SHEET

### DESCRIPTION:

These pumps have been designed to offer a solid and functional lubrication unit, which will feed and control the correct operation of double line oil systems.

The unit consists of:

- gear pump, output 250 cc/min., driver by a 3-phase electric motor
- 6 litre capacity sheet steel reservoir
- hydraulic inverter
- gauge, signalling the pressure in the line connected to the pump.

The gauge will also signal (with a temporary zero setting), the moment at which the lines' inversion takes place.

The hydraulic inverter will automatically feed the two lubricating lines alternatively.

A further warranty of the system's safety is given by a Reed contact in the reservoir's electric minimum level switch.

A pressure switch ( for pump model 1222070 only) will check the safe operation of the system by signalling to an electric panel (available on request) that the line pressure has reached the set value.

### SPECIFICATION:

<b>Delivery:</b>	250 cm <sup>3</sup> /min.
<b>Pressure:</b>	100 bar max.
<b>Lubricant:</b>	15 to 1000 Cst. At normal fluid temperature.
<b>Motor:</b>	Three phase 220/380 V – 50 Hz.
<b>Protection:</b>	IP 55
<b>Reservoir:</b>	6 litre steel with low level indicator.
<b>Lubricant outlet:</b>	G 3/8 UNI-ISO 228/1
<b>Pressure regulating valve:</b>	set to 90 bar.
<b>Inlet filter:</b>	250 micron.



**Minimum level contact:**

Max. potential 60 VA.

**Max. voltage:**

220 V ac. To 150 V dc.

**Max. current:**

1 A.

**Pressure gauge:**

scale 0 to 120 bar.  
To signal pressure in the line.

**Line inverter:**

An over pressure hydraulic inverter will automatically invert the lines when the pressure value set on its valves is reached; it is adjustable from 30 up to 150 bar, pressure adjusted at 80 bar.

**End of line pressure switch:**  
(for pump model 1222070 only)

### ORDERING INFORMATION:

Ordering is by description and Part No.

Motorized pump without pressure switch for cycle control. **Part No. 1222060**

Motorized pump with pressure switch for cycle control. **Part No. 1222070.**

### INSTALLATION/OPERATION:

## Dimensions.

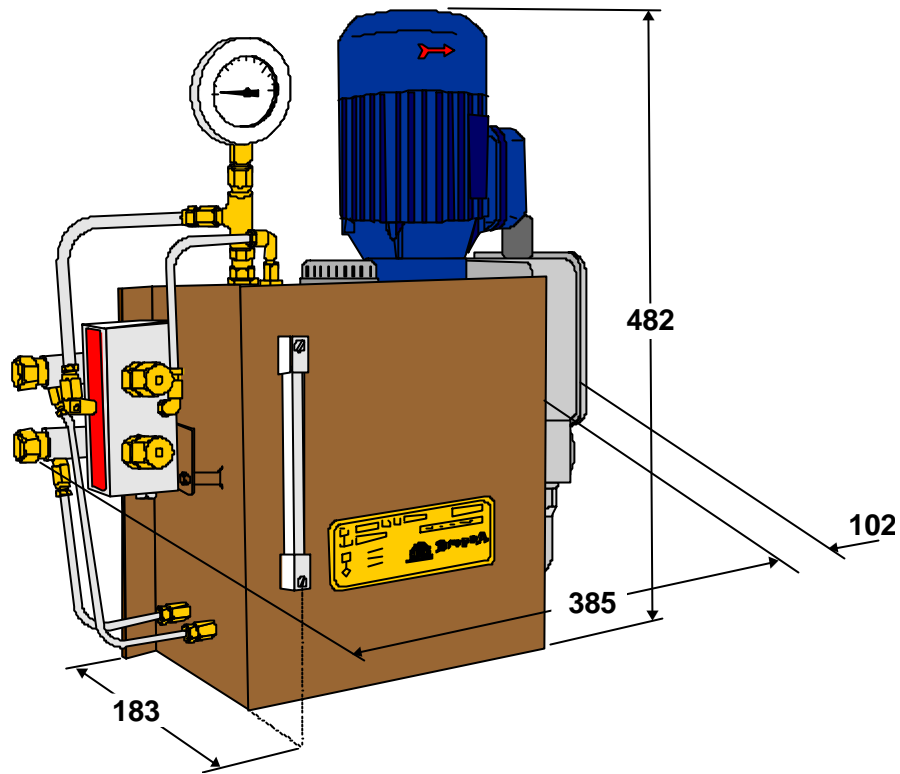

## Hydraulic diagram.

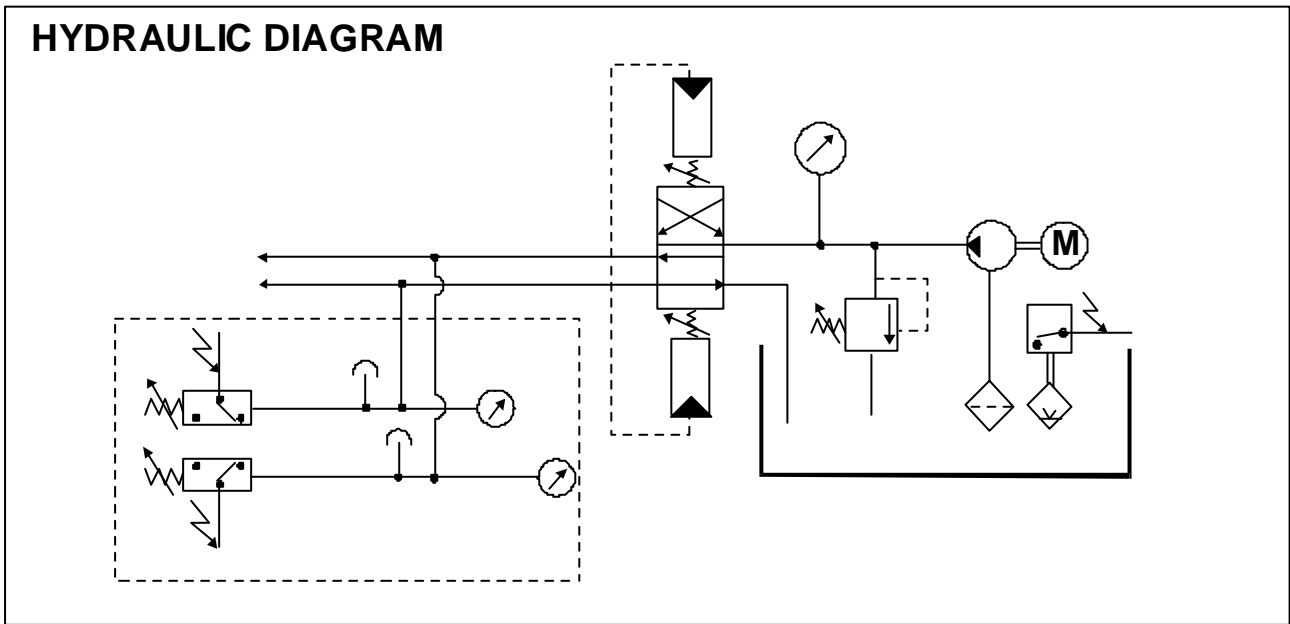

**U.K.**  
 Dropsa (UK) Ltd.  
 Unit 6, Egham Business Village,  
 Egham,  
 Surrey. TW20 8RB  
 Tel: (+44) 01784 - 431177  
 Fax: (+44) 01784 - 438598  
 E-mail: salesuk@dropsa.com

**U.S.A.**  
 Dropsa USA Inc.  
 50679 Wing Drive  
 Utica,  
 Michigan 48315,  
 Tel: (+1) 810-566-1540  
 Fax: (+1) 810-566-1541  
 E-mail: salesusa@dropsa.com

**AUSTRALIA**  
 Dropsa Australia Pty.  
 No. 7 Warringah Road  
 Dee Why  
 NSW 2099  
 Tel: (+61) 2 9905 0410  
 Fax: (+61) 2 99394142  
 E-mail: sales@dropsa.com

**GERMANY**  
 Dropsa GmbH.  
 Volmerswerther Strasse 80  
 40221 Dusseldorf 1,  
 Deutschland  
 Tel: (+49) 0211-394-011  
 Fax: (+49) 0211-394-013  
 E-mail: sales@dropsa.de

**ITALY**  
 Dropsa Spa  
 Via B. Croce,1 - 20090  
 Vimodrone (MI)  
 Tel: (+39) 02 - 250.79.1  
 Fax: (+39) 02 - 250.79.767  
 E-mail: sales@dropsa.it (Export)  
 E-mail: vendite@dropsa.it (National)

© Copyright Dropsa - all rights reserved. Reproduction of any part of this document is strictly forbidden without prior consent from Dropsa. Dropsa reserves the right to modify specifications without prior notice.



# TRANSFER AND FILLING PUMPS SERIES 132000

For Oil or Grease and Non-corrosive Fluids.

132000

ENGLISH

## PRODUCT DATA SHEET

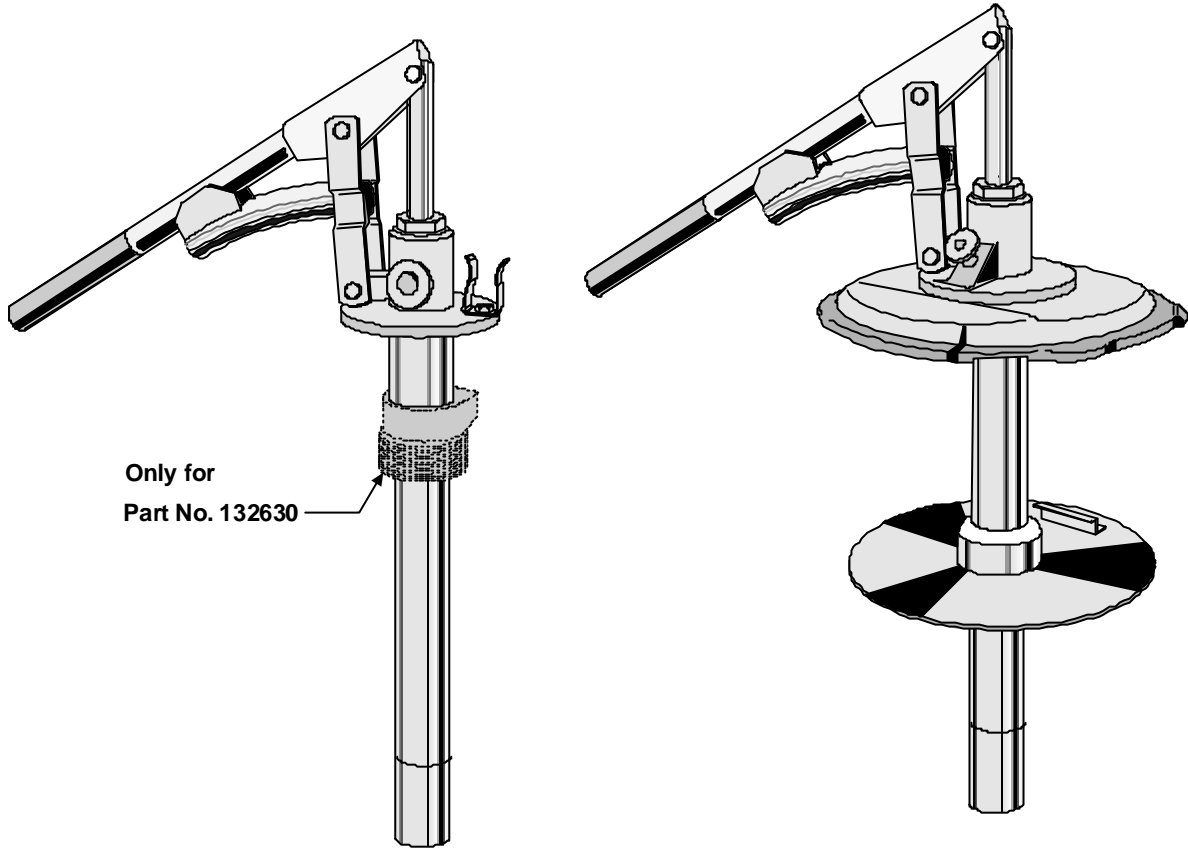

### DESCRIPTION:

Piston pumps equipped with suction hose. Discharge .050 Kg. (.11 lb.) of lubricant per stroke with a back pressure of 35 bar (500 psi.). A manual built in pressure release valve permits return of handle to down position without discharging lubricant. Can be used for transferring alcohol, asphalt emulsions, fuel cleaning solvents, fuel oil, benzine, lacquer thinner, vegetable oils and many other non-corrosive, non-abrasive materials. Pumps are supplied without filter.

### SPECIFICATION:

**Delivery:** 50 cm<sup>3</sup> of fluid for each operation of the lever.  
**Pressure:** 35 bar max.

### ORDERING INFORMATION:

Please refer to the following table.

For drums Kg.	Pump Part No.	Cover Part No.	Follower plate (grease only) Part No.	Piston Rod mm.
200	<b>132630</b>	<b>1141500</b>	<b>1141103</b>	925
115	<b>132530</b>	<b>1141130</b>	<b>1141130</b>	690
56	<b>132540</b>	<b>1141131</b>	<b>1141131</b>	515
20	<b>132550</b>	<b>1141140</b>	<b>1141140</b>	375



**INSTALLATION/OPERATION:**

**Dimensions.**

Please refer to the following table.

Dimensions				
Pump Part No.	A mm.	B mm.	C mm.	D Internal Ø of drum.
<b>132057</b>	390	375	190 -	316
<b>132550</b>	390	375	190 -	316
<b>132540</b>	390	515	190 -	380
<b>132530</b>	390	690	190 -	486
<b>132630</b>	390	925	190 -	612

Hose with oil transfer valve Ø tube 13x23  
**Part No. 101777**

Hose without oil transfer valve Ø tube 13x23  
**Part No. 101778**

Refilling pump hose Ø tube 13x23  
**Part No. 101779**

When ordering hoses indicate length 'L' cm.

**Hydraulic diagram.**

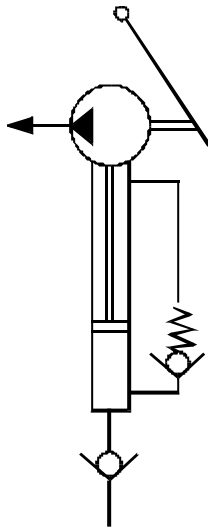

**Dimensions:**

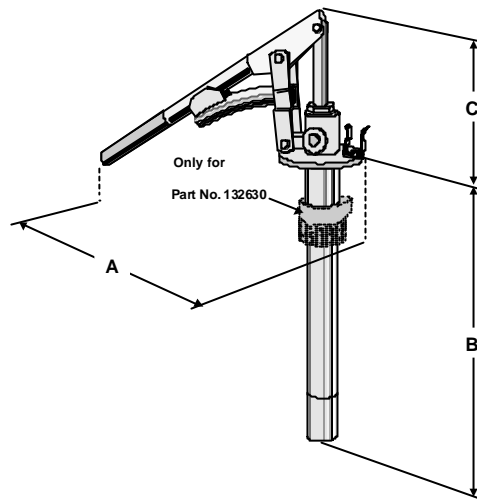

**Part No's.**  
132630  
132550  
132540  
132530

**ACCESSORIES:**

**Follower plate:**

It is needed when the pump is used to transfer greases (see table). Maximum grease consistency NLGI 1.

**Lid:**

It is used when the pump is assembled onto a drum (it replaces the original drum's cover, see table).

**Oil strainer:**

**Part No. 1113240** thread Ø 3/8" BSP taper.  
Element **Part No. 1113231**

**Grease strainer:**

**Part No. 1113210** thread Ø 3/8" BSP taper.  
Element **Part No. 1113205**

**Nipple;**

For pump filter joint 3/8" BSP  
**Part No. 133085**

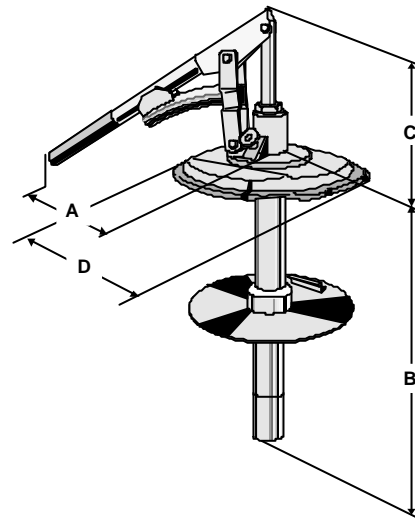

**Part No's.**  
132057

**U.K.**  
Dropsa (UK) Ltd.  
Unit 6, Egham Business Village,  
Egham,  
Surrey, TW20 8RB  
Tel: (+44) 01784 - 431177  
Fax: (+44) 01784 - 438598  
E-mail: salesuk@dropsa.com

**U.S.A.**  
Dropsa USA Inc.  
50679 Wing Drive  
Utica,  
Michigan 48315.  
Tel: (+1) 810-566-1540  
Fax: (+1) 810-566-1541  
E-mail: salesusa@dropsa.com

**AUSTRALIA**  
Dropsa Australia Pty.  
No. 7 Warringah Road  
Dee Why  
NSW 2099  
Tel: (+61) 2 9905 0410  
Fax: (+61) 2 99394142  
E-mail: sales@dropsa.com

**GERMANY**  
Dropsa GmbH.  
Volmerswerther Strasse 80  
40221 Dusseldorf 1,  
Deutschland  
Tel: (+49) 0211-394-011  
Fax: (+49) 0211-394-013  
E-mail: sales@dropsa.de

**ITALY**  
Dropsa Spa  
Via B. Croce, 1 - 20090  
Vimodrone (MI)  
Tel: (+39) 02 - 250.79.1  
Fax: (+39) 02 - 250.79.767  
E-mail: sales@dropsa.it (Export)  
E-mail: vendite@dropsa.it (National)

© Copyright Dropsa - all rights reserved. Reproduction of any part of this document is strictly forbidden without prior consent from Dropsa. Dropsa reserves the right to modify specifications without prior notice.



# HEAVY DUTY PNEUMATIC PUMPS SERIES 400200

For Oil or Grease and Non-corrosive Fluids.

400200  
400300  
400205  
400210

ENGLISH

## PRODUCT DATA SHEET

### DESCRIPTION:

Exceptionally strong, powerful and durable pumps.  
Suitable for the supply of light, heavy or fibrous lubricants, even at low temperatures.  
Fits standard commercial drums or large capacity drums.

#### Features:

**Air supply valve;** complete with floating slide, held on the seat by the air pressure, self sealing and self cleaning

**Positive operation;** a double toggle joint correctly positions the distribution valve.

**Corrosion proof steel rod;** is guided to prevent faulty alignment of the air control valves, chromium plated hardened and lapped, to reduce the wear of the seals to a minimum.

**Wide air discharge;** to reduce the outlet air temperature drop to a minimum for maximum efficiency.

**Minimum friction;** the synthetic rubber air piston slides in a corrosion proof lapped aluminium cylinder.

**Long life seals;** accurate assembly, resilience and quality of the materials used, ensure a good seal for long periods.

**No interruption for adjustment or lubrication;** the air motor is sealed, there are no exposed moving parts.

**Maximum life! No seal;** the piston and cylinder are of special steel, treated, normalized and micro-lapped.

**Double self alignment joint;** with safety spring and square thread.

**Sure priming;** the base valve is made of hardened steel and ensures a perfect seal.

**Forced feed device;** makes it possible to feed very hard lubricants into the compression chamber.



### SPECIFICATION:

<b>Compression rate:</b>	see table.
<b>Delivery:</b>	see table.
<b>Air driven pressure:</b>	14 bar max.
<b>Air inlet:</b>	G 3/4 UNI-ISO 228/1

### ORDERING INFORMATION:

Ordering is by description and Part No. , please refer to the following table:

Ratio	Pump Assy. Part No.	Air motor only Part No.	Piston rod only Part No.	Type of lubricant	Delivery air pressure 7 bar.
40:1	<b>400200</b>	<b>400100</b>	<b>400170</b>	Grease NLGI 2	8 Kg./min.
75:1	<b>400300</b>	<b>400100</b>	<b>400155</b>	Grease NLGI 2	5 Kg./min.
25:1	<b>400205</b>	<b>400100</b>	<b>400165</b>	Grease/oil 1000 cSt.	16 ltr./min.
6:1	<b>400210</b>	<b>400100</b>	<b>400160</b>	Oil 1000 cSt.	28 ltr./min.

**Air outlet:**

G ½ UNI-ISO 228/1

**Dimensions.**

**Weight:**

25 – 28 Kg.

**INSTALLATION/OPERATION :**

**Hydraulic diagram.**

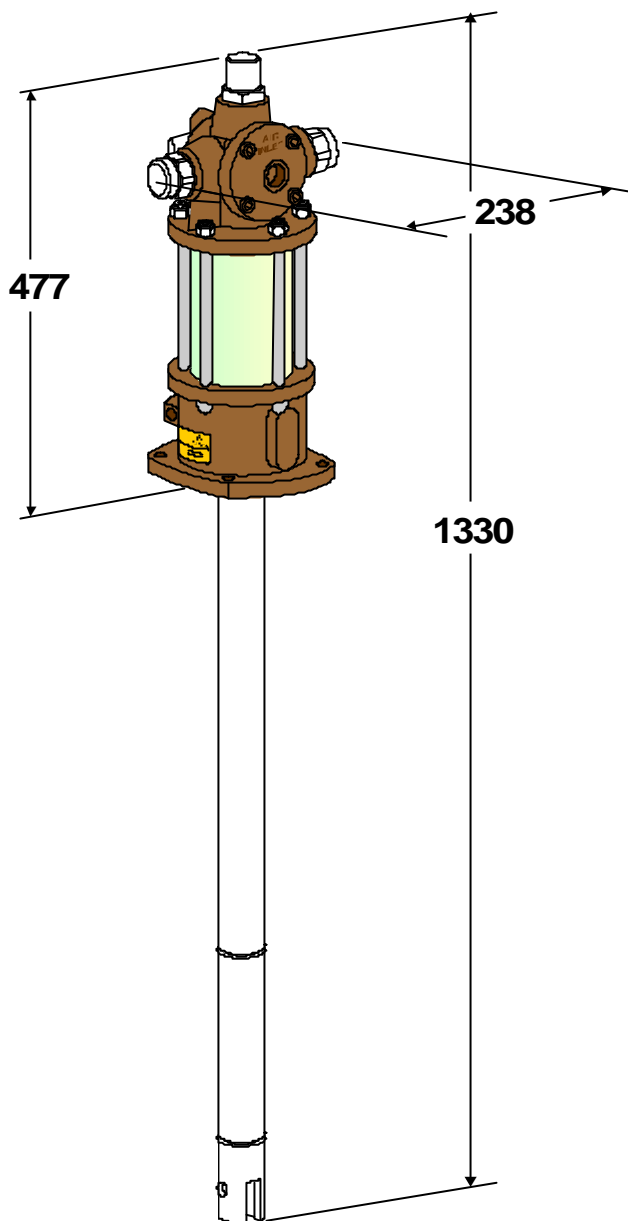
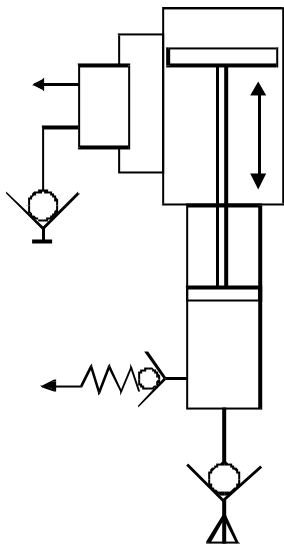

**Accessories.**

Exhaust silencer – Part No. **2034950**

Cover for 180 Kg. Drums – Part No. **400040**

**Spares.**

Component Part No.	Service Kit Part No.
<b>400100</b>	<b>2037304</b>
<b>400100</b>	<b>2037334</b>
<b>400160</b>	<b>2037305</b>
<b>400165</b>	<b>2037306</b>
<b>400170</b>	<b>2037307</b>
<b>400170</b>	<b>400194</b>
<b>400170</b>	<b>2039930</b>
<b>400155</b>	<b>400195</b>
<b>400155</b>	<b>2034857</b>

**U.K.**  
 Dropsa (UK) Ltd.  
 Unit 6, Egham Business Village,  
 Egham,  
 Surrey, TW20 8RB  
 Tel: (+44) 01784 - 431177  
 Fax: (+44) 01784 - 438598  
 E-mail: salesuk@dropsa.com

**U.S.A.**  
 Dropsa USA Inc.  
 50679 Wing Drive  
 Utica,  
 Michigan 48315.  
 Tel: (+1) 810-566-1540  
 Fax: (+1) 810-566-1541  
 E-mail: salesusa@dropsa.com

**AUSTRALIA**  
 Dropsa Australia Pty.  
 No. 7 Warringah Road  
 Dee Why  
 NSW 2099  
 Tel: (+61) 2 9905 0410  
 Fax: (+61) 2 99394142  
 E-mail: sales@dropsa.com

**GERMANY**  
 Dropsa Gmbh.  
 Volmerswerther Strasse 80  
 40221 Dusseldorf 1,  
 Deutschland  
 Tel: (+49) 0211-394-011  
 Fax: (+49) 0211-394-013  
 E-mail: sales@dropsa.de

**ITALY**  
 Dropsa Spa  
 Via B. Croce, 1 - 20090  
 Vimodrone (MI)  
 Tel: (+39) 02 - 250.79.1  
 Fax: (+39) 02 - 250.79.767  
 E-mail: sales@dropsa.it (Export)  
 E-mail: vendite@dropsa.it (National)

© Copyright Dropsa - all rights reserved. Reproduction of any part of this document is strictly forbidden without prior consent from Dropsa. Dropsa reserves the right to modify specifications without prior notice.



# PNEUMATIC TRANSFER AND FILLING PUMPS 72160 SERIES

For Oil or Grease and Non-corrosive Fluids.

72160  
72161

ENGLISH

## PRODUCT DATA SHEET

### DESCRIPTION:

This type of pneumatically controlled automatic pump is suitable for transferring oil, light grease and non-corrosive fluids from 400 lb. (180 Kg.) commercial drums. It can be fixed onto the drum using a mobile bung adapter that allows the pump to be positioned at the required depth and the outlet to be pointed in any direction.

The pump is supplied complete with an air shut-off-valve and a quick release air connection. This type of pump is ideal for feeding lubricant at high pressure as the design eliminates air bubbles in the lubricant. These pumps can also be used for the transfer of alcohol, gasoline, solvents, mineral naphtha, kerosene and every other kind of non-corrosive, non-abrasive fluids.

The displacement is about 35 lb. Of grease or 2 cu. Ft. of SAE Oil per minute at a pressure of 100 psi. The pump weighs 9 Kg.

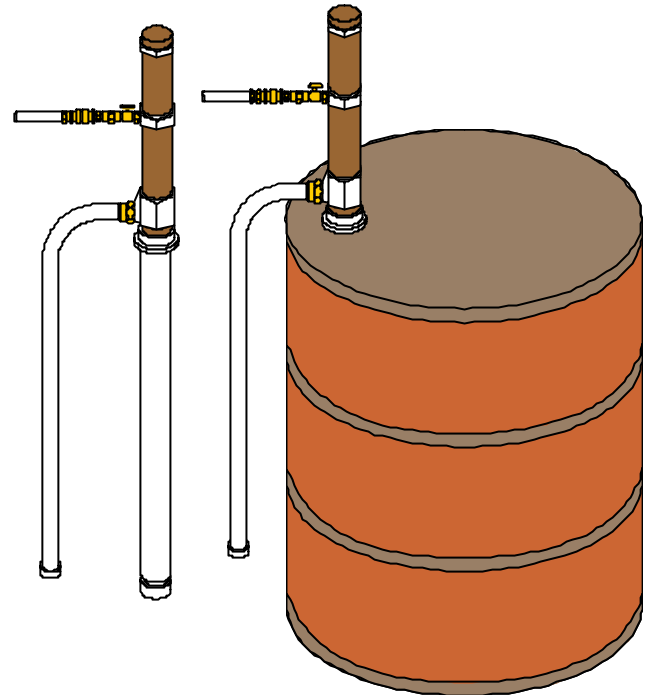

### SPECIFICATION:

#### Recommended operating air pressure:

100 psi.

**Maximum operating air pressure:** 200 psi.

**Maximum fluid pressure:** 200 psi.

**Lubricant outlet:** 1" BSP (RP 1 UNI-ISO 7/1).

**Air inlet:** ¼" BSP (RP ¼ UNI-ISO 7/1).

**Air exhaust port:** Ø 5/8"

**Lubricant inlet:** 0,30 cm<sup>3</sup>

**Displacement:** Ø 168 cm<sup>3</sup>/cycle

**Air consumption:** 800 NL/min. at 7 bar.

**Stroke:** 98,5 mm.

**Weight:** 9 Kg.

### INSTALLATION/OPERATION:

#### Maintenance.

The pump must be cleaned periodically and whenever there is a change in the type of fluid to be handled. For routine maintenance a repair kit **Part No. 72211** is available.

### ORDERING INFORMATION:

Ordering is by description and Part No. Please refer to the following table:

Part No. and description	Weight	Air pressure	Delivery		
			Oil SAE 10	Light grease SAE 140	Grease NLGI 1
<b>Standard model Part No. 72160</b>	9	7 bar	50 Ltr./min.	25 Ltr./min.	16 Kg./min.
<b>With dispensing tube Part No. 72161</b>	9	7 bar	50 Ltr./min.	25 Ltr./min.	16 Kg./min.

**Dimensions:**

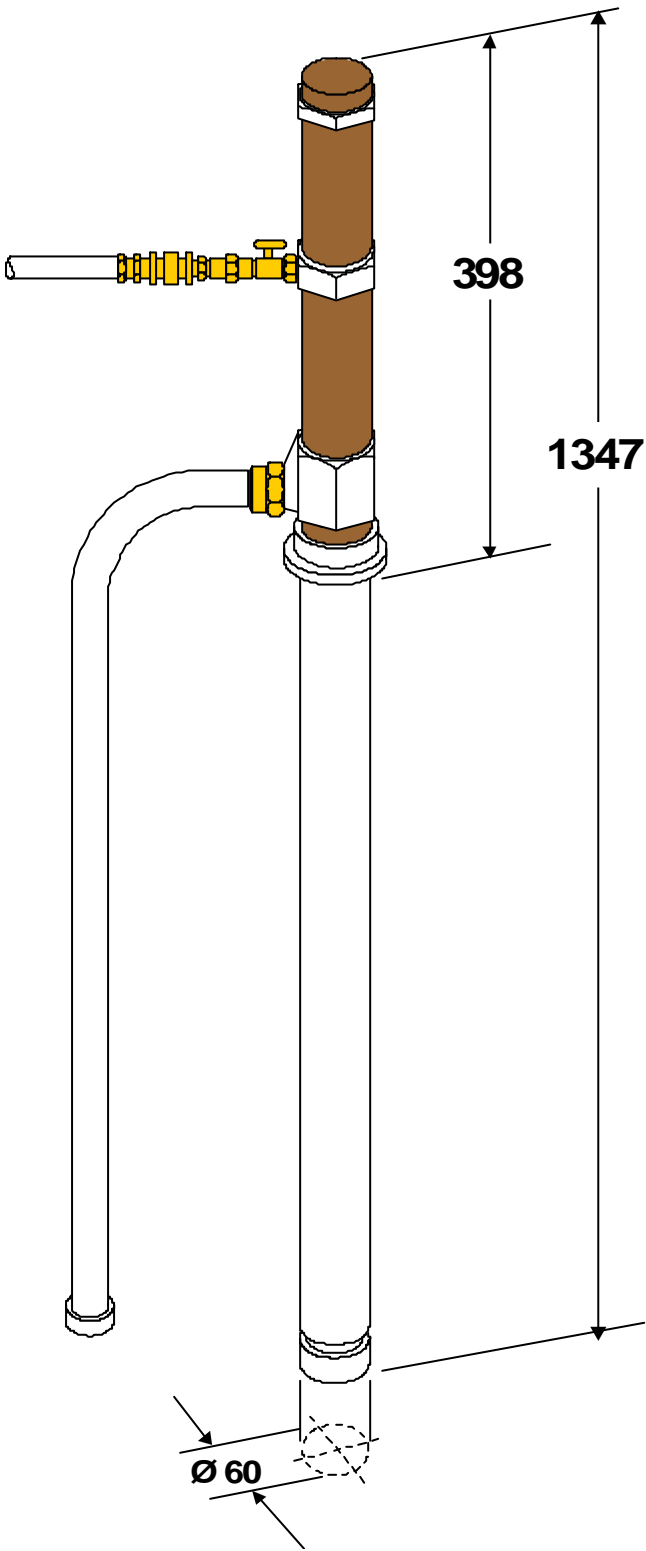

**Hydraulic diagram.**

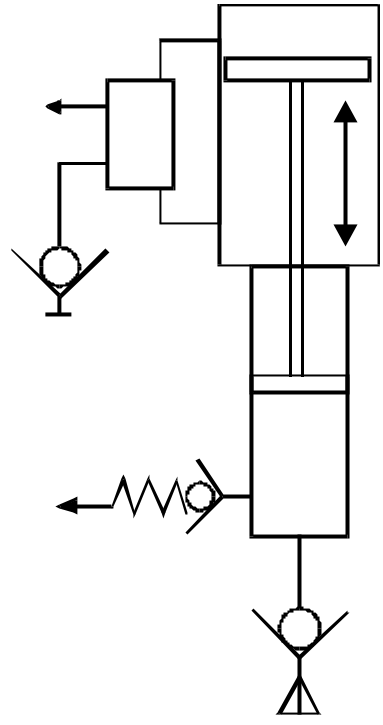

**U.K.**  
 Dropsa (UK) Ltd.  
 Unit 6, Egham Business Village,  
 Egham,  
 Surrey, TW20 8RB  
 Tel: (+44) 01784 - 431177  
 Fax: (+44) 01784 - 438598  
 E-mail: salesuk@dropsa.com

**U.S.A.**  
 Dropsa USA Inc.  
 50679 Wing Drive  
 Utica,  
 Michigan 48315,  
 Tel: (+1) 810-566-1540  
 Fax: (+1) 810-566-1541  
 E-mail: salesusa@dropsa.com

**AUSTRALIA**  
 Dropsa Australia Pty.  
 No. 7 Warringah Road  
 Dee Why  
 NSW 2099  
 Tel: (+61) 2 9905 0410  
 Fax: (+61) 2 99394142  
 E-mail: sales@dropsa.com

**GERMANY**  
 Dropsa GmbH.  
 Volmerswerther Strasse 80  
 40221 Dusseldorf 1,  
 Deutschland  
 Tel: (+49) 0211-394-011  
 Fax: (+49) 0211-394-013  
 E-mail: sales@dropsa.de

**ITALY**  
 Dropsa Spa  
 Via B. Croce, 1 - 20090  
 Vimodrone (MI)  
 Tel: (+39) 02 - 250.79.1  
 Fax: (+39) 02 - 250.79.767  
 E-mail: sales@dropsa.it (Export)  
 E-mail: vendite@dropsa.it (National)

© Copyright Dropsa - all rights reserved. Reproduction of any part of this document is strictly forbidden without prior consent from Dropsa. Dropsa reserves the right to modify specifications without prior notice.



# MICRO SWITCH FOR FLOW CONTROL

Dual Line System

1655089 1655132  
1655135 1655137  
1655145 1655151  
1655160 3164126

ENGLISH

## PRODUCT DATA SHEET

### DESCRIPTION:

These micro-switches have been designed for controlling feeder blocks of the dual line system.

- **Series AP6** (adjustable discharge 0,25 to 1,5 cm<sup>3</sup>)
- **Series AG6** (adjustable discharge 0,5 to 3 cm<sup>3</sup>)
- Modular Dual Line Feeders Series DMM (adjustable discharge 0,3 to 1 cm<sup>3</sup>)
- **Modular Dual Line Feeders Series DM & DMX** (adjustable discharge 0,5 to 3 cm<sup>3</sup>)
- **Modular Dual Line Feeders Series DMG** (adjustable discharge 3 to 24 cm<sup>3</sup>)
- **Modular Dual Line Feeders Series DMG1** (adjustable discharge 3 to 40 cm<sup>3</sup>)
- **Modular Dual Line Feeders Series DMG2** (adjustable discharge 51 to 88 cm<sup>3</sup>)

These micro-switches are particularly suitable for controlling the correct delivery of lubricant to critical friction points.

In order to obtain a correct movement of the piston in both directions you must mount a micro-switch on the adjusting turret of the feeder and another on the opposite side.

To choose the correct micro-switch refer to fig 1.

### **Warning!**

The control of the correct movement of a metering piston guarantees that only the controlled feeder block is working but it does not guarantee that other feeders, not controlled on the same dual line, are working too. For this reason it is necessary to mount a micro-switch on each feeder block which must be controlled.

### SPECIFICATION:

**Electrical feeding:** up to 10A 250V ac. or 5A  
**Protection degree:** IP 55  
**Working temperature:** -15°C to +80°C  
**Working pressure:** 200 bar max.

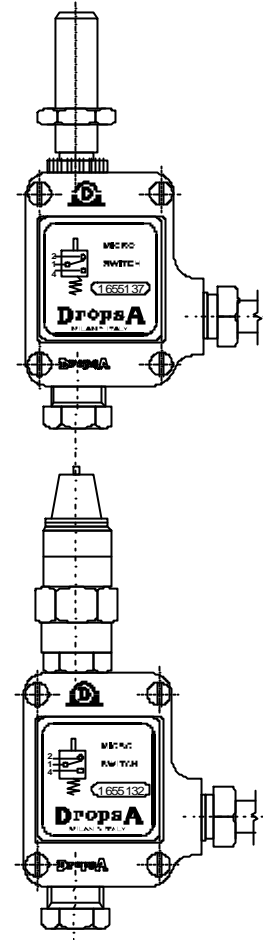

**TURRET SIDE**

Part No. 1655137	AP6	AG6	DM
Part No. 1655151	DMM		
Part No. 3164126	DMG		
Part No. 1655160	DMG1	DMG2	

**SIDE OPPOSITE THE TURRET**

Part No. 1655135	AP6		
Part No. 1655132	AG6		
Part No. 1655145	DMM	DM	
Part No. 1655089	DMG	DMG1	



## INSTALLATION/OPERATION:

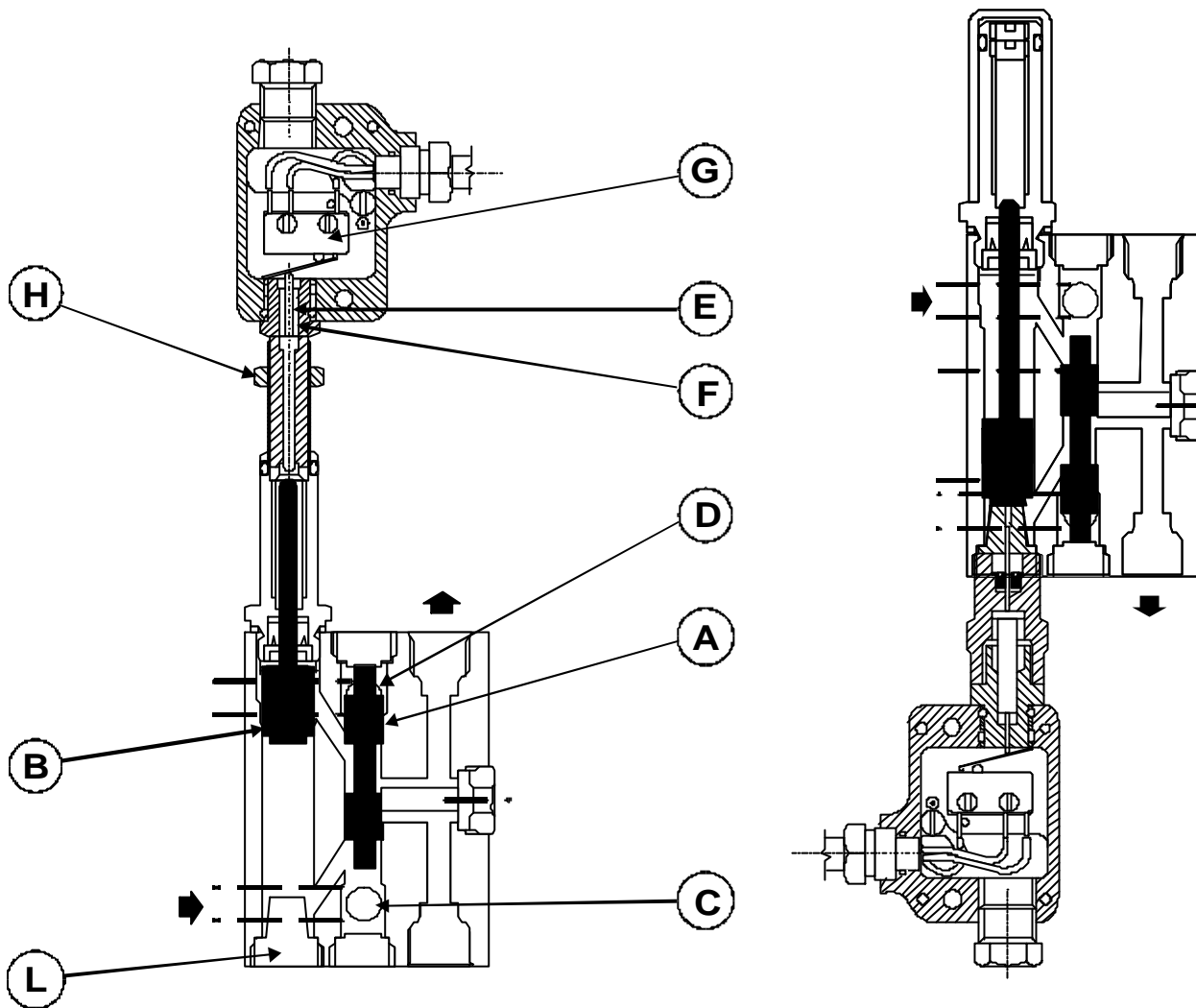

### Installing micro-switch on turret side. (fig 2.)

This micro-switch is screwed directly on the indicator turret. For the installation it is necessary to remove the turret's cover and the two adjusting screws and then screw the micro-switch on the turret; after having positioned the micro-switch on the desired delivery, tighten it by means of nut 'H'.

### Installing micro-switch on the side opposite the turret. (fig 3.)

These micro-switched are installed on the other side of the turret and replace plug 'L'.

For electrical connections please refer to the diagram on the label of the micro-switches' cover.

### Function.

The lubricant, under pressure, enters hole 'C' and moves upwards servo piston A and metering piston B (fig. 2) . Piston B's pin pushes pin E on the micro-switch, compresses spring F and activates contact G, thus signalling that the stroke of the metering piston has taken place. When pressure alternates from line 1 to line 2, the lubricant enters from hole S, pushes downwards pistons A and B and switches contact G. If required, an additional micro-switch can also be installed on the opposite side of the indicator turret, thus signalling the return stroke of the piston (fig. 3).

### Maintenance.

The mechanical and electrical components of the units are not subject to particularly heavy thermal or mechanical treatment. .For spare micro-switch G, only order part no. 38031.

**U.K.**  
Dropisa (UK) Ltd.  
Unit 6, Egham Business Village,  
Egham,  
Surrey, TW20 8RB  
Tel: (+44) 01784 - 431177  
Fax: (+44) 01784 - 438598  
E-mail: salesuk@dropisa.com

**U.S.A.**  
Dropisa USA Inc.  
50679 Wing Drive  
Utica,  
Michigan 48315,  
Tel: (+1) 810-566-1540  
Fax: (+1) 810-566-1541  
E-mail: salesusa@dropisa.com

**AUSTRALIA**  
Dropisa Australia Pty.  
No. 7 Warringah Road  
Dee Why  
NSW 2099  
Tel: (+61) 2 9905 0410  
Fax: (+61) 2 99394142  
E-mail: sales@dropisa.com

**GERMANY**  
Dropisa GmbH.  
Volmerswerther Strasse 80  
40221 Dusseldorf 1,  
Deutschland  
Tel: (+49) 0211-394-011  
Fax: (+49) 0211-394-013  
E-mail: sales@dropisa.de

**ITALY**  
Dropisa Spa  
Via B. Croce,1 - 20090  
Vimodrone (MI)  
Tel: (+39) 02 - 250.79.1  
Fax: (+39) 02 - 250.79.767  
E-mail: sales@dropisa.it (Export)  
E-mail: vendite@dropisa.it (National)

© Copyright Dropisa - all rights reserved. Reproduction of any part of this document is strictly forbidden without prior consent from Dropisa. Dropisa reserves the right to modify specifications without prior notice.



# END OF LINE PRESSURE SWITCH

Dual Line System.

1124402  
1124415  
1124440  
1124447

ENGLISH

## PRODUCT DATA SHEET

### DESCRIPTION:

This end of line pressure switch guarantees the correct operating pressure and the line inversion in dual line installations.

When lubricant pressure in the line reaches the pre-set value, the pressure switch controls, through the electric or electronic equipment, the lighting of a lamp and, if the installation is equipped with an electric controlled line pressure inverter, it drives the line inversion.

The end of line pressure switch comprises of:

- 1 sturdy block with 2 ¼" BSP inlet ports.
- 2 micro-switches.
- 2 pressure adjustment valves.
- 2 pressure gauges
- 2 air bleed valves.

### Types of Pressure Switch:

#### Pressure switch Part No. 1124440;

Fitted at the end of the main line, checks the correct operating pressure and, for installation with hydraulic inverter, controls the inversion from Line 1 to Line 2 and vice-versa.

#### Pressure switch Part No. 1124415;

Same as Part No. 1124440 but mounted in a waterproof box. Protection degree IP 55.

#### Pressure switch Part No. 1124402;

Same as Part No. 1124415 but with explosion proof switch.



#### Pressure switch Part No. 1124447;

Particularly suitable for installations with many lubricant feeders and with many secondary lines. This switch must be fitted at the end of the main line or at the end of a particularly important secondary line. And is electrically connected to another pressure switch mounted on the other end of the line. If one of the two pressure switches is not activated by lubricant pressure, the electric equipment signals an alarm to stop the machine. Only if both pressure switches are acted upon by the correct lubricant pressure, the electric equipment signals the line inversion.

### INSTALLATION/OPERATION:

#### Operation.

When lubricant pressure in the line connected to the pump, reaches the pre-set value on the pressure adjusting valve 1, piston 2, moves up to close the contact of micro-switch 5 which signals, through the lamp of the electric panel, the inversion

### ORDERING INFORMATION:

Ordering is by Part No. and description, please refer to the following table:

Part No.	Electrical connections	Pressure adjustment range	Operating differential pressure*	Micro-switch features
1124402	Terminal board	30 to 330 bar	16 to 20 bar	380V ac. 20A Life expectancy 10x10 <sup>6</sup> cycles Temperature range -20°C to +85°C
1124415	Terminal board	30 to 330 bar	16 to 20 bar	
1124440	Terminal board	30 to 330 bar	16 to 20 bar	
1124447	Terminal board	30 to 100 bar	12 to 14 bar	

\* Operating differential pressure = difference of pressure necessary to obtain the change of micro-switch contacts.

of the line under pressure.

For dual line installations with an electrically controlled inverter, micro-switch 5 also commands the inversion of pressurization of the lines.

**Note: A red alarm lamp signals any malfunction of the end of line pressure switch.**

The next lubrication cycle inversion will occur in the same way as described above. The lubricant pressure in the line now connected to the pump reaches the pre-set value on the other pressure adjusting valve. The pressure in the previously pressurized line is released. This release pressure must be equal to the operating differential pressure in order to guarantee the correct delivery of lubricant from the metering valves.

The operating differential pressure is the difference in pressure necessary to open the contact of micro-switch 5, and depends on distance X between piston 2 and micro-switch 5, which must be 3,3 mm.

**Adjusting valve setting:**

1. Loosen nut A.
2. Turn adjusting nut B until the desired setting value is obtained (check that the pump is operating at the correct pressure by means of the pressure gauge and verify with an

Ohmmeter the change of contacts in the micro-switch).

3. Tighten nut A.
4. Repeat the same operation on the valve that controls the other lubrication line.

**Note:** by dismantling spring 4, maximum adjusting pressure will be 100 bar. In this case we advise the use of pressure gauge **Part No. 20606** (scale from 0 to 250 bar).

**Spare parts:**

Spare parts	
Description	Part No.
1. Adjusting valve assembly.	1124430
1. Adjusting valve assy. for 1124447.	1124446
2. Piston	1124423
3. Spring.	3191222
4. Spring.	3191223
5. Micro-switch.	38041
6. Pressure gauge (0 to 400 bar).	20604
6. Pressure gauge (0 to 250 bar).	20606
7. Air bleed screw.	3230103
8. screws.	12707

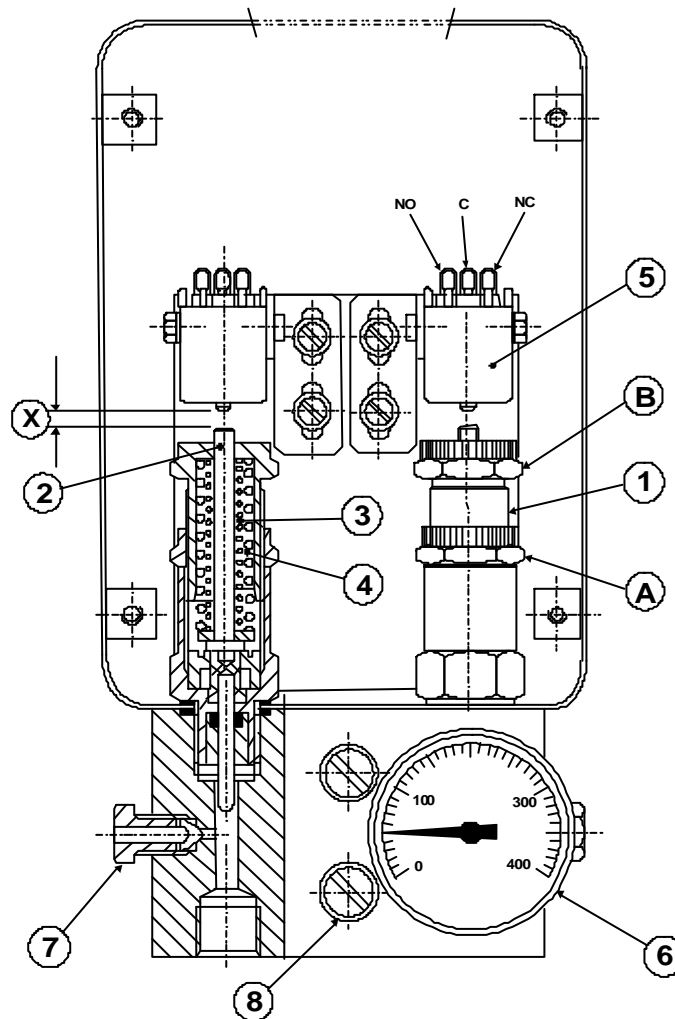

Pressure Switch Part No. 1124440 Electrical connections.

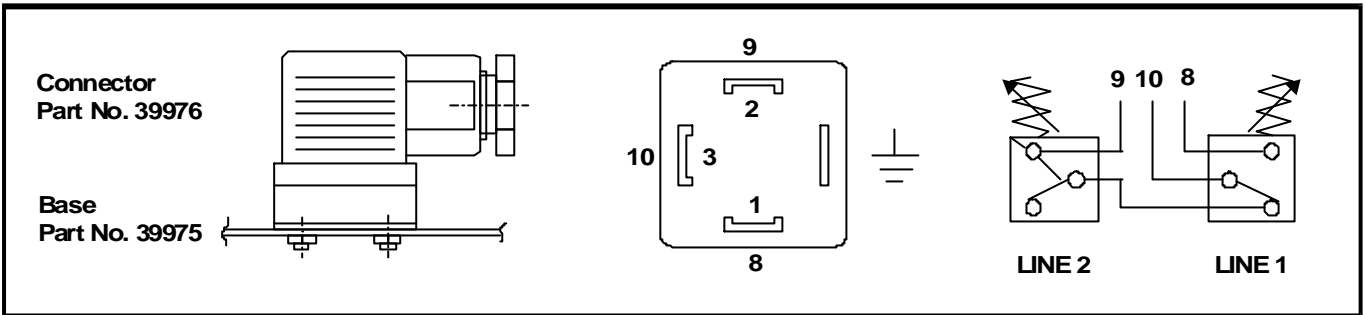

Pressure Switch Part No.'s. 1124402 - 1124415 Electrical connections.

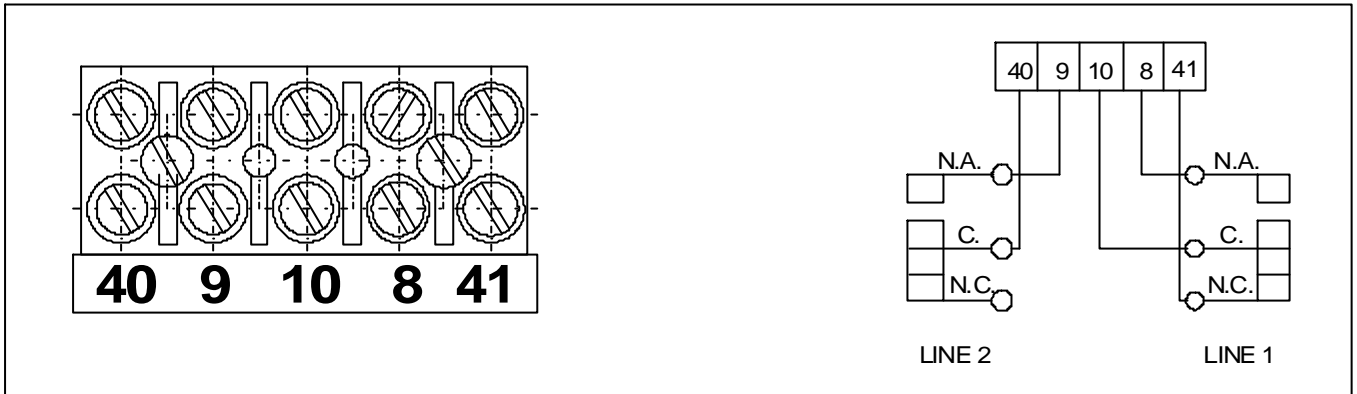

Pressure Switch Part No. 24447 Electrical connections block diagram.

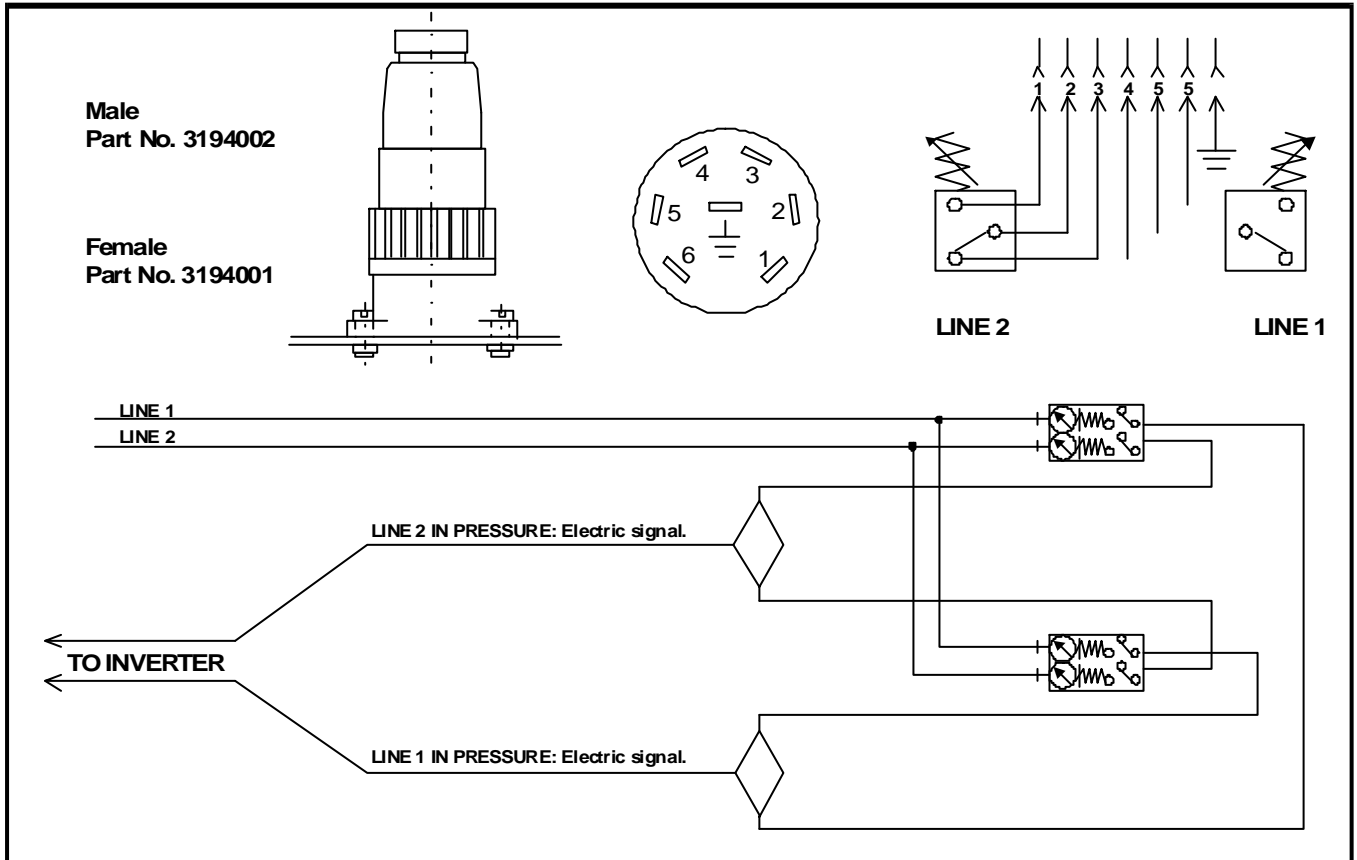



AN ISO 9001 APPROVED COMPANY

**U.K.**  
Dropsa (UK) Ltd.  
Unit 6, Egham Business Village,  
Egham,  
Surrey. TW20 8RB  
Tel: (+44) 01784 - 431177  
Fax: (+44) 01784 - 438598  
E-mail: salesuk@dropsa.com

**U.S.A.**  
Dropsa USA Inc.  
50679 Wing Drive  
Utica,  
Michigan 48315.  
Tel: (+1) 810-566-1540  
Fax: (+1) 810-566-1541  
E-mail: salesusa@dropsa.com

**AUSTRALIA**  
Dropsa Australia Pty.  
No. 7 Warringah Road  
Dee Why  
NSW 2099  
Tel: (+61) 2 9905 0410  
Fax: (+61) 2 99394142  
E-mail: sales@dropsa.com

**GERMANY**  
Dropsa GmbH.  
Volmerswerther Strasse 80  
40221 Dusseldorf 1,  
Deutschland  
Tel: (+49) 0211-394-011  
Fax: (+49) 0211-394-013  
E-mail: sales@dropsa.de

**ITALY**  
Dropsa Spa  
Via B. Croce, 1 - 20090  
Vimodrone (MI)  
Tel: (+39) 02 - 250.79.1  
Fax: (+39) 02 - 250.79.767  
E-mail: sales@dropsa.it (Export)  
E-mail: vendite@dropsa.it (National)

© Copyright Dropsa - all rights reserved. Reproduction of any part of this document is strictly forbidden without prior consent from Dropsa. Dropsa reserves the right to modify specifications without prior notice .